

## Buddy Bench

**The Buddy Bench Program is a coordination of Scherrer Construction and Palmer Hamilton. This is an initiative to support schools in their anti-bullying efforts.**

### FEATURES

- Buddy Benches increase anti-bullying awareness, involvement, and positive culture throughout the school and community.
- Both indoor and outdoor materials are available, and all are customizable from a selection of designs with school colors, name, and mascot, if desired.

### FRAMES

- Frames are MIG welded 2" x 2" steel tubing with 11-gauge wall (.12").
- The bench and back are attached with a 5' x 4-1/2" 10-gauge steel mounting plate welded to the frame.
- Pieces are mounted to the frame with #10 x 3/4" screws.
- All metal parts are thoroughly cleaned to resist corrosion and provide maximum paint adhesion, finished with high-grade electrostatically applied baked-on epoxy powdercoat for superior resistance to abrasion, marring and scratching. The metal finish is a baked-on, lightly textured polyester powder coating.
- Frames are available in our standard colors,



Black (BLK)



Chameleon (CHA)



Metallic Silver (MS)



- For additional frame colors see our website. We offer 10 vibrant and rich powder coated colors for indoor and outdoor use. Premium colors are subject to an upcharge. Call for pricing.

### LAMINATE BACKS AND SEATS

- Back and seat construction is 1-1/8" M3 industrial grade particle board. We use .030" HPL (decorative laminate) on the front/top side and a .028" balanced black backer on the back/bottom for stability and moisture resistance. Corners are rounded for safety.
- Benches and backs are custom logo laminate. Choose between two graphic orientations to add school name and colors or school name, colors and logo. See Palmer Hamilton Customized Graphics and Logos Form for the Buddy Bench available through our Customer Service Representatives or at [www.palmerhamilton.com](http://www.palmerhamilton.com)

### LAMINATES

**Group 1:** Choose your colors from Wilsonart® or Formica® laminates. See their websites for selections. For Wilsonart®, our standards are most colors in Type 335 laminate and finish type ending in -38 or -60. Exceptions apply, including colors that begin with "Y" or end with K-38 or K-60. Standard Formica®

**Empower young people with the tools necessary to make socially responsible decisions and create sustainable change.**



Laminates are Grade 12 or Grade 20 ending in finish type -58 and -43.

**Group 2:** Standard Pionite®, Nevamar®, and non-standard Wilsonart® laminates Type 335 and 107 Recycled Content, and finish types not ending in -38 or -60.

**Group 3:** Wilsonart® Specialty Types 136 / 137 Chalkboard Laminates, Arborite®, and premium Formica®, Pionite®, and Nevamar®.

**Group 4:** Non-Standard Premium Wilsonart® Laminate Types 362 (VDL, Y-Type), 156/336 (Markerboard), 376-HD / 366 Wilsonart® HD, and 515 Compact Laminate.

**All premium laminates** are subject to an upcharge.

### EDGES

- Our standard edge is EdgeGuard™, a sprayed-on polyurea eased edge treatment that provides superior resistance to moisture, eliminates unsanitary traps, and is extremely tamper resistant. Edges stay sealed, preventing peeling and chipping.



EdgeGuard™

Durable for many years of use.

- Standard color is black. We offer six nonstandard colors. Upcharges apply to orders of 20 units or less. See our website for options

### FIBERGLASS BACKS AND SEATS

- Fiberglass is a combination of resin and glass fibers, creating a fiber reinforced plastic. Fiberglass is designed to endure extreme weather, and is heat and chemical resistant.
- Fiberglass can be used for both outdoor and indoor units.
- Fiberglass seats and backs are stain and UV resistant for long lasting color and durability.

### MOUNTING OPTIONS

#### Glides

- Movable units have 1-3/8" round nylon base glides with 3/8-16 threaded stem.
- Body of glide is nickel plated steel with white nylon glide. Our glides use a 3/8" threaded rod.

#### Anchors

- Anchor plates are 16-gauge stainless steel plate, powder-coated with our standard outdoor finish with 3/8" zinc plated bolt.
- Fasteners for anchors are not included.

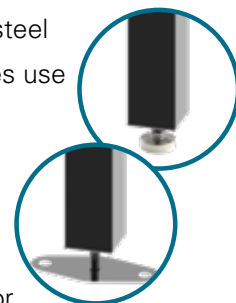

With a selection of color and logo options, schools can personalize seat and back designs to fit their desired atmosphere.



## DIMENSIONS

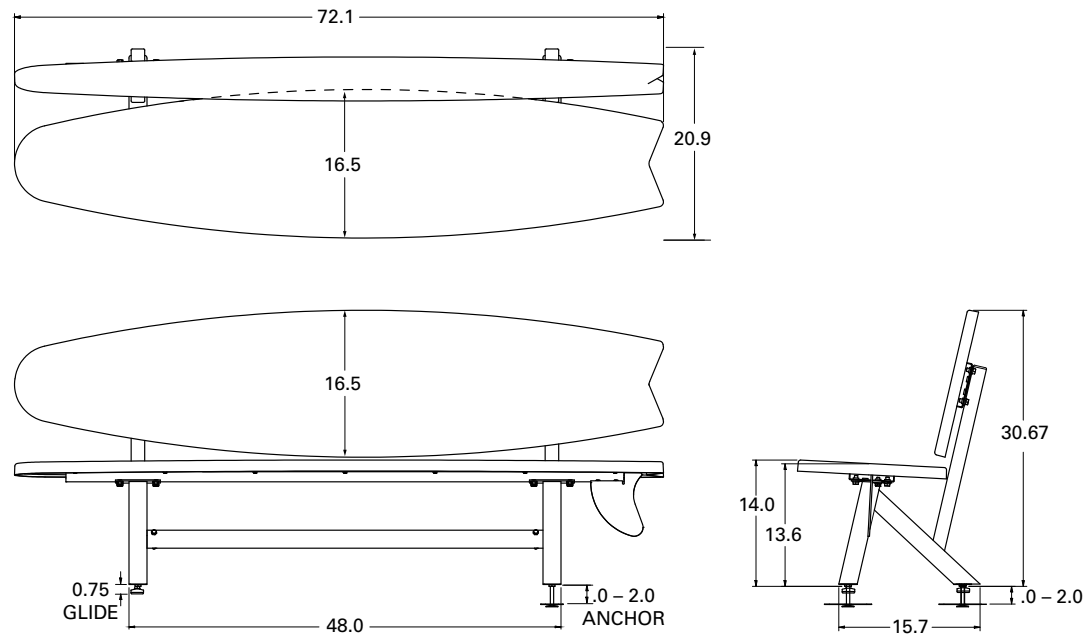

## WARRANTY

- See Palmer Hamilton Warranty at [palmerhamilton.com/resources/warranty](http://palmerhamilton.com/resources/warranty)

## SHIPPING

- Benches ship fully assembled.