

SPEC SHEET: NG6

6' NORTHGATE BENCH *PORTABLE*

Wt. 260 lbs

photo



top view

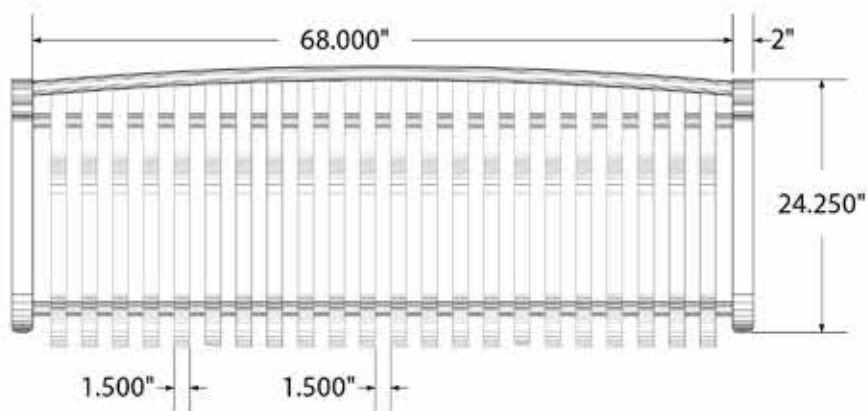

front view

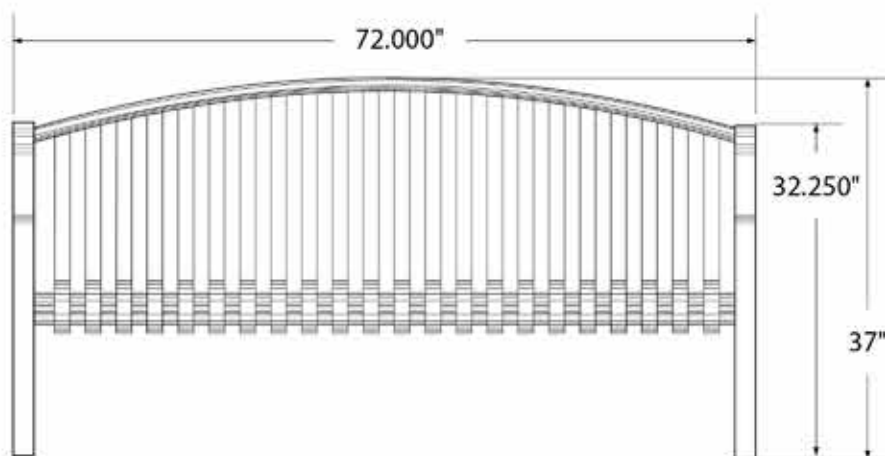

side view

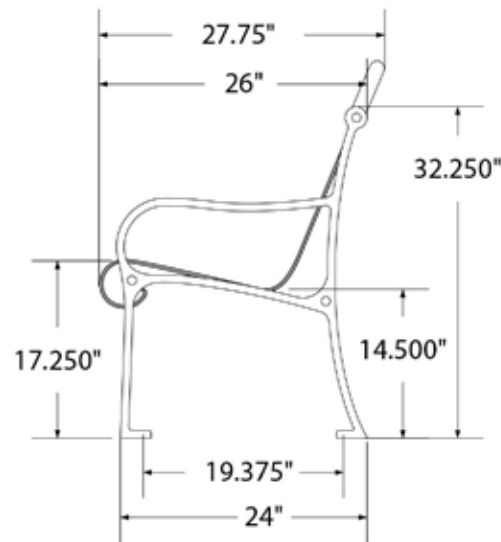

product finish

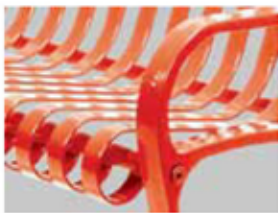

The functional surfaces of our furniture are covered in a copolymer-based thermoplastic powder coating. Thermoplastic is environmentally safe, the coating will never fade, crack, peel, warp, or discolor for the life of the product. Thermoplastic is applied at a thickness of 25-30 mils.

mounting types

P = Portable : no mount

SM = Surface Mount:
concrete anchors
through discs welded
to legs

IG= In-Ground:
J-rods set in concrete
through discs welded
to legs

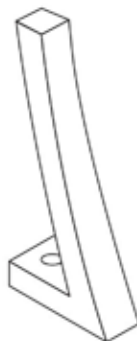

portable

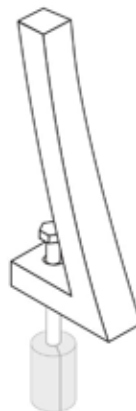

surface mount

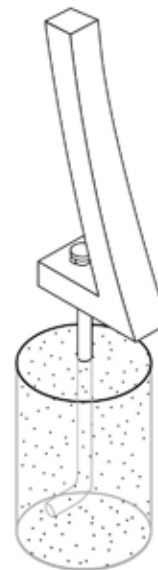

in-ground

All design specifics subject to change. For all products Palmer Hamilton reserves the right to make adjustments due to changing market conditions, product discontinuation, legislative requirements or other circumstances.

SPEC SHEET: OG6

6' OGLETHORPE BENCH *PORTABLE*

Wt. 260 lbs

photo



top view

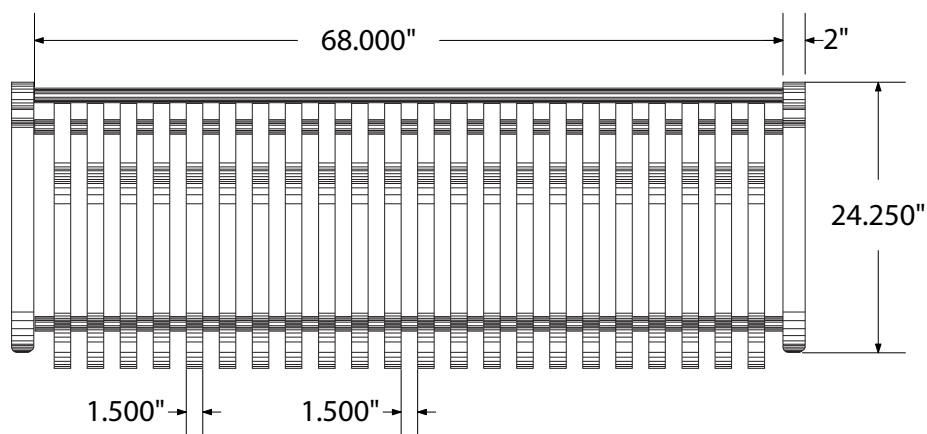

front view

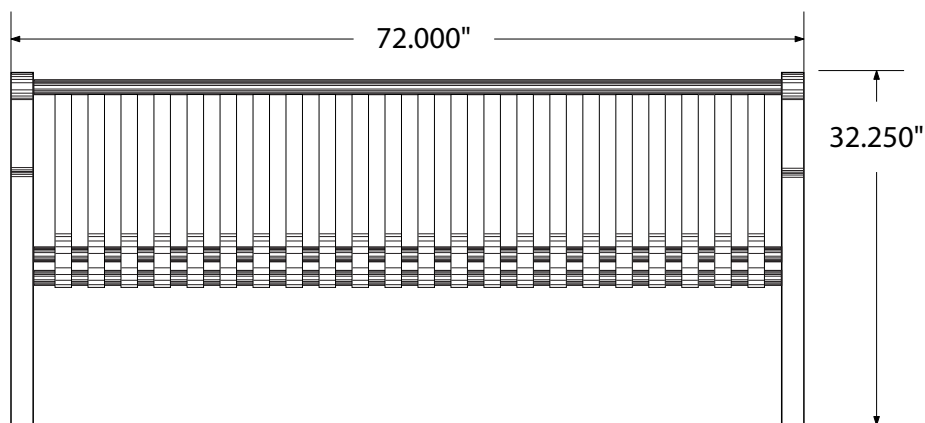

side view

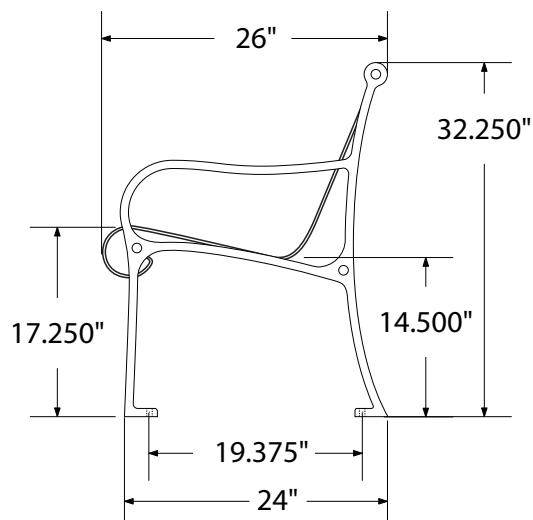

product finish

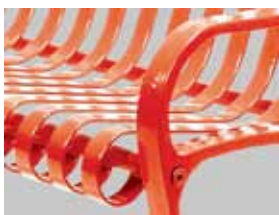

The functional surfaces of our furniture are covered in a copolymer-based thermoplastic powder coating. Thermoplastic is environmentally safe, the coating will never fade, crack, peel, warp, or discolor for the life of the product. Thermoplastic is applied at a thickness of 25-30 mils.

mounting types

P = Portable : no mount

SM = Surface Mount:
concrete anchors
through discs welded
to legs

IG= In-Ground:
J-rods set in concrete
through discs welded
to legs

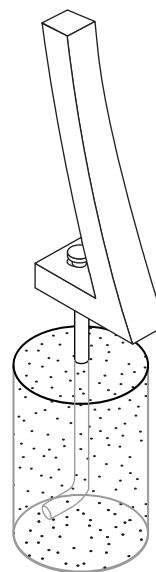
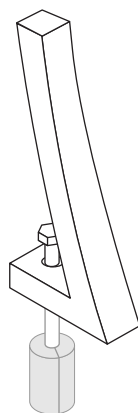
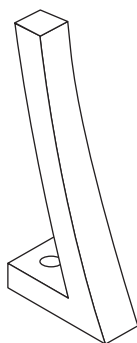

portable

surface mount

in-ground

All design specifics subject to change. For all products Palmer Hamilton reserves the right to make adjustments due to changing market conditions, product discontinuation, legislative requirements or other circumstances.

SPEC SHEET: OF-HP6WB

6' HIGH POINT BENCH WITH BACK *portable/surface-mount*

Wt. 245 lbs

photo

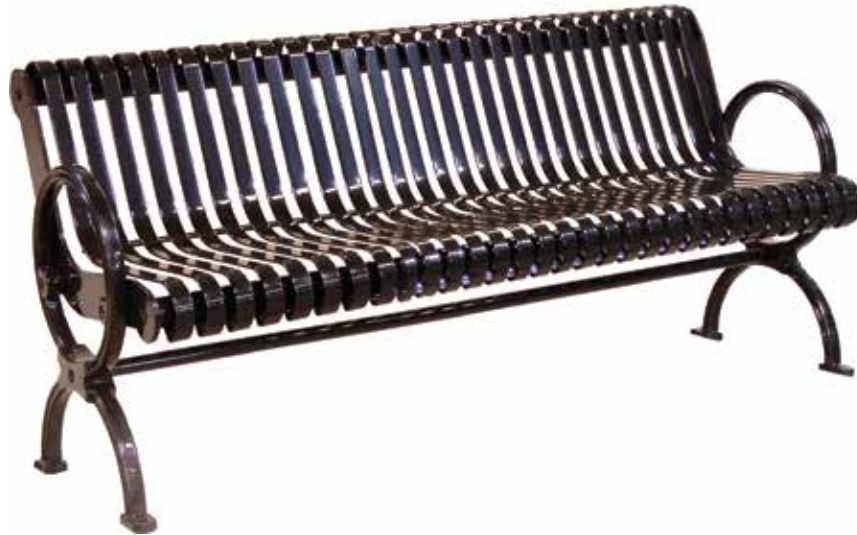

top view

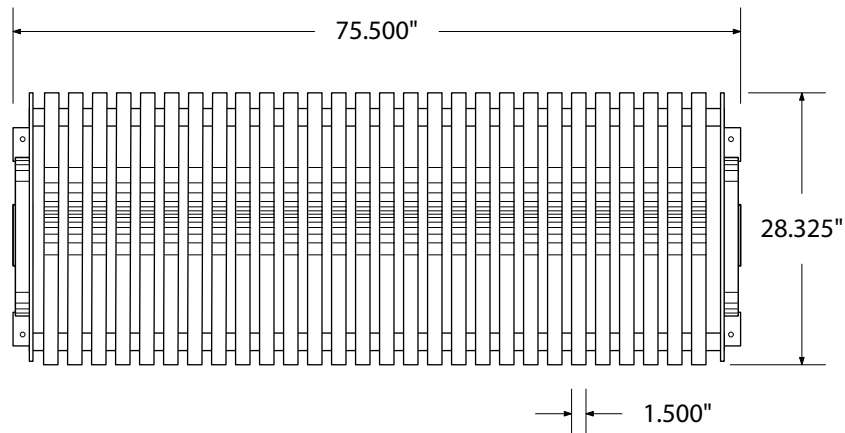

front view

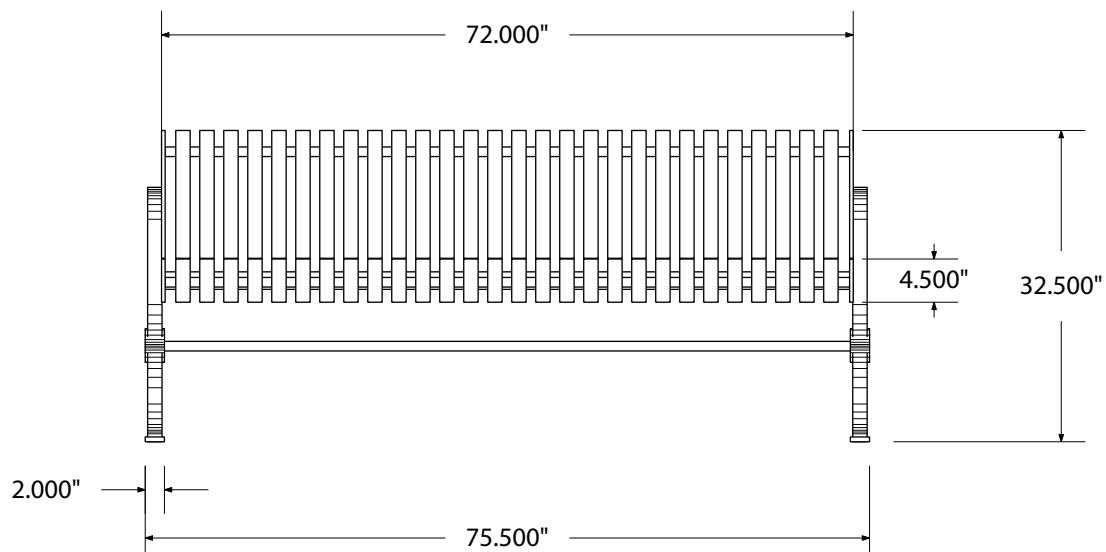

side view

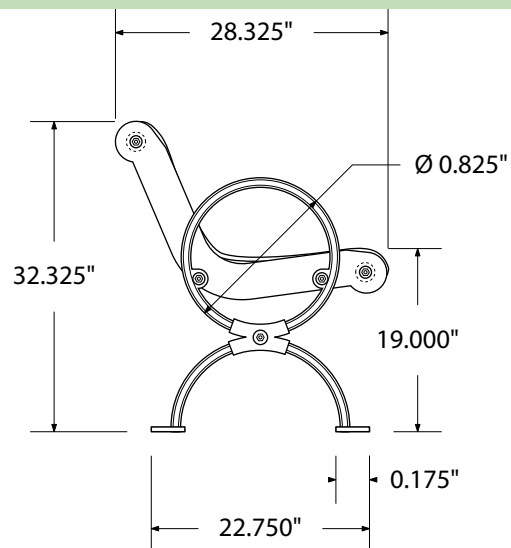

product details



Coated Surfaces:

- Thermoplastic coated
- Copolymer-based, environmentally safe
- Does not fade, crack, peel warp
- Applied at a thickness of 25-30 mils.
- 5 Year warranty on coating

Construction:

- 1½" Steel straps welded to tube braces
- 2" Schedule 40 tube braces
- 1" Schedule 40 pipe bottom brace
- Heavyweight cast-iron zinc-rich primed leg structure
- Nuts, washers and bolts - galvanized steel

mounting types

P = Portable : no mount

SM = Surface Mount:
concrete anchors
through holes in feet

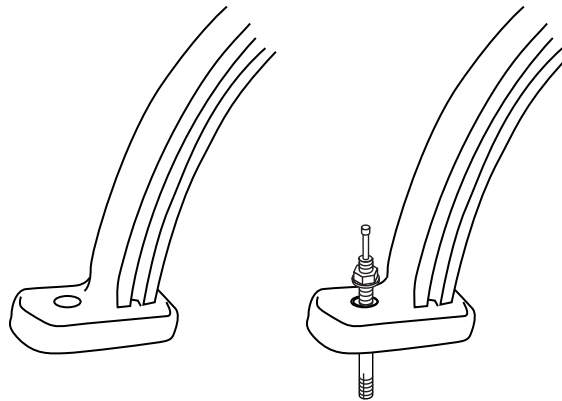

PORTABLE

SURFACE MOUNT

SPEC SHEET: ULNB6-PERF

6' U-LEG PERFORATED BENCH WITHOUT BACK *PORTABLE*

Wt. 130bs

photo



top view

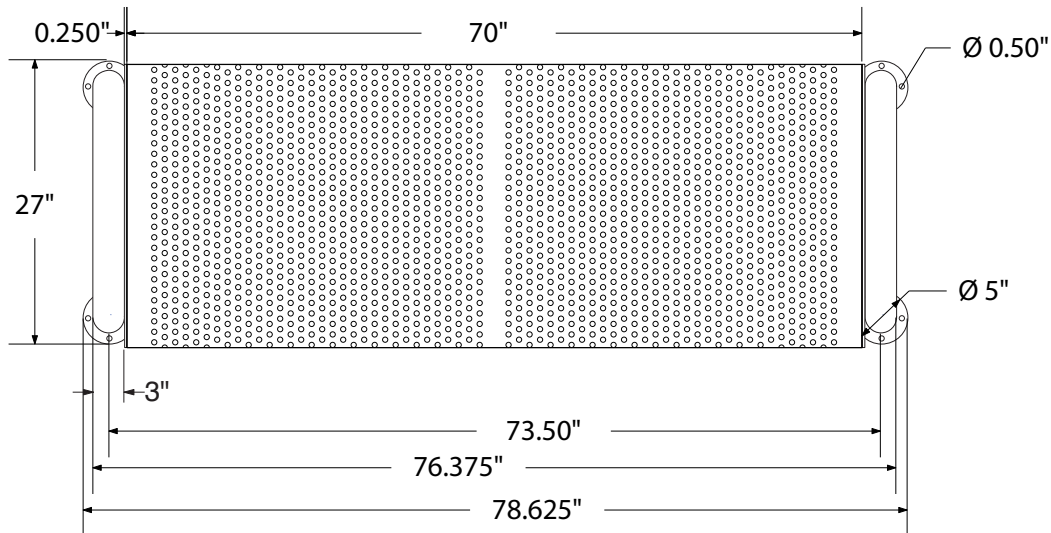

front

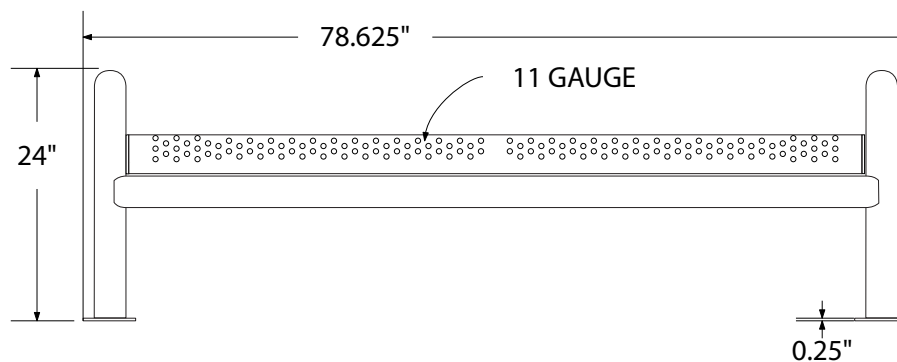

side view

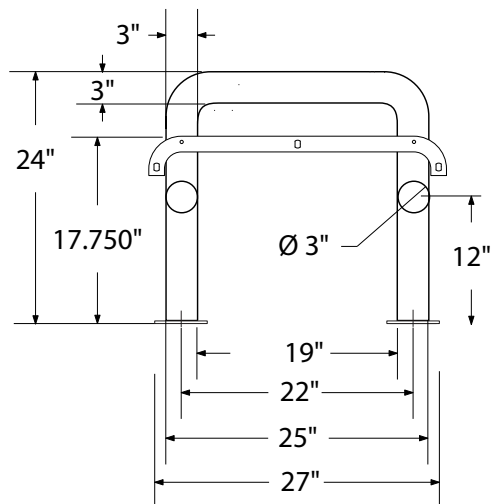

product finish



The functional surfaces of our furniture are covered in a copolymer-based thermoplastic powder coating. Thermoplastic is environmentally safe, the coating will never fade, crack, peel, warp, or discolor for the life of the product. Thermoplastic is applied at a thickness of 25-30 mils.

mounting types

P = Portable : no mount

SM = Surface Mount:
concrete anchors
through holes on legs

IG= In-Ground:
J-rods set in concrete
through welded
to legs

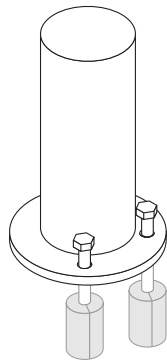

PORTABLE

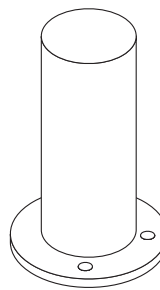

SURFACE MOUNT

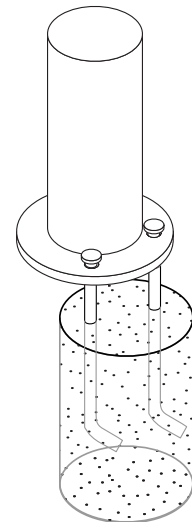

IN-GROUND

SPEC SHEET: ULRBNB6

6' U-LEG RIBBON BENCH WITHOUT BACK *PORTABLE*

Wt. 125 lbs

photo



top view

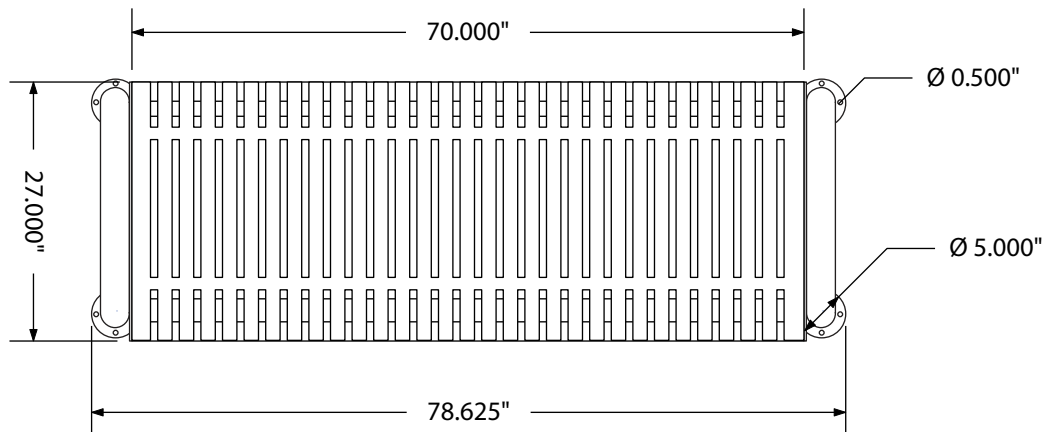

front view

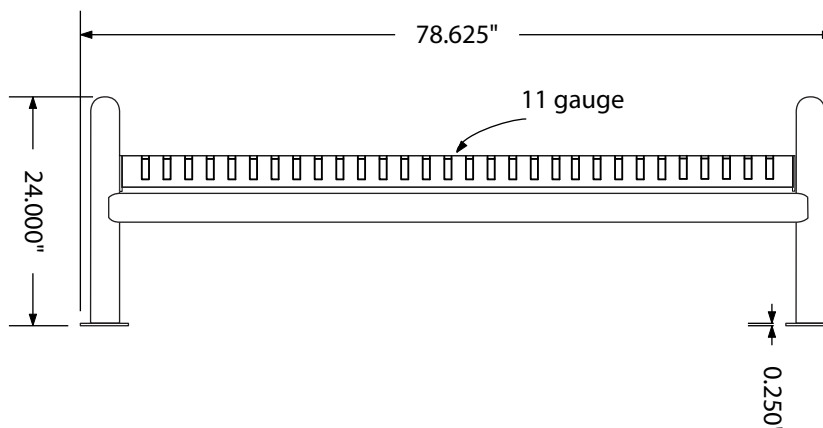

side view

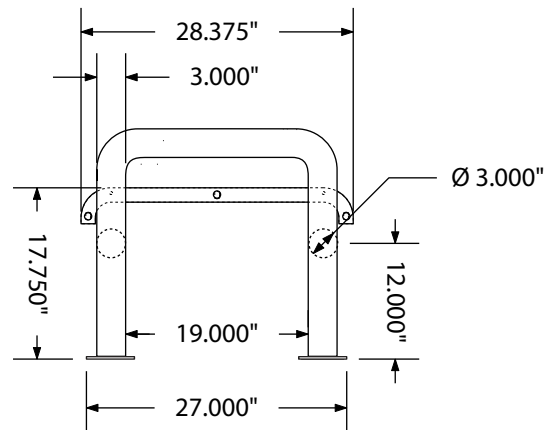

product finish



Coated Surfaces:

- Thermoplastic coated
- Copolymer-based, environmentally safe
- Does not fade, crack, peel warp
- Applied at a thickness of 25-30 mils.
- 5 Year warranty on coating

Construction:

- 3" Schedule 40 tubular steel frame
- 11 Gauge steel seat, leg flanges, and endcaps
- Nuts, washers and bolts - galvanized steel

mounting types

P = Portable : no mount

SM = Surface Mount:
concrete anchors
through holes on legs

IG= In-Ground:
J-rods set in concrete
through welded
to legs

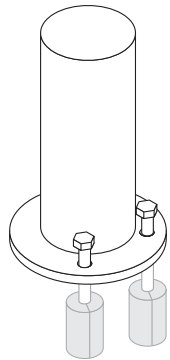

PORTABLE

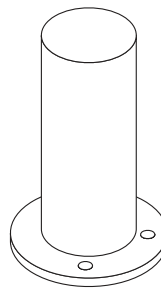

SURFACE MOUNT

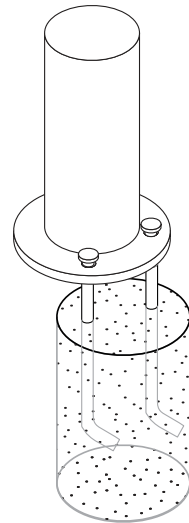

IN-GROUND

SPEC SHEET: RFNB6-PERF

6' PERFORATED BENCH WITHOUT BACK *PORTABLE*

Wt. 175bs

photo

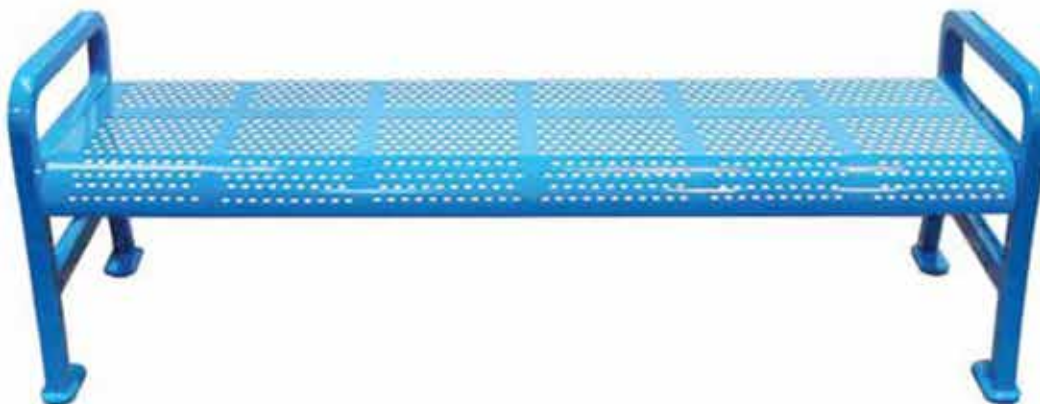

top view

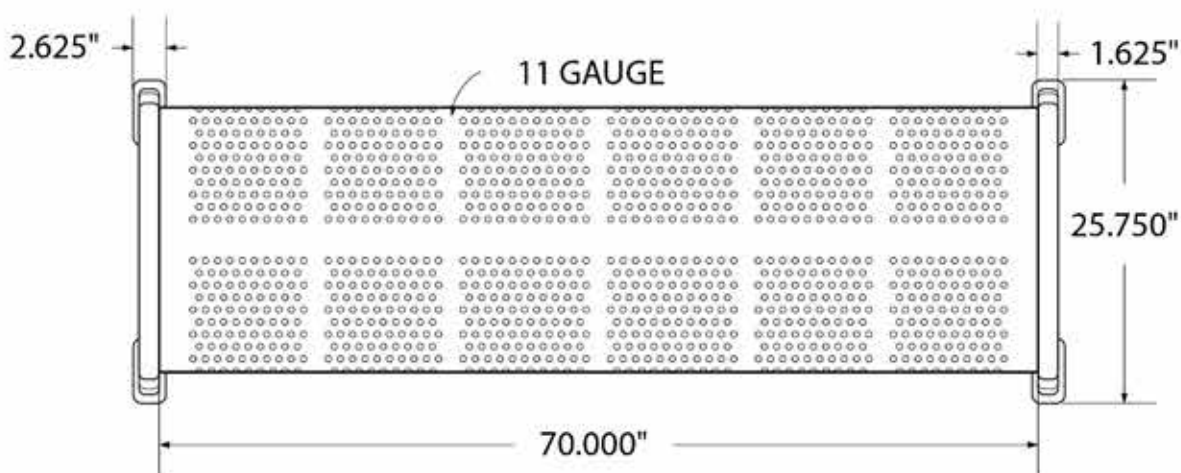

front

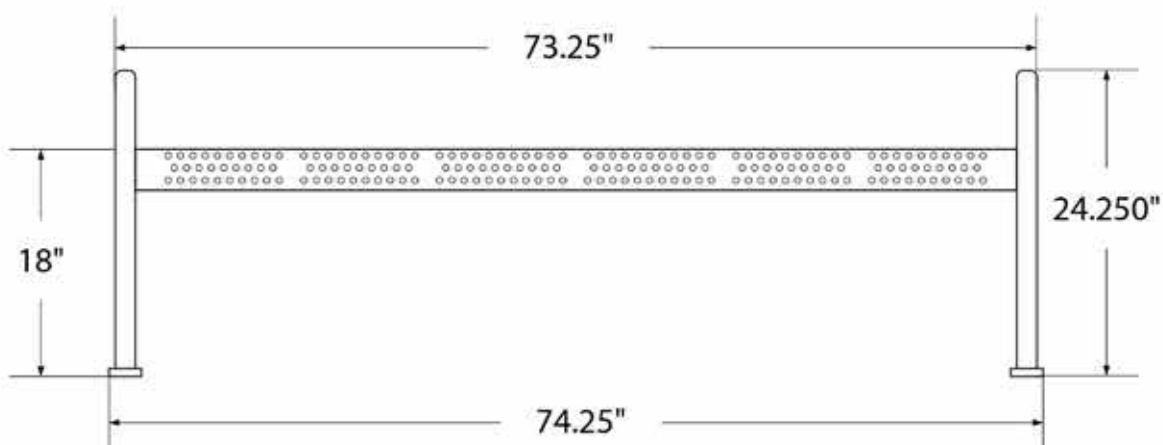

side view

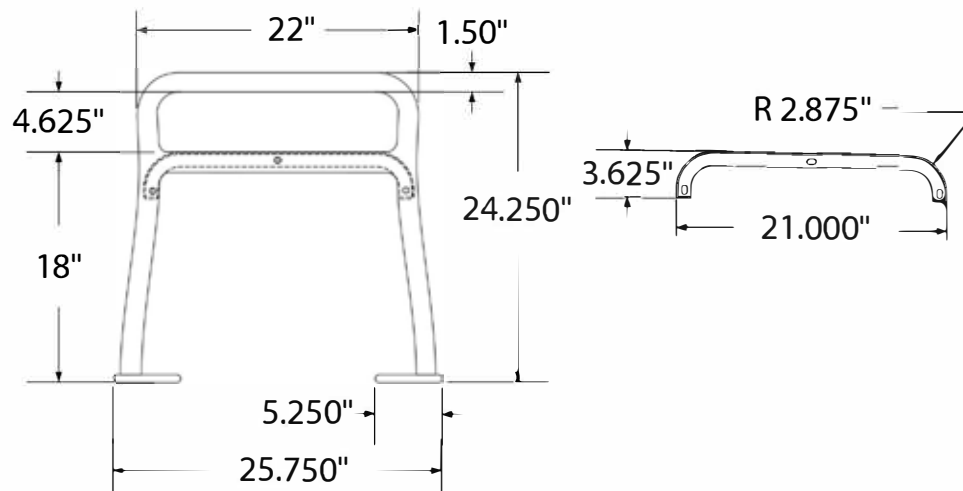

product finish



The functional surfaces of our furniture are covered in a copolymer-based thermoplastic powder coating. Thermoplastic is environmentally safe, the coating will never fade, crack, peel, warp, or discolor for the life of the product. Thermoplastic is applied at a thickness of 25-30 mils.

mounting types

P = Portable : no mount

SM = Surface Mount:
concrete anchors
through holes on legs

IG= In-Ground:
J-rods set in concrete
through welded
to legs

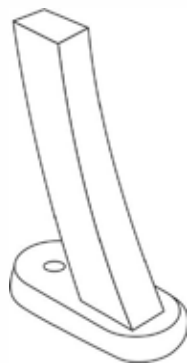

PORTABLE

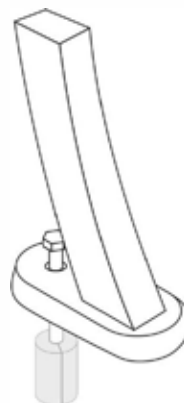

SURFACE MOUNT

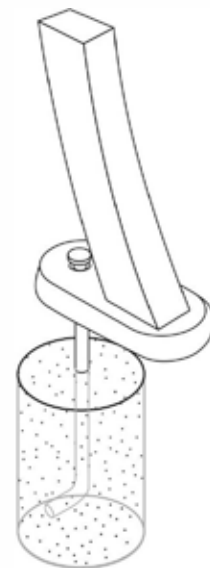

IN-GROUND

SPEC SHEET: B6WBP

6' STANDARD EXPANDED BENCH W BACK *PORTABLE MOUNT*

Wt. 150 lbs

photo



top view

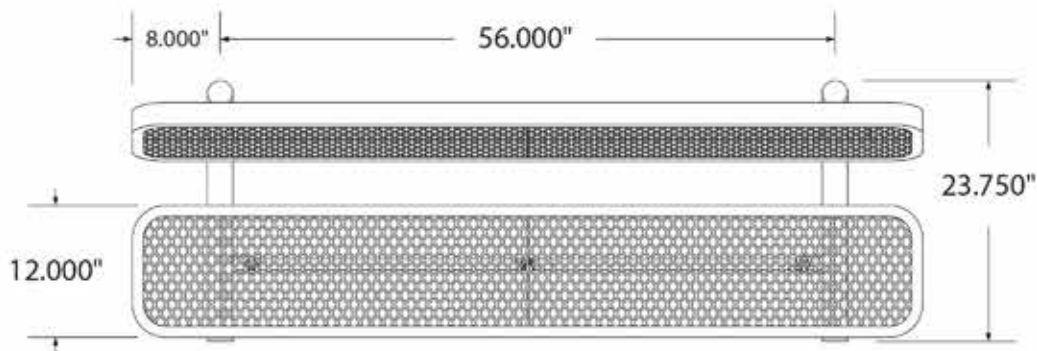

front

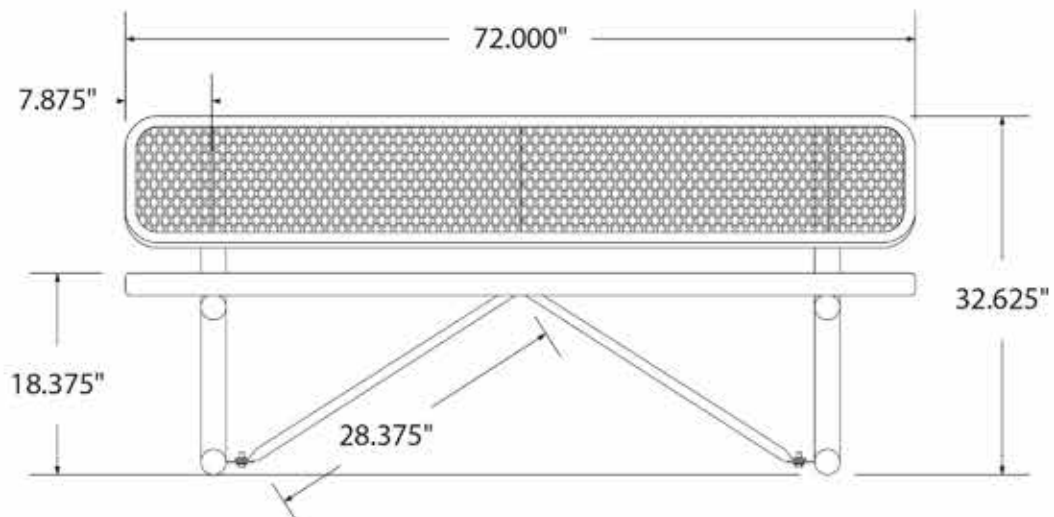

side view

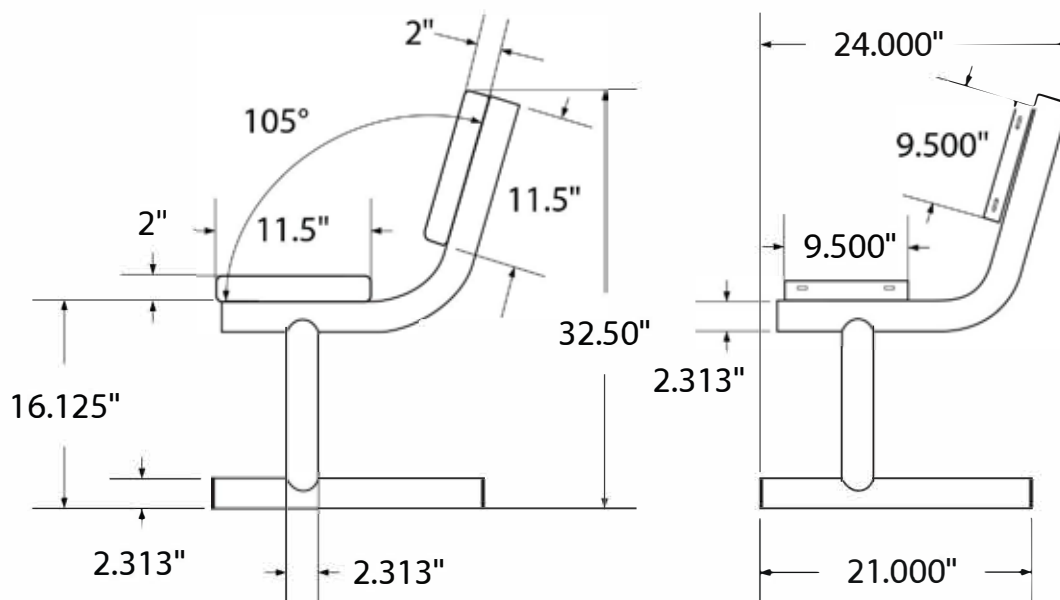

product finish



The functional surfaces of our furniture are covered in a copolymer-based thermoplastic powder coating. Thermoplastic is environmentally safe, the coating will never fade, crack, peel, warp, or discolor for the life of the product. Thermoplastic is applied at a thickness of 25-30 mils.



Tubular legs and understructure parts are made from galvanized steel and are finished with black polyester powder coating.

mounting types

P = Portable : no mount

SM = Surface Mount:
concrete anchors
through discs welded
to legs

IG= In-Ground:
J-rods set in concrete
through discs welded
to legs

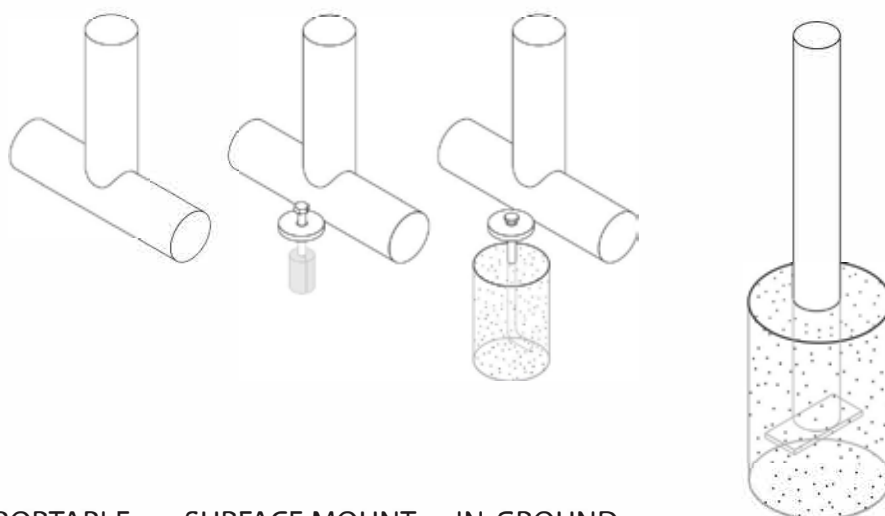

PORTABLE SURFACE MOUNT IN-GROUND

IN-GROUND

All design specifics subject to change. For all products Palmer Hamilton reserves the right to make adjustments due to changing market conditions, product discontinuation, legislative requirements or other circumstances.

SPEC SHEET: B8WBP

8' STANDARD EXPANDED BENCH W BACK PORTABLE MOUNT **Wt. 180 lbs**

photo



top view

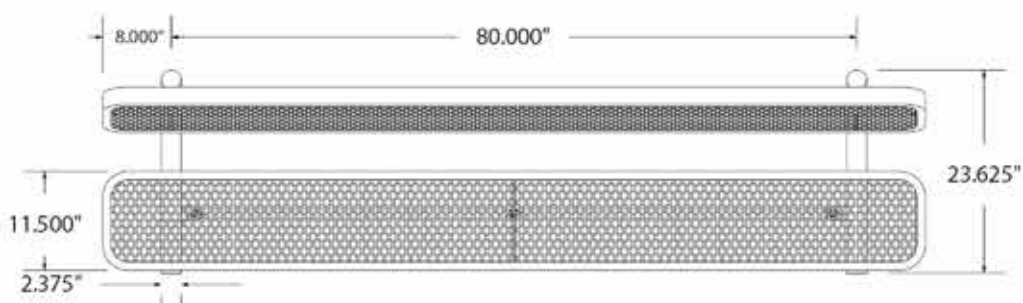

front

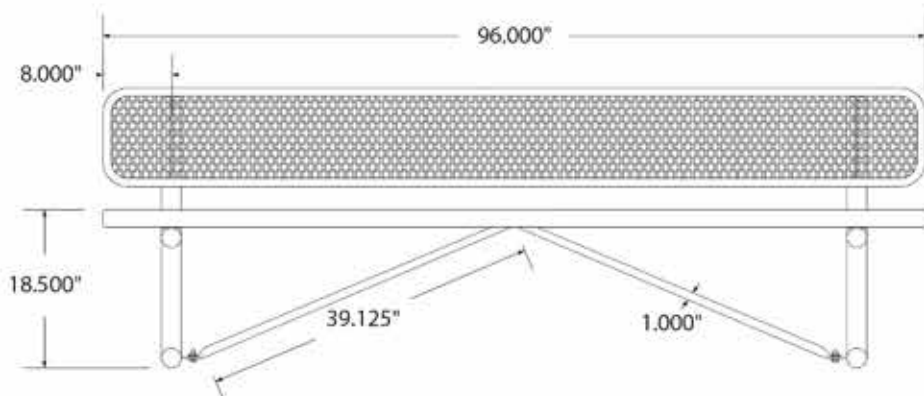

side view

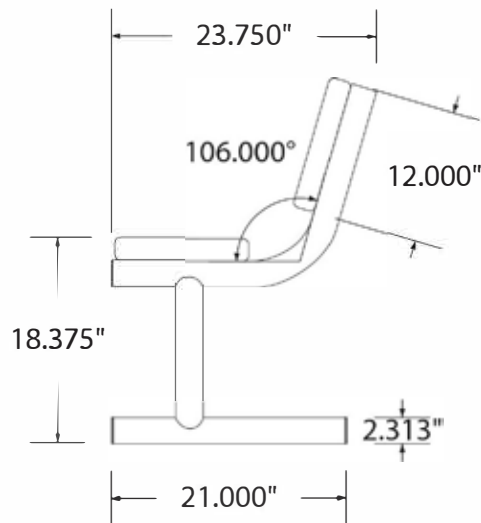

product finish



The functional surfaces of our furniture are covered in a copolymer-based thermoplastic powder coating. Thermoplastic is environmentally safe, the coating will never fade, crack, peel, warp, or discolor for the life of the product. Thermoplastic is applied at a thickness of 25-30 mils.



Tubular legs and understructure parts are made from galvanized steel and are finished with black polyester powder coating.

mounting types

P = Portable : no mount

SM = Surface Mount:
concrete anchors
through discs welded
to legs

IG= In-Ground:
J-rods set in concrete
through discs welded
to legs

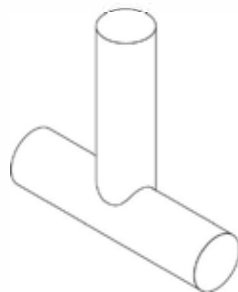

PORTABLE

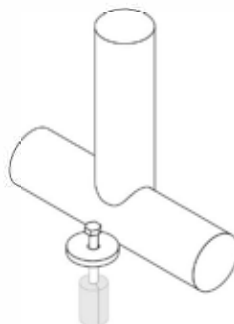

SURFACE MOUNT

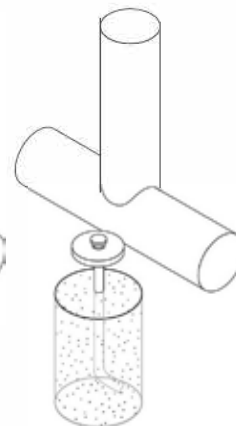

IN-GROUND

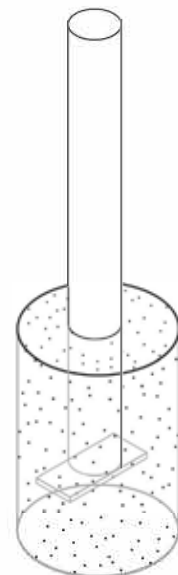

IN-GROUND

All design specifics subject to change. For all products Palmer Hamilton reserves the right to make adjustments due to changing market conditions, product discontinuation, legislative requirements or other circumstances.

SPEC SHEET: B6WBP-PERF

6' STANDARD PERFORATED BENCH W/BACK PORTABLE MOUNT Wt. 160 lbs

photo



top view

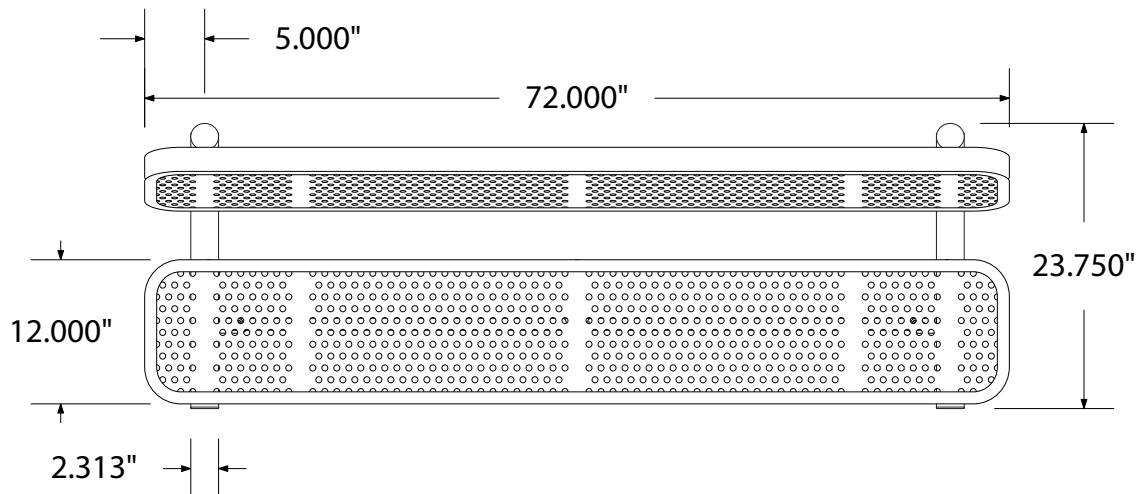

front

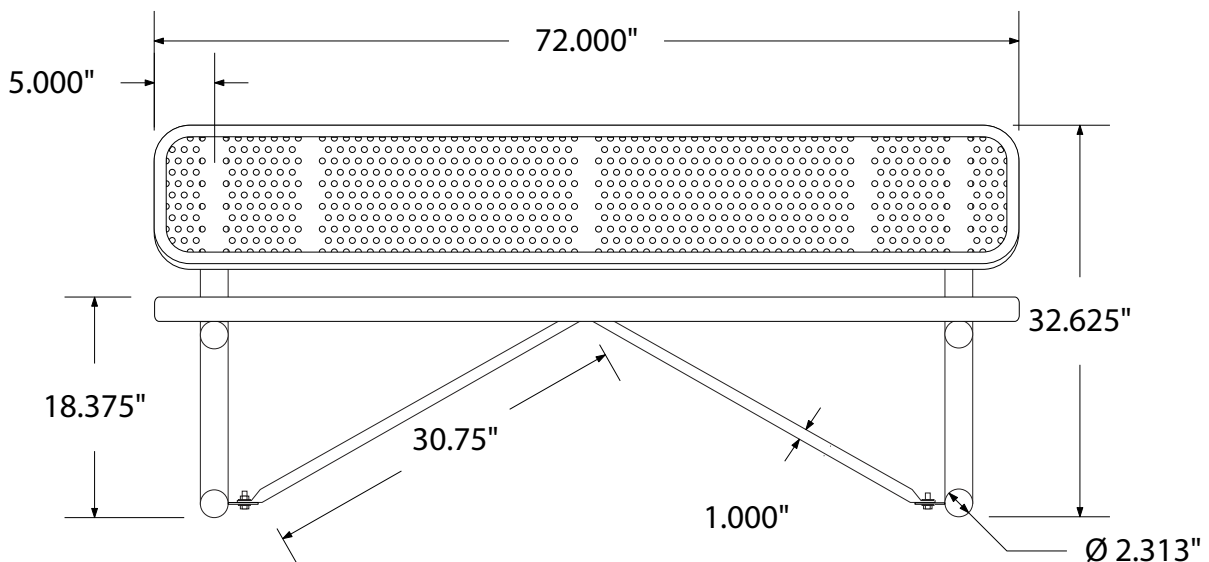

side view

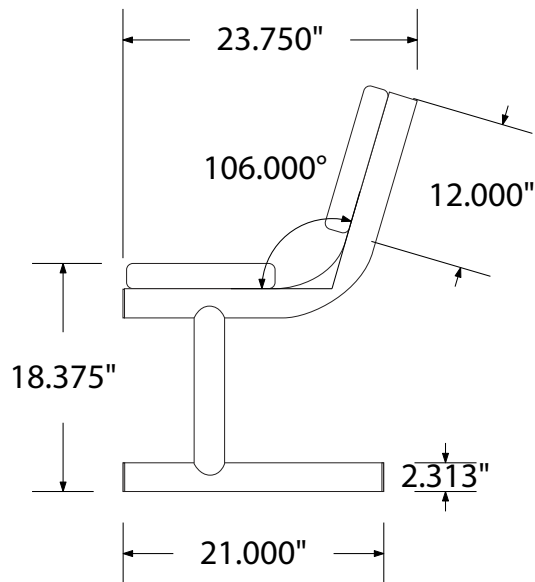

product finish



The functional surfaces of our furniture are covered in a copolymer-based thermoplastic powder coating. Thermoplastic is environmentally safe, the coating will never fade, crack, peel, warp, or discolor for the life of the product. Thermoplastic is applied at a thickness of 25-30 mils.



Tubular legs and understructure parts are made from galvanized steel and are finished with black polyester powder coating.

mounting types

P = Portable : no mount

SM = Surface Mount:
concrete anchors
through discs welded
to legs

IG= In-Ground:
J-rods set in concrete
through discs welded
to legs

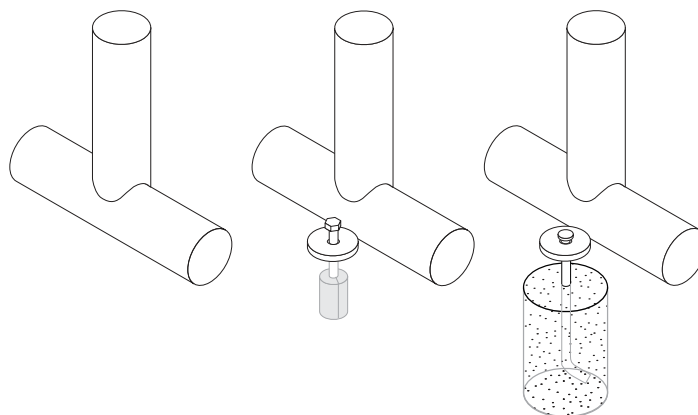

PORTABLE

SURFACE MOUNT

IN-GROUND

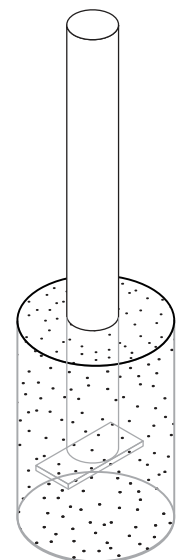

All design specifics subject to change. For all products Palmer Hamilton reserves the right to make adjustments due to changing market conditions, product discontinuation, legislative requirements or other circumstances.

SPEC SHEET: B8WBP-PERF

8' STANDARD PERFORATED BENCH W BACK *PORTABLE MOUNT* **Wt. 190 lbs**

photo



top view

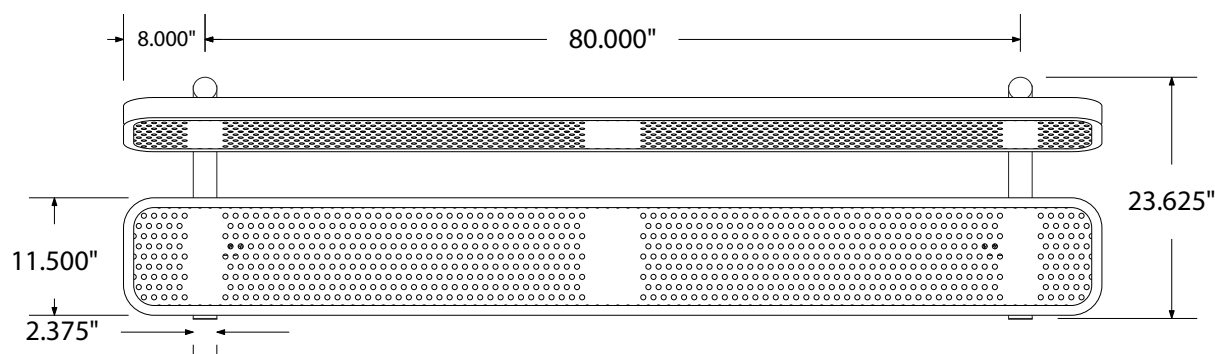

front

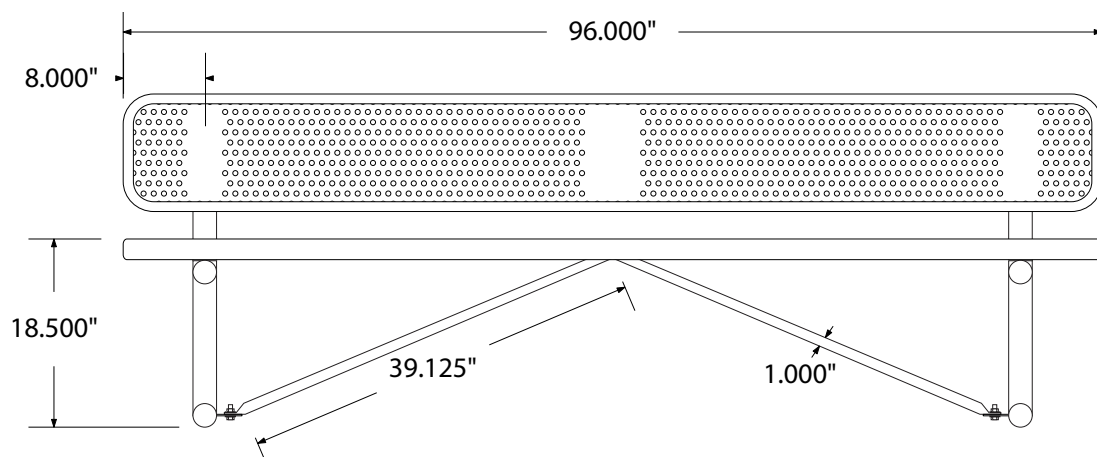

side view

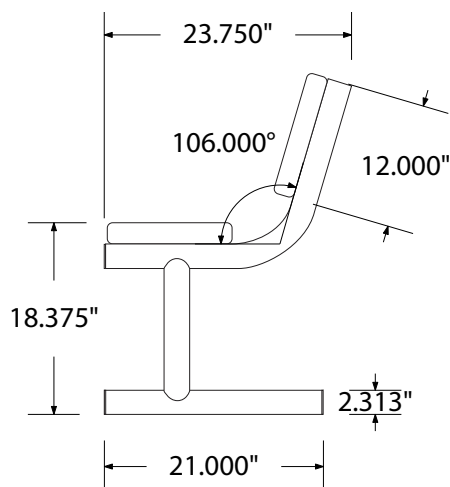

product finish



The functional surfaces of our furniture are covered in a copolymer-based thermoplastic powder coating. Thermoplastic is environmentally safe, the coating will never fade, crack, peel, warp, or discolor for the life of the product. Thermoplastic is applied at a thickness of 25-30 mils.



Tubular legs and understructure parts are made from galvanized steel and are finished with black polyester powder coating.

mounting types

P = Portable : no mount

SM = Surface Mount:
concrete anchors
through discs welded
to legs

IG= In-Ground:
J-rods set in concrete
through discs welded
to legs

IG=In-Ground
extra log legs

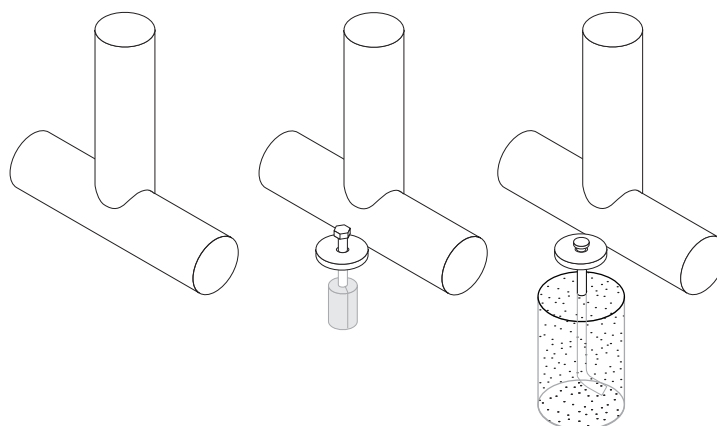

PORTABLE

SURFACE MOUNT

IN-GROUND

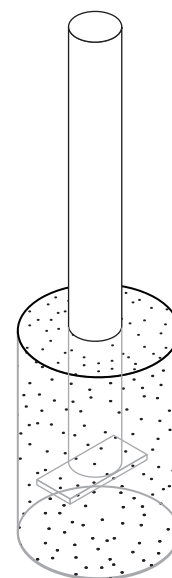

IN-GROUND