

SPEC SHEET: 32EXP

32 GALLON EXPANDED RECEPTACLE *portable*

Wt. 70 lbs

photo



bottom / top view

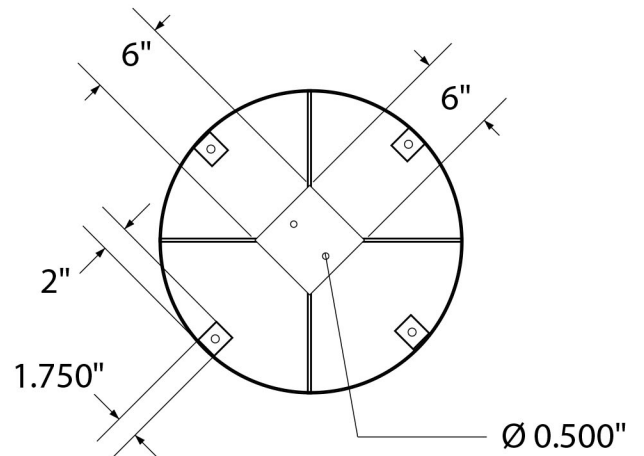
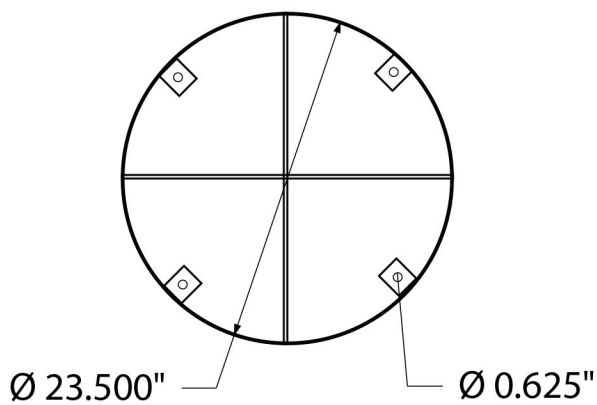

receptacle
2 types of
bottoms

front view

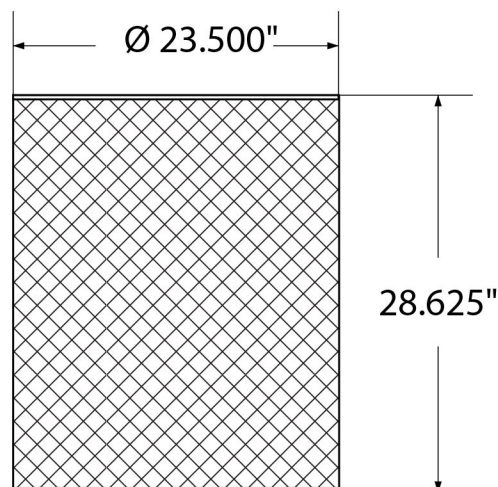

product details

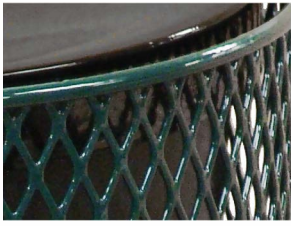

Coated Surfaces:

- Thermoplastic coated
- Copolymer-based, environmentally safe
- Does not fade, crack, peel or warp
- Applied at a thickness of 25-30 mils.
- 5 Year warranty on coating

Construction:

- 9 Gauge expanded metal steel
- $\frac{3}{8}$ " Solid steel rod rim

mounting types

P = Portable : no mount

SM 1= Surface Mount1:
concrete anchors
through taps welded
to receptacle bottom
mount

SM 2= Surface Mount2:
bolts through bottom plate into B100
surface mount. B100 Mounted to
ground with anchors embedded
in concrete.

IG= In-Ground:
anchor bolts attach
to B200 receptacle
mount

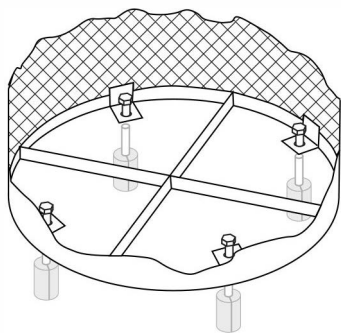

SURFACE MOUNT (1)

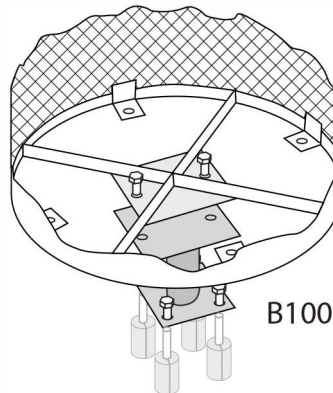

SURFACE MOUNT (2)

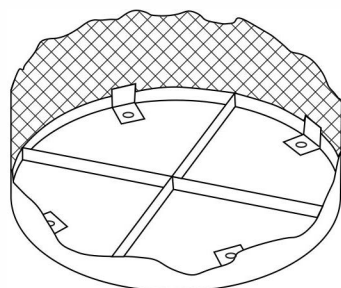

PORTABLE

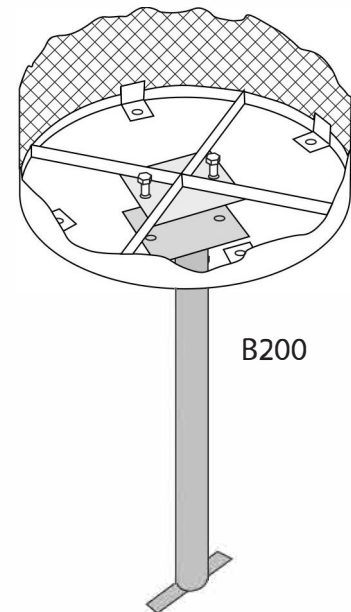

IN-GROUND

SPEC SHEET: 32SML

CONCAVE SPUN METAL LID

Wt. 20 lbs

photo

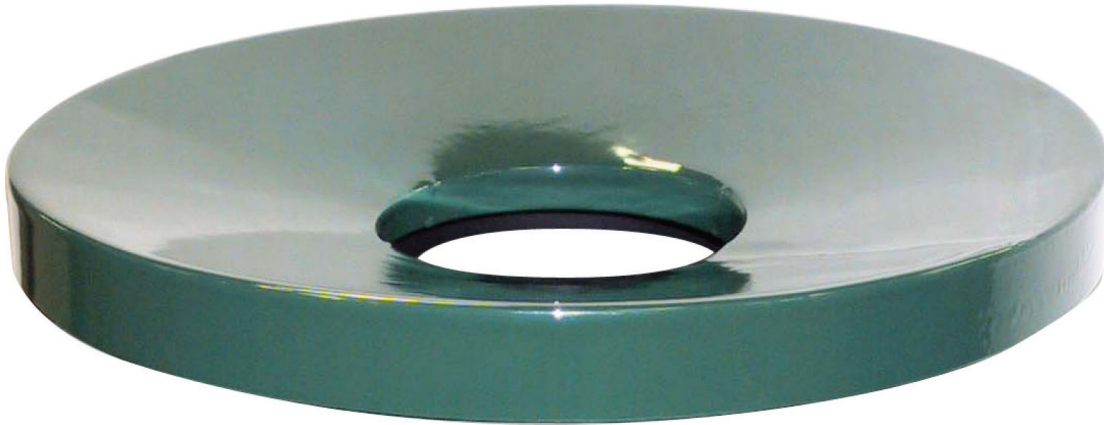

bottom / top view

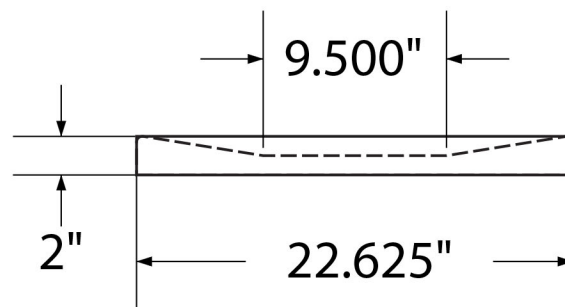

front view

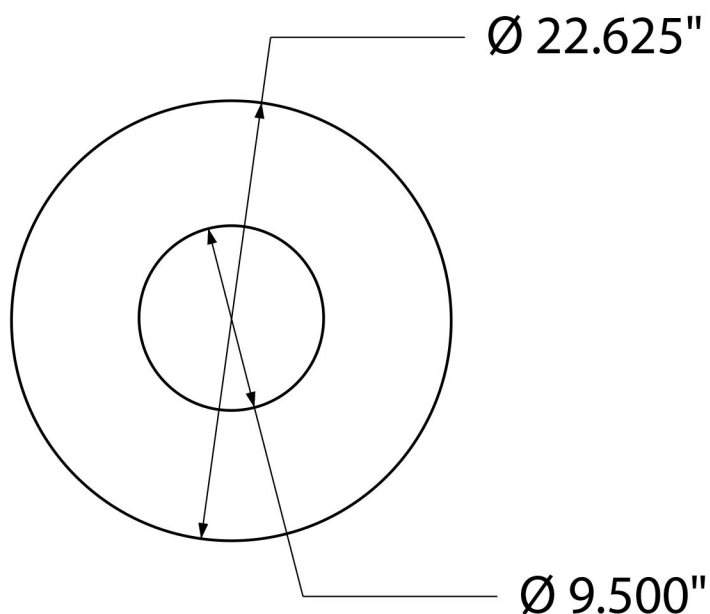

product details

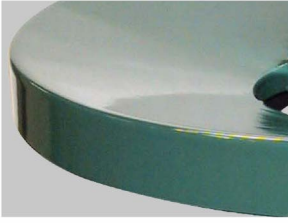

Coated Surfaces:

- Thermoplastic coated
- Copolymer-based, environmentally safe
- Does not fade, crack, peel warp
- Applied at a thickness of 25-30 mils.
- 5 Year warranty on coating

Construction:

- 20 gauge steel

SPEC SHEET: OF-SR32-SD-SML

32 GALLON RIBBON RECEPTACLE WITH DOOR

Wt. 175 lbs

photo



top view

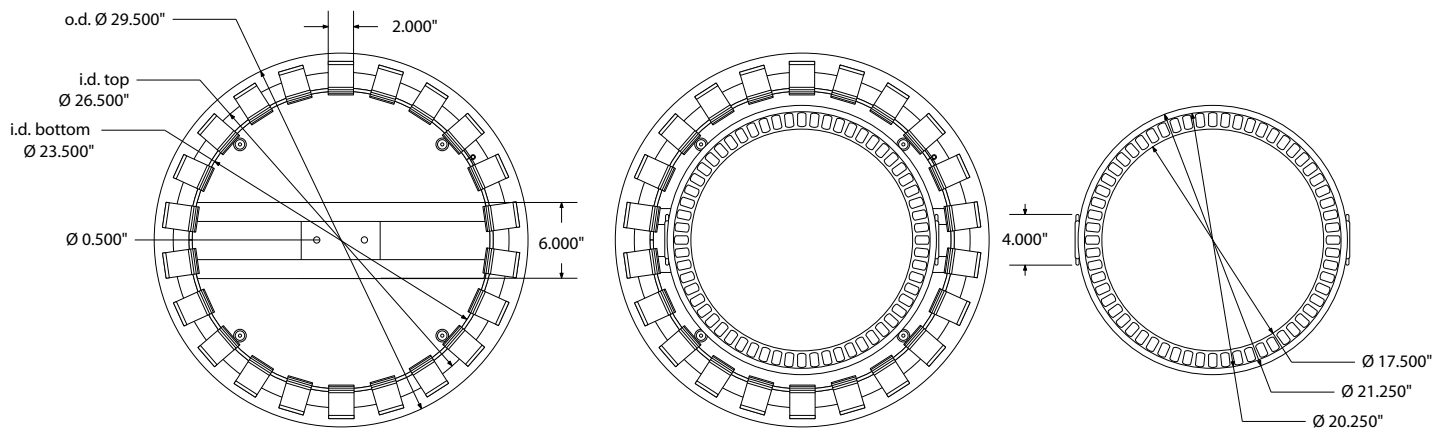

side view

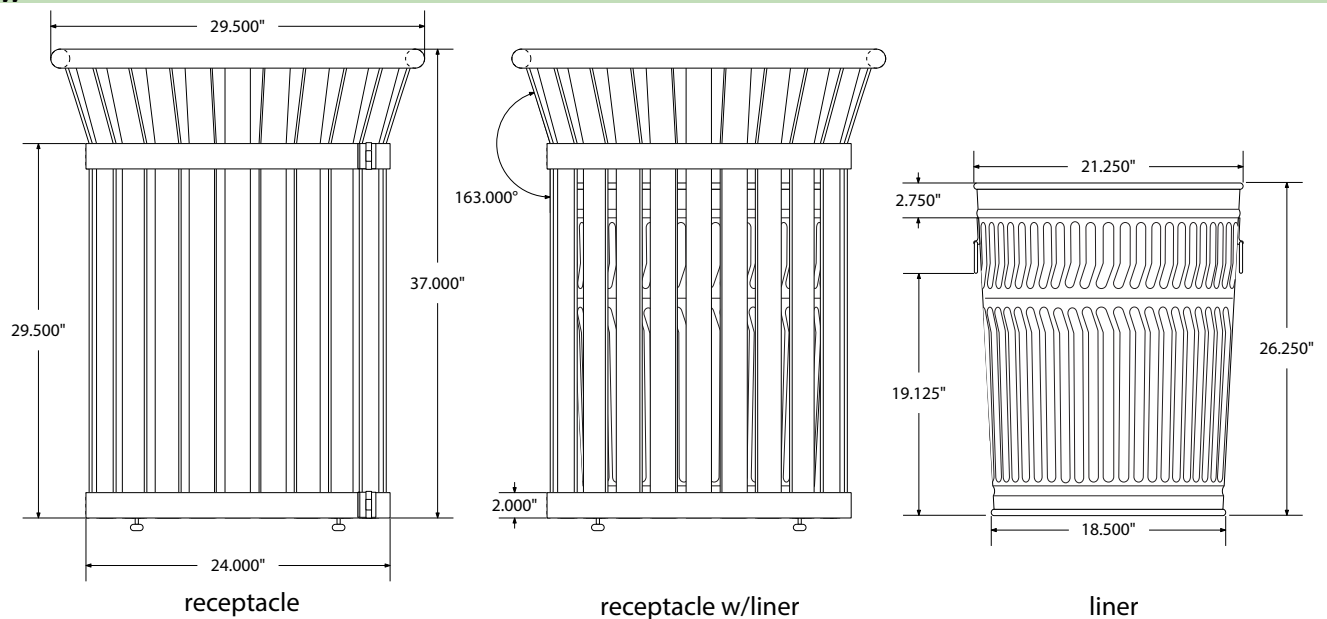

spun metal lid - top view

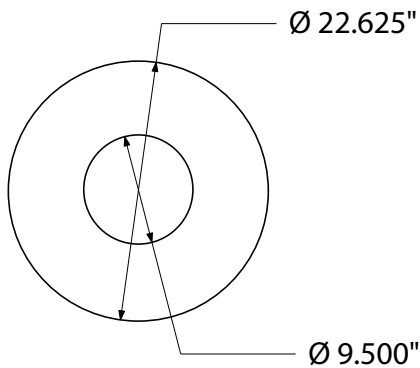

spun metal lid - side view

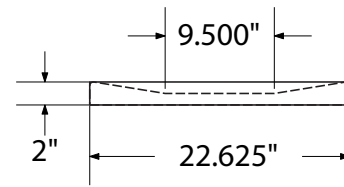

product details



Coated Surfaces:

- Thermoplastic coated
- Copolymer-based, environmentally safe
- Does not fade, crack, peel warp
- Applied at a thickness of 25-30 mils.
- 5 Year warranty on coating



Liner Construction:

- 25 Gauge zinc-coated galvanized steel

Construction:

- ¼" x 2" Steel straps
- 1½" Steel tube lip
- 4 Leveler feet
- Surface mount plate for B100, B200 mounts (see below)
- Chrome plated cast aluminum latch

mounting types

P = Portable :

No mount.

Surface Mount1:
Concrete anchors
through bottom plate.

Surface Mount2:
Bolts through bottom
plate into B100 surface
mount. B100 Mounted
to concrete with
anchors.

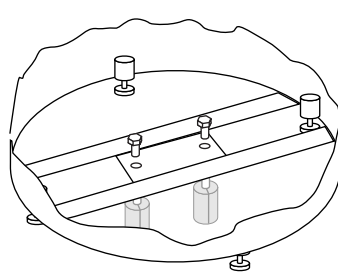

SURFACE MOUNT (1)

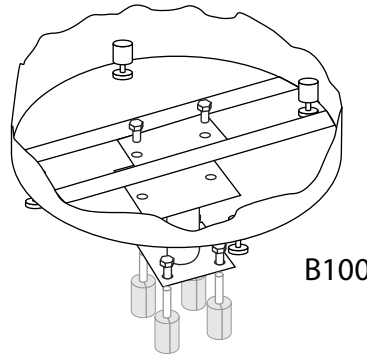

SURFACE MOUNT (2)

IG= In-Ground:
Bolts through bottom
plate into B200 surface
mount. B200 embed-
ded in hole filled with
concrete.

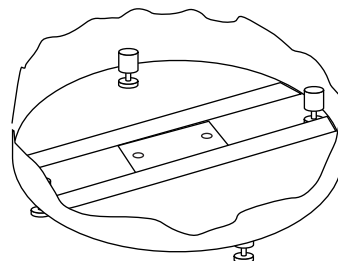

PORTABLE

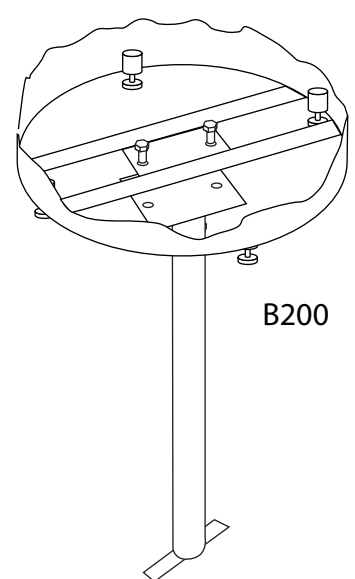

IN-GROUND

All design specifics subject to change. For all products Palmer Hamilton reserves the right to make adjustments due to changing market conditions, product discontinuation, legislative requirements or other extenuating circumstances.

SPEC SHEET: R32L

32 GALLON RECEPTACLE LINER

Wt. 8 lbs

photo



bottom / top view

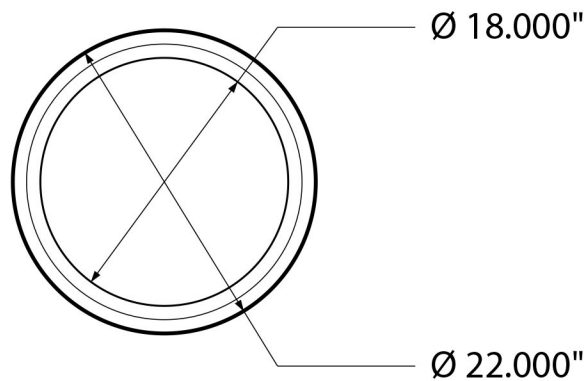

front view

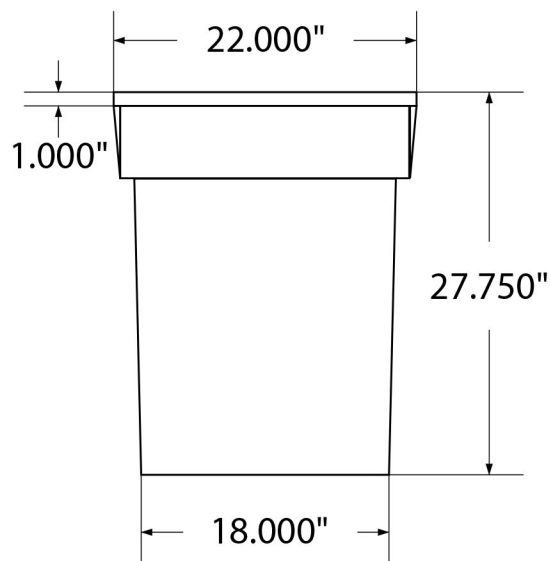

product finish



Liner is made from black polyethylene plastic.

SPEC SHEET : RB32-SML

32 GALLON RING-BANDED RECEPTACLE W SPUN METAL LID *portable* Wt. 165 lbs

photo



bottom / top view

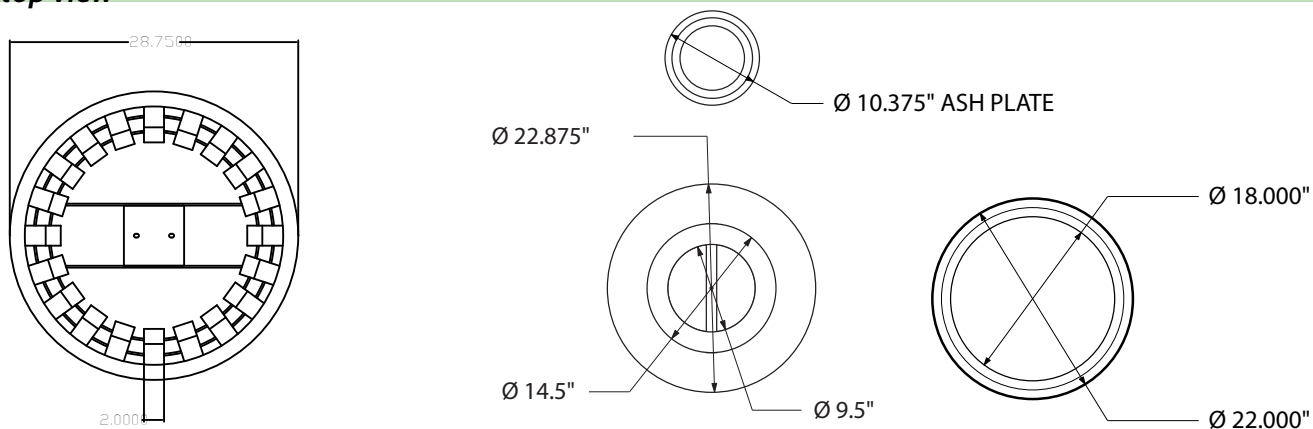

front view

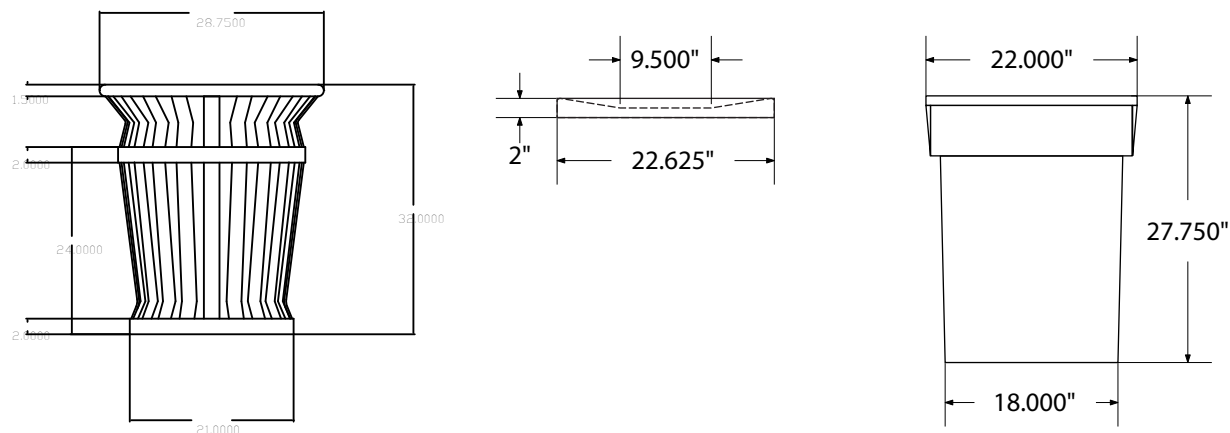

RECEPTACLE

LID

INSERT

product details



Coated Surfaces:

- Thermoplastic coated
- Copolymer-based, environmentally safe
- Does not fade, crack, peel warp
- Applied at a thickness of 25-30 mils.
- 5 Year warranty on coating



Liner:

- Black polyethylene plastic

Construction:

- 1/4" x 2" Steel straps
- 1 1/2" Steel tube lip
- Optional surface mount plate for B100, B200 mounts (see below)

mounting types

P = Portable :
No mount.

Surface Mount1:
Concrete anchors
through bottom plate.

Surface Mount2:
Bolts through bottom
plate into B100 surface
mount. B100 Mounted
to concrete with
anchors.

IG= In-Ground:
Bolts through bottom
plate into B200 surface
mount. B200 embed-
ded in hole filled with
concrete.

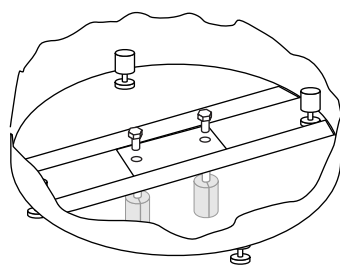

SURFACE MOUNT (1)

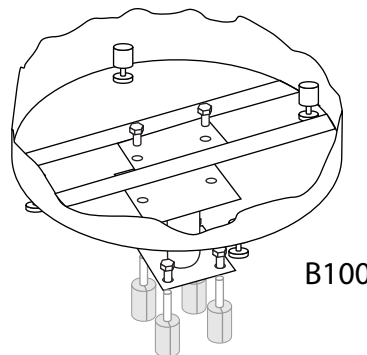

SURFACE MOUNT (2)

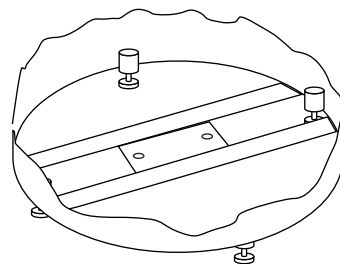

PORTABLE

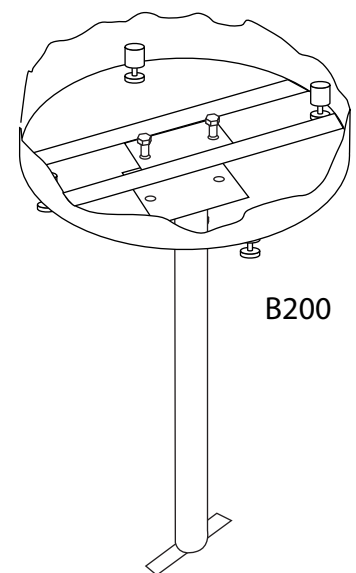

IN-GROUND

SPEC SHEET: SR32-SML

32 GALLON WELDED RECEPTACLE W SPUN METAL LID *portable* **Wt. 160 lbs**
photo



bottom / top view

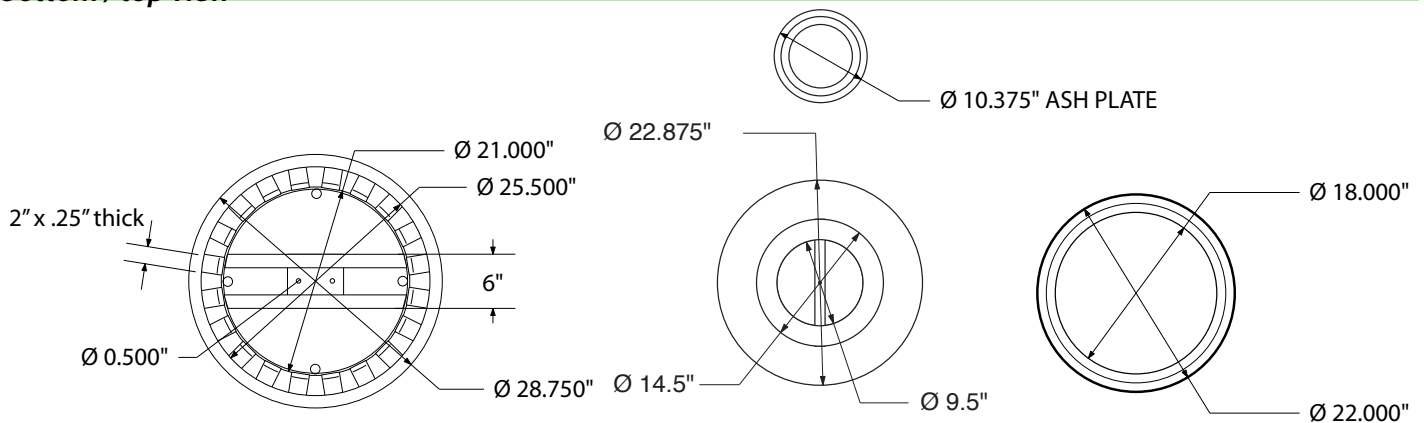

front view

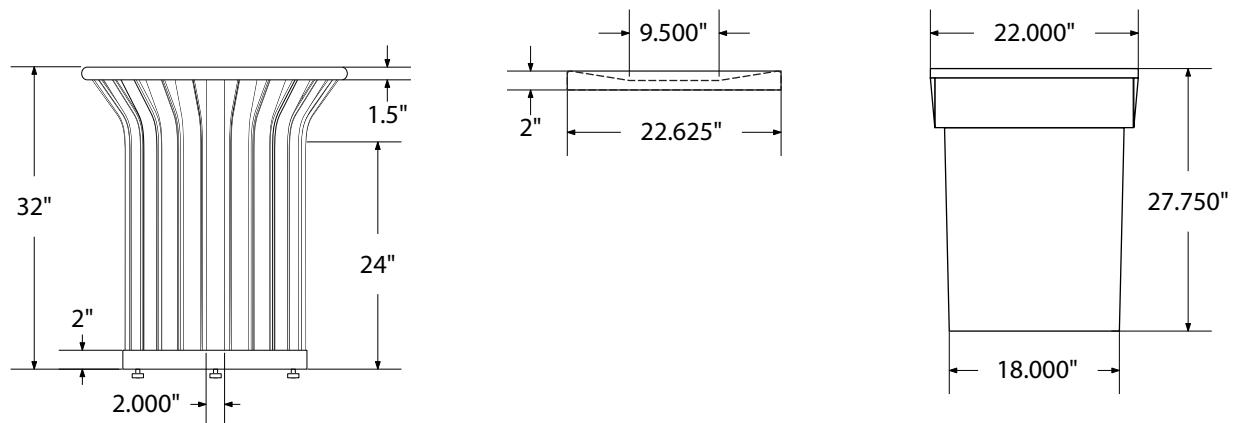

RECEPTACLE

LID

INSERT

product details



Coated Surfaces:

- Thermoplastic coated
- Copolymer-based, environmentally safe
- Does not fade, crack, peel warp
- Applied at a thickness of 25-30 mils.
- 5 Year warranty on coating



Liner:

- Black polyethylene plastic

Construction:

- 1/4" x 2" Steel straps
- 1 1/2" Steel tube lip
- 4 Leveler feet
- Optional surface mount plate for B100, B200 mounts (see below)

mounting types

P = Portable :
No mount.

Surface Mount1:
Concrete anchors
through bottom plate.

Surface Mount2:
Bolts through bottom
plate into B100 surface
mount. B100 Mounted
to concrete with
anchors.

IG= In-Ground:
Bolts through bottom
plate into B200 surface
mount. B200 embed-
ded in hole filled with
concrete.

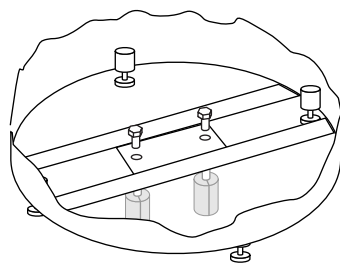

SURFACE MOUNT (1)

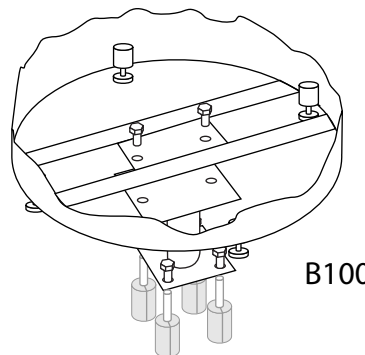

SURFACE MOUNT (2)

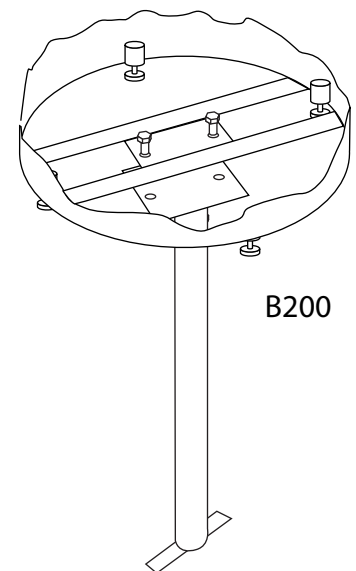

IN-GROUND

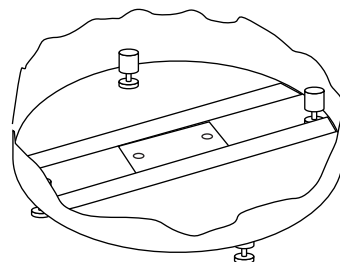

PORTABLE