

SPEC SHEET: T46ROP

46' ROUND EXPANDED METAL TABLE PORTABLE

Wt. 255 lbs

photo



top view

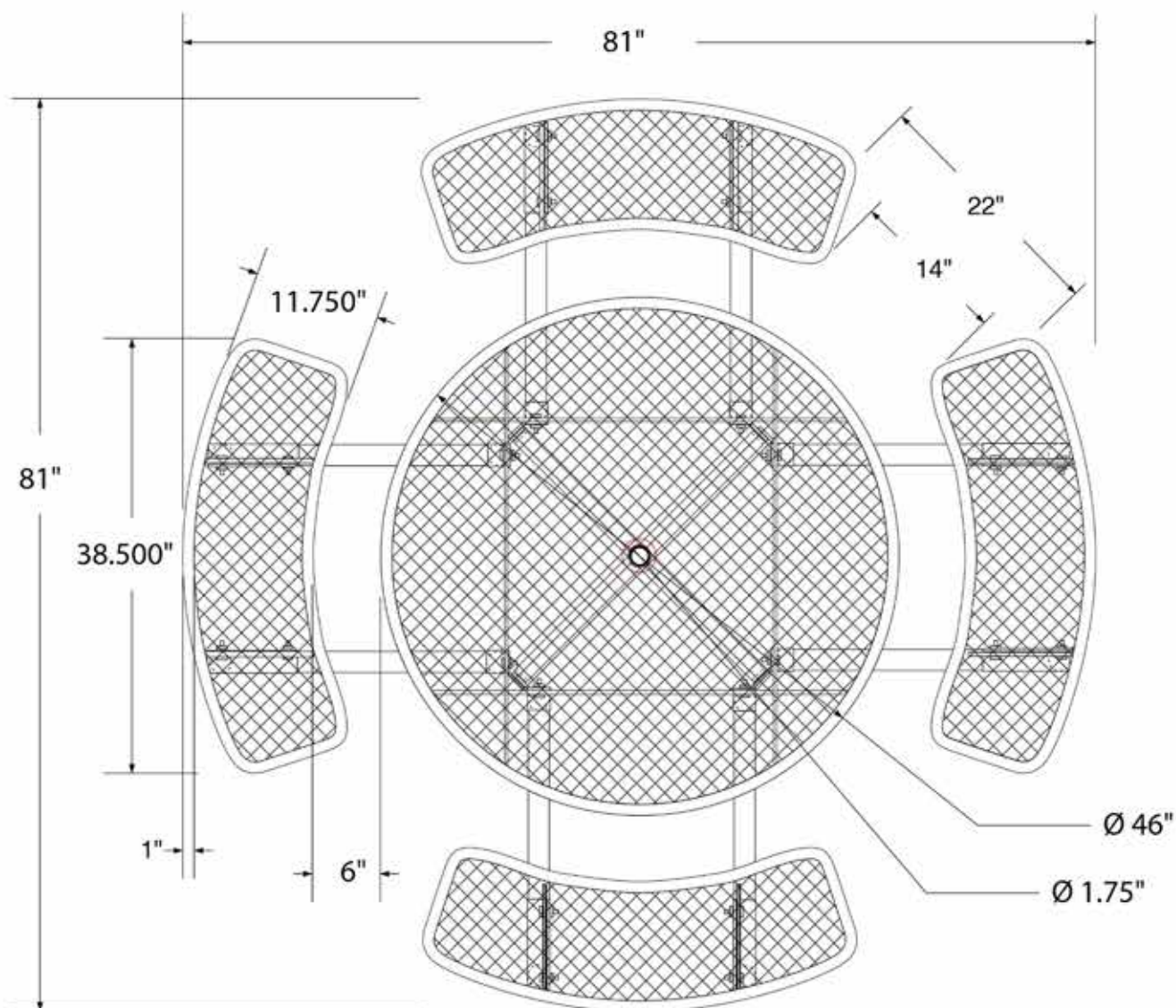

side view

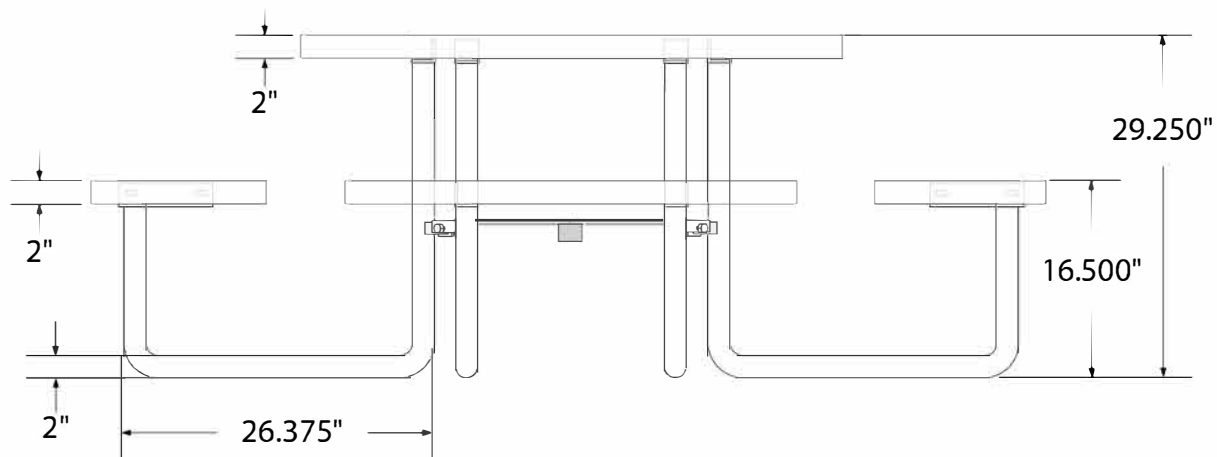

product details



Coated Surfaces:

- Thermoplastic coated
- Copolymer-based, environmentally safe
- Does not fade, crack, peel warp
- Applied at a thickness of 25-30 mils.
- 5 Year warranty on coating



Construction:

- Seats and tops - 9 gauge steel
- 2" tubular understructure
- Understructure - galvanized steel
- Understructure finish - black polyester powder coated
- Nuts, washers and bolts - galvanized steel

mounting types

P = Portable : no mount

SM = Surface Mount:
concrete anchors
through discs welded
to legs

IG= In-Ground:
J-rods set in concrete
through discs welded
to legs

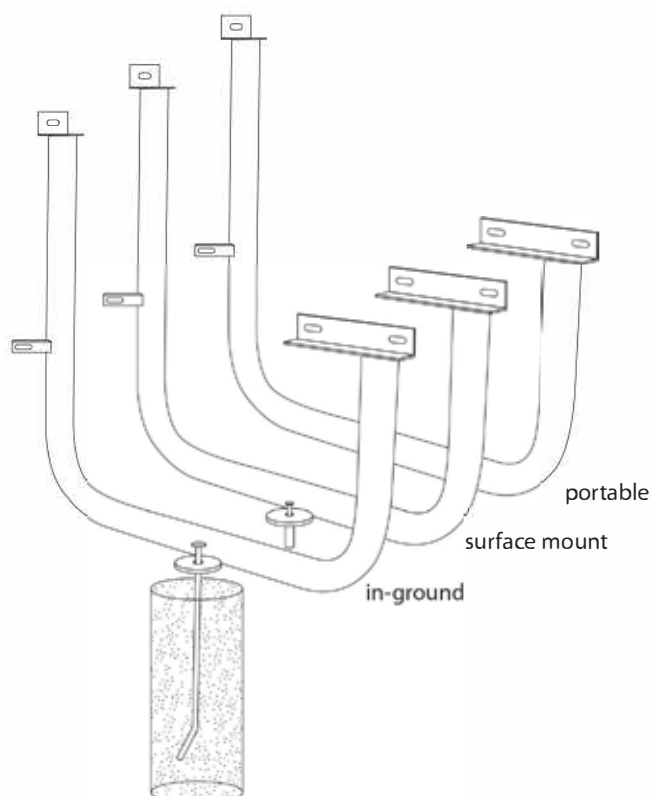

All design specifics subject to change. For all products Palmer Hamilton reserves the right to make adjustments due to changing market conditions, product discontinuation, legislative requirements or other extenuating circumstances.

SPEC SHEET: T46ROP-PERF

46' ROUND PERFORATED METAL TABLE *PORTABLE*

Wt. 300 lbs

photo



top view

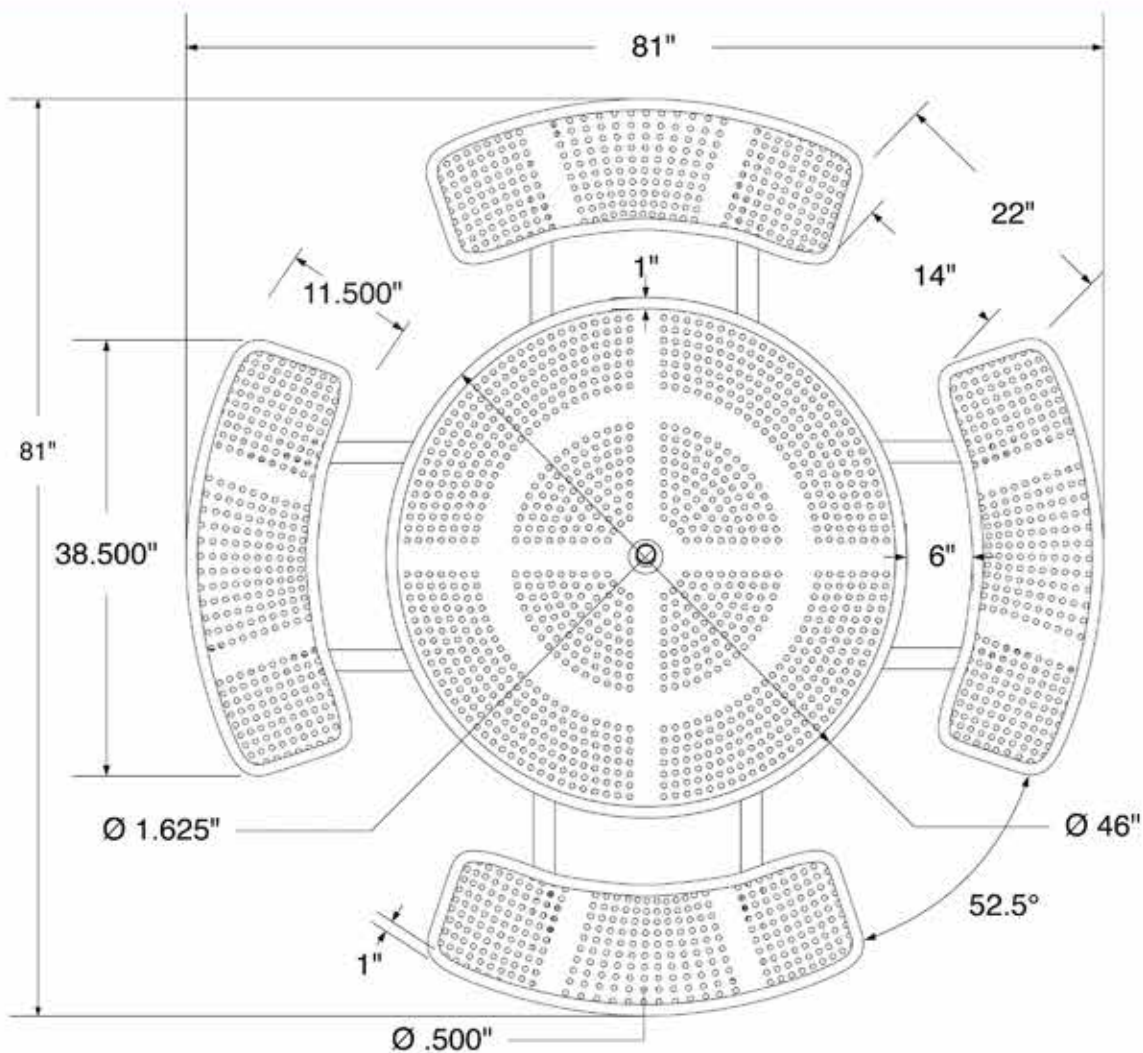

SPEC SHEET: T46ROP-ADA

46' ROUND EXPANDED ADA METAL TABLE PORTABLE

Wt. 230 lbs

photo



top view

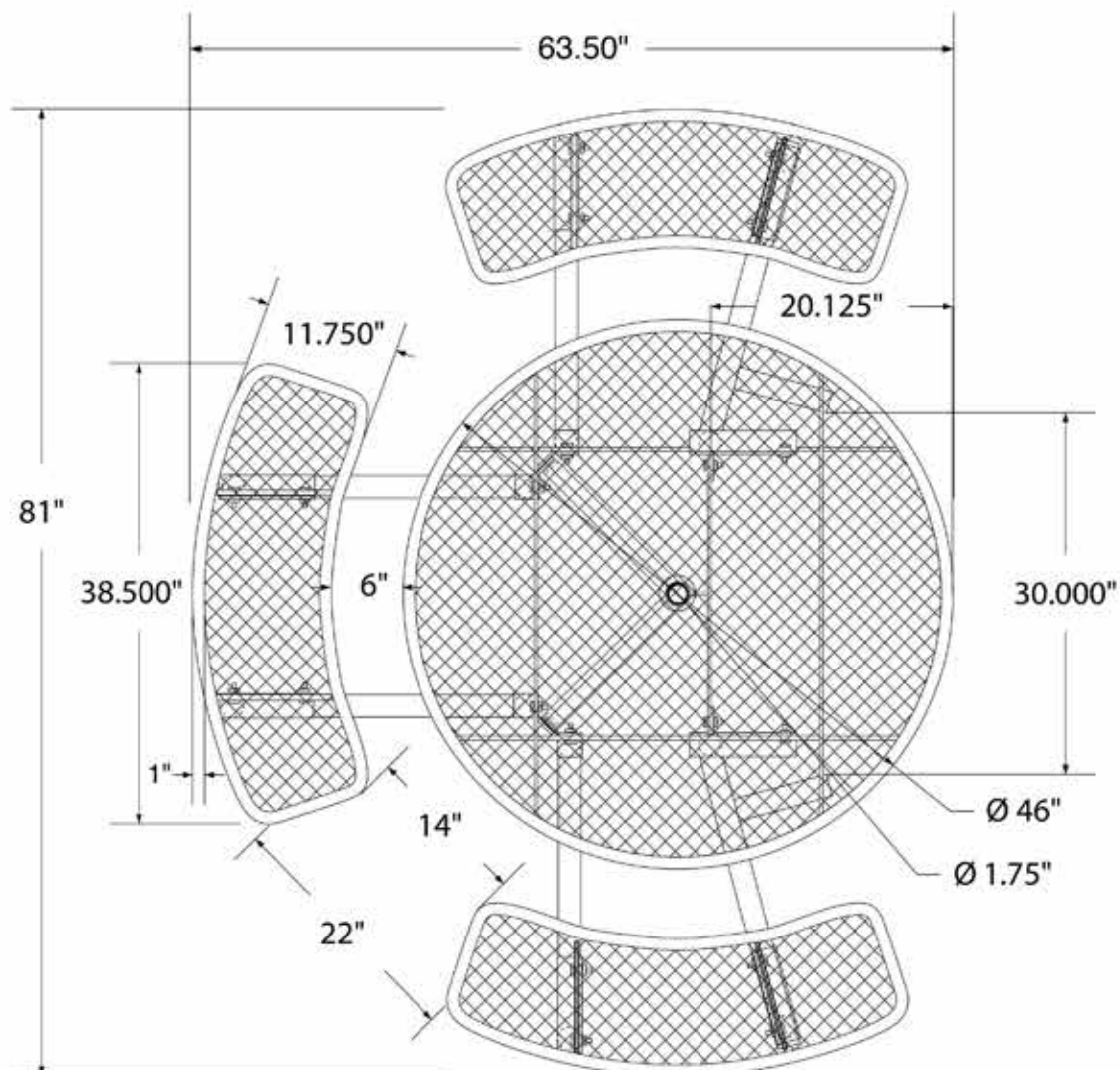

SPEC SHEET: T46ROP-ADA-PERF

46" ROUND PERFORATED METAL ADA TABLE PORTABLE

Wt. 230 lbs

photo



top view

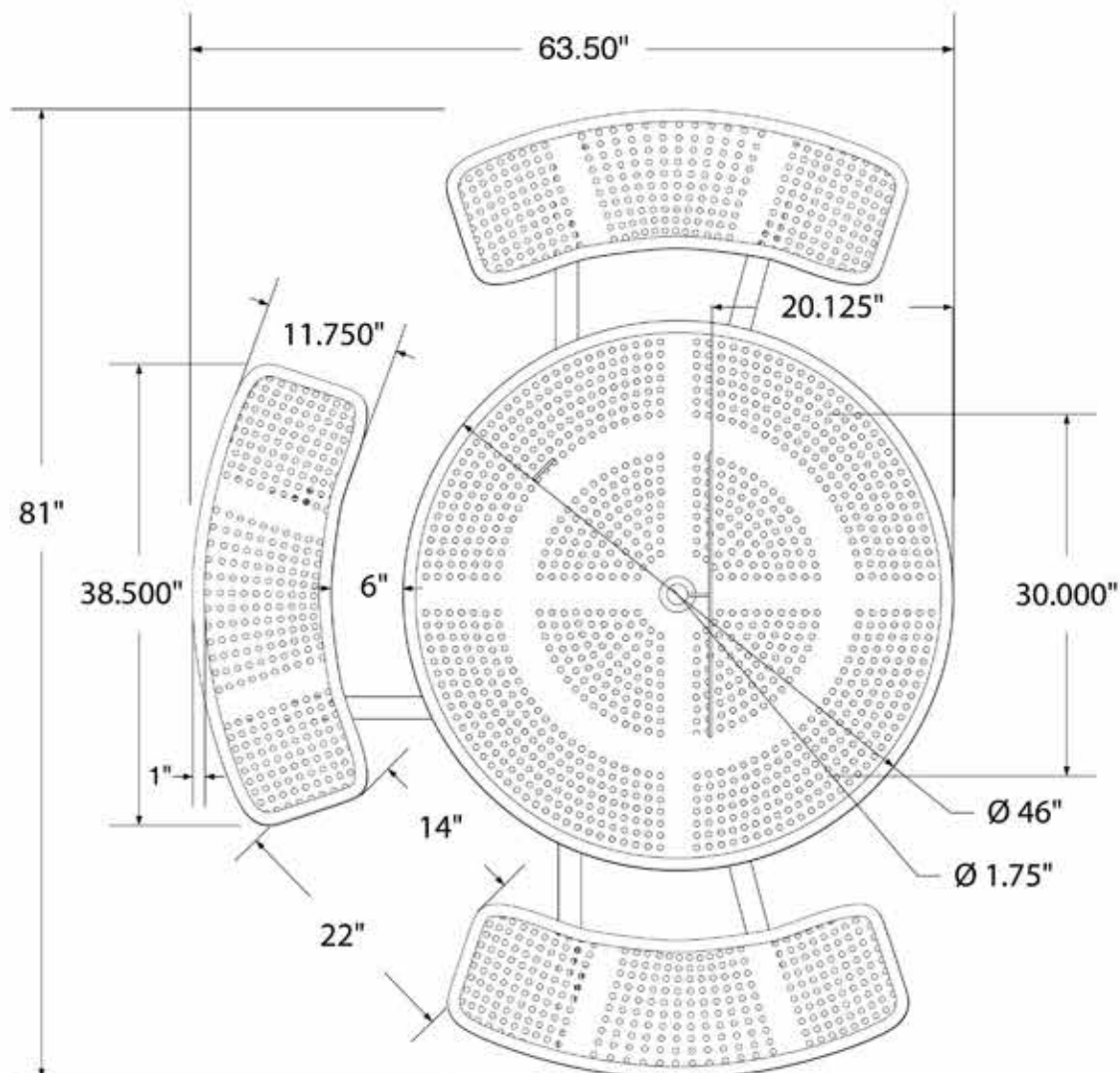

SPEC SHEET: T46SQP

46' SQUARE EXPANDED METAL TABLE *PORTABLE*

Wt. 265 lbs

photo



top view

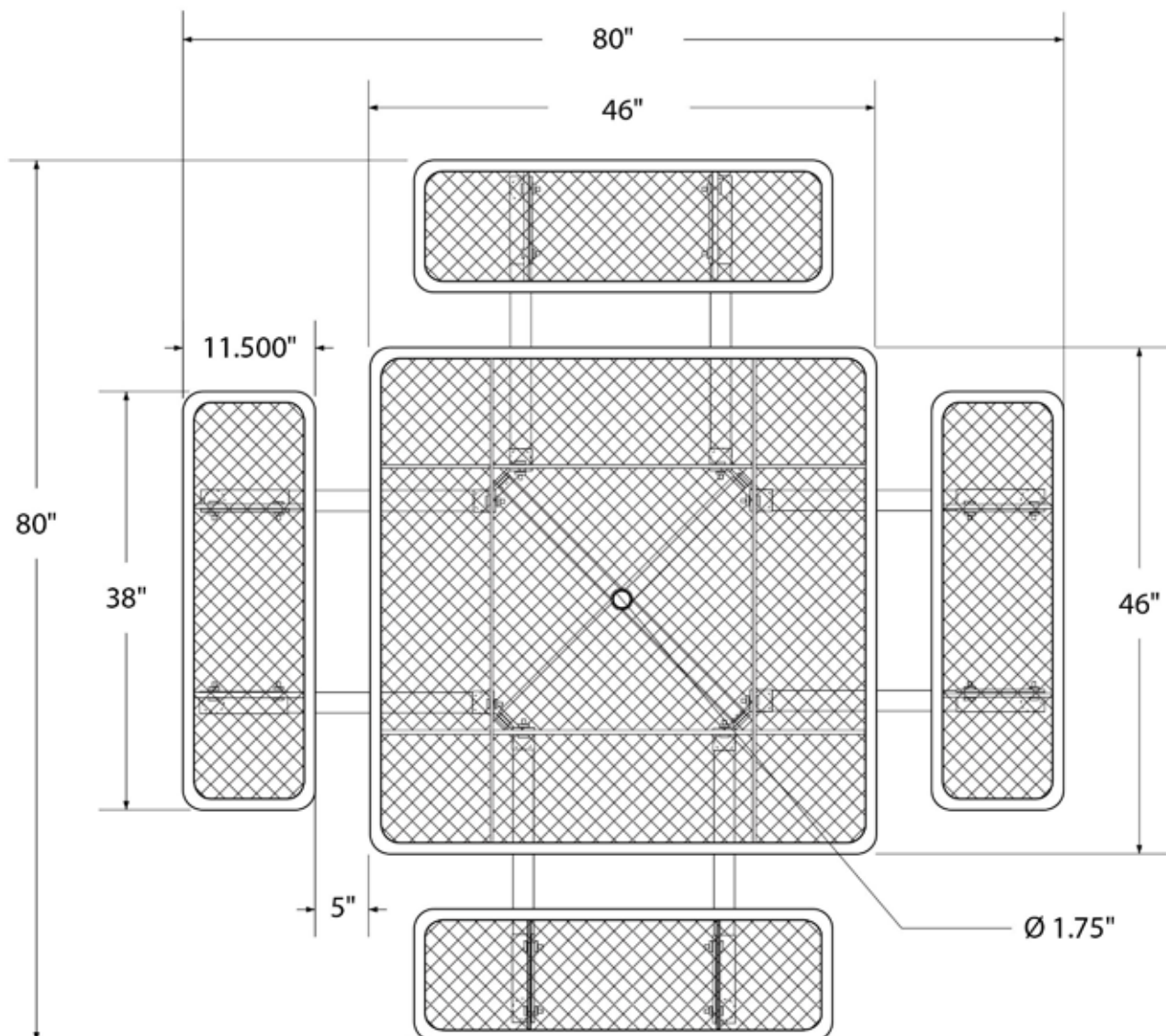

side view

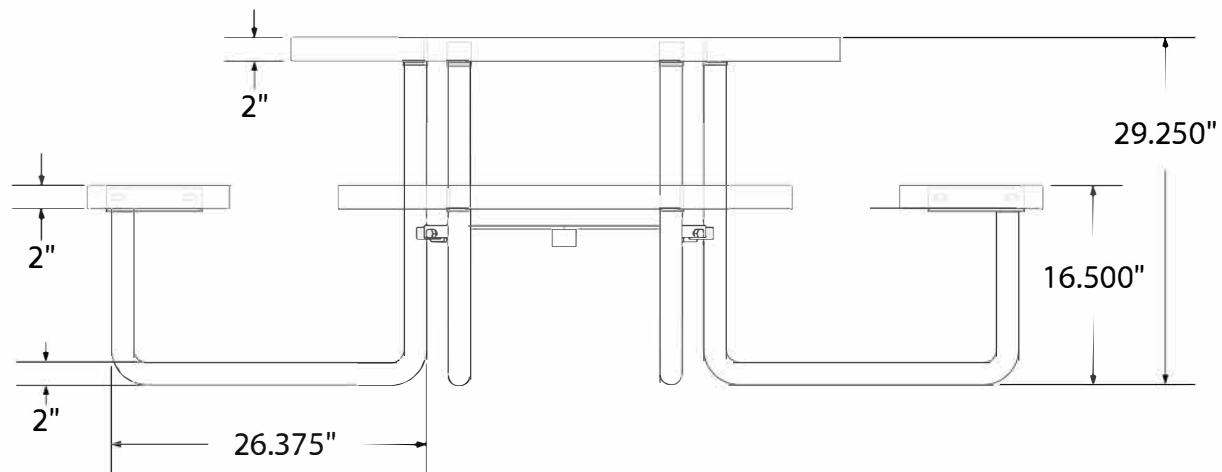

product details

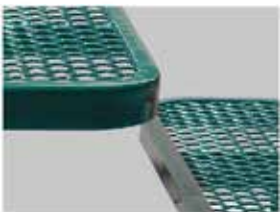

Coated Surfaces:

- Thermoplastic coated
- Copolymer-based, environmentally safe
- Does not fade, crack, peel warp
- Applied at a thickness of 25-30 mils.
- 5 Year warranty on coating



Construction:

- Seats and tops - 9 gauge steel
- 2" tubular understructure
- Understructure - galvanized steel
- Understructure finish - black polyester powder coated
- Nuts, washers and bolts - galvanized steel

mounting types

P = Portable : no mount

SM = Surface Mount:
concrete anchors
through discs welded
to legs

IG= In-Ground:
J-rods set in concrete
through discs welded
to legs

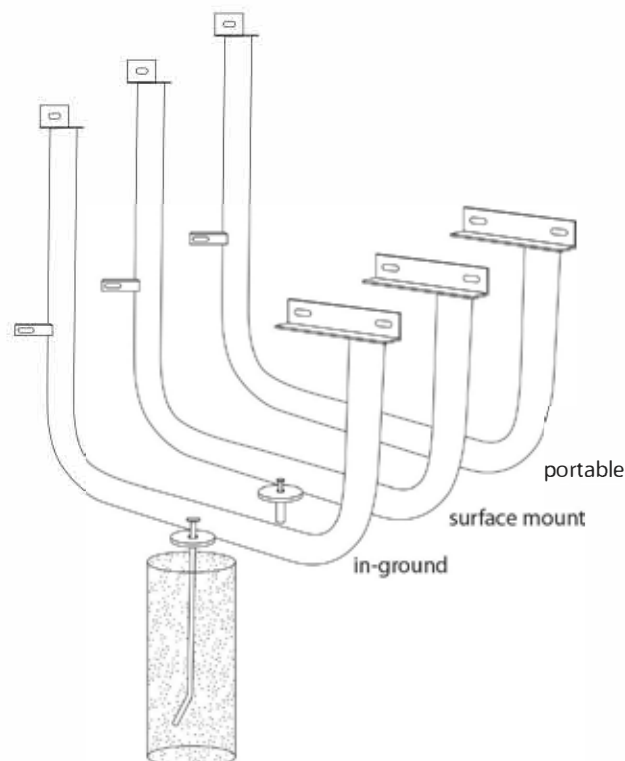

All design specifics subject to change. For all products Palmer Hamilton reserves the right to make adjustments due to changing market conditions, product discontinuation, legislative requirements or other extenuating circumstances.

SPEC SHEET: T46SQP-PERF

46' SQUARE PERFORATED METAL TABLE *PORTABLE*

Wt. 310 lbs

photo



top view

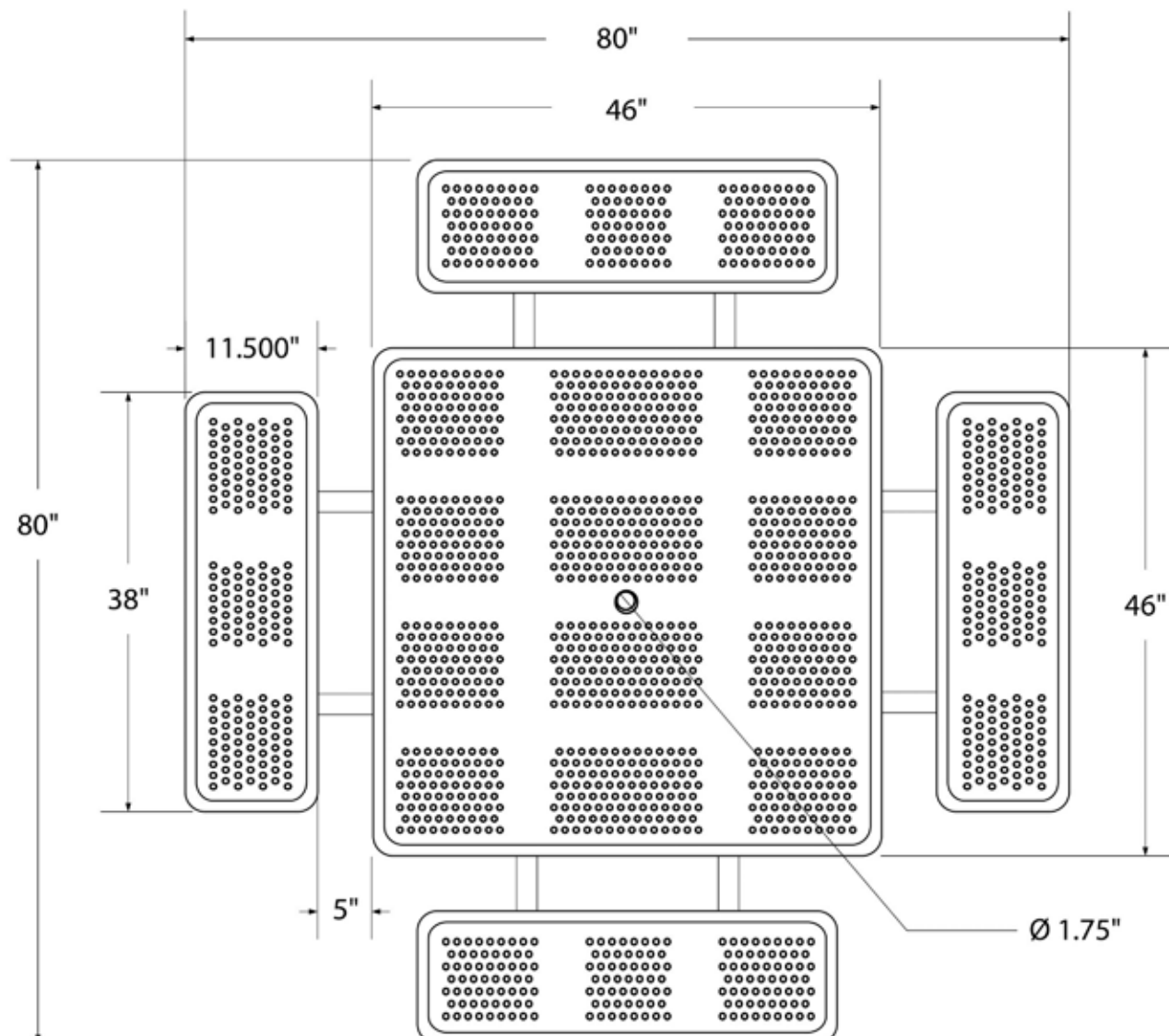

SPEC SHEET: T46SQP-ADA

46' SQUARE EXPANDED ADA METAL TABLE *PORTABLE*

Wt. 250 lbs

photo



top view

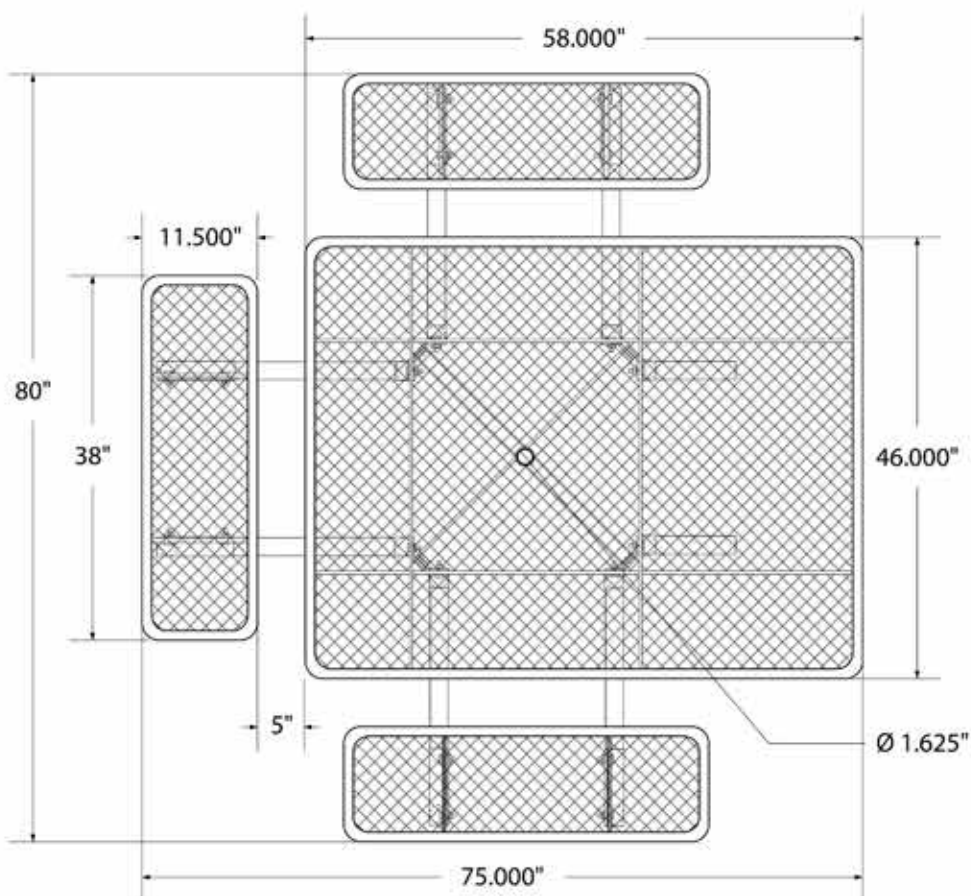

SPEC SHEET: T46SQP-ADA-PERF

46' SQUARE PERFORATED ADA METAL TABLE PORTABLE

Wt. 240 lbs

photo



top view

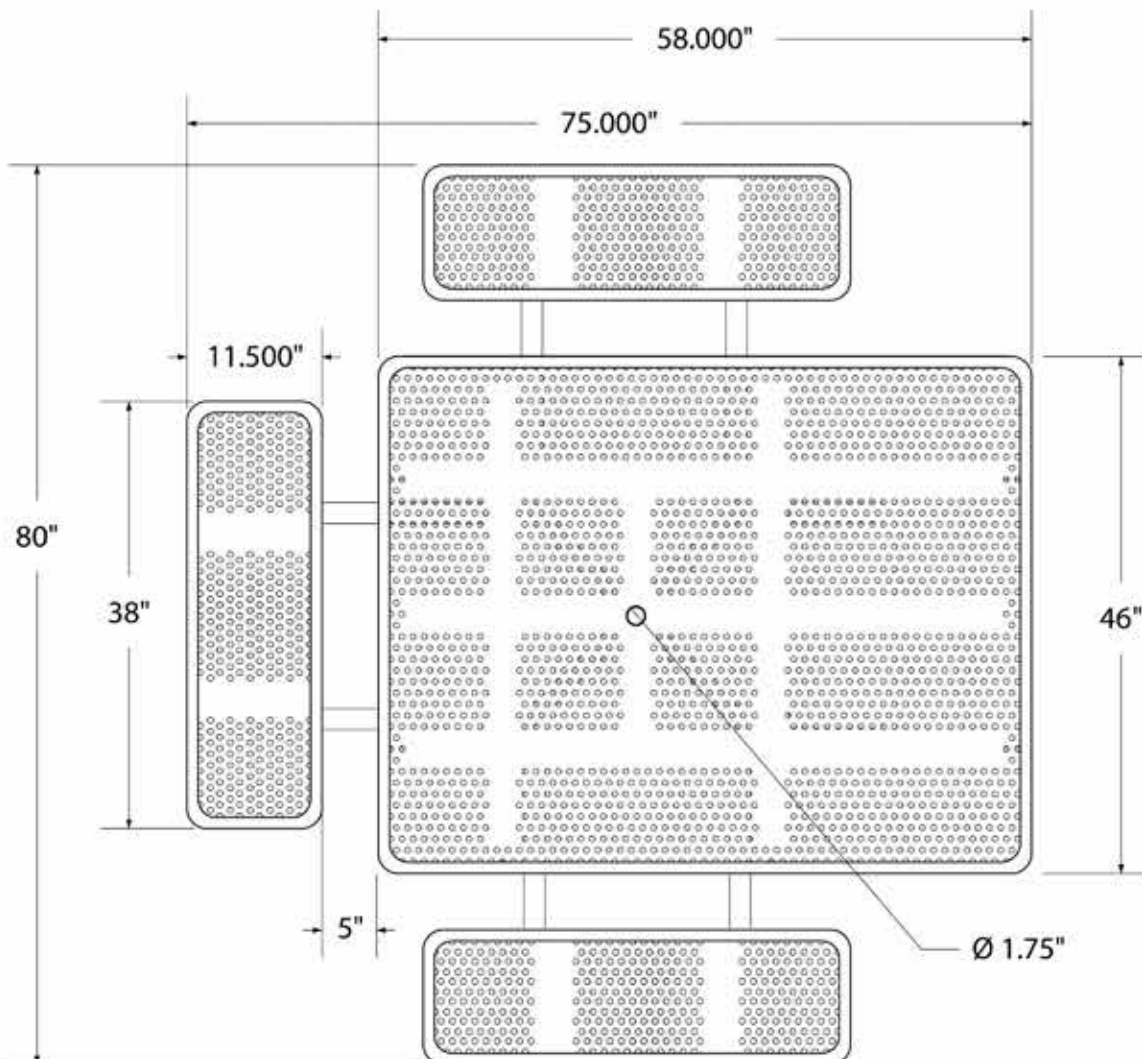

SPEC SHEET: T6XPP

6' STD EXP PICNIC TABLE *portable*
photo

Wt. 210 lbs



top view

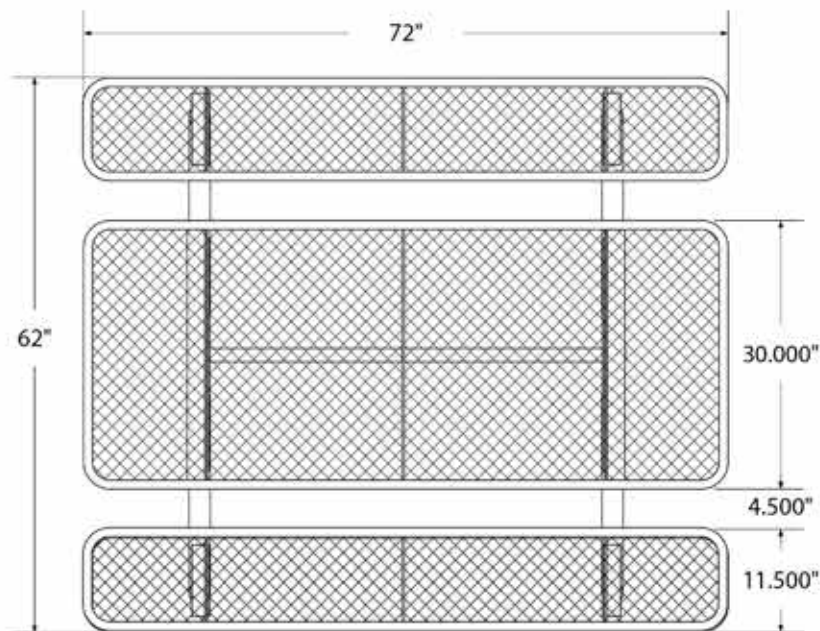

front view

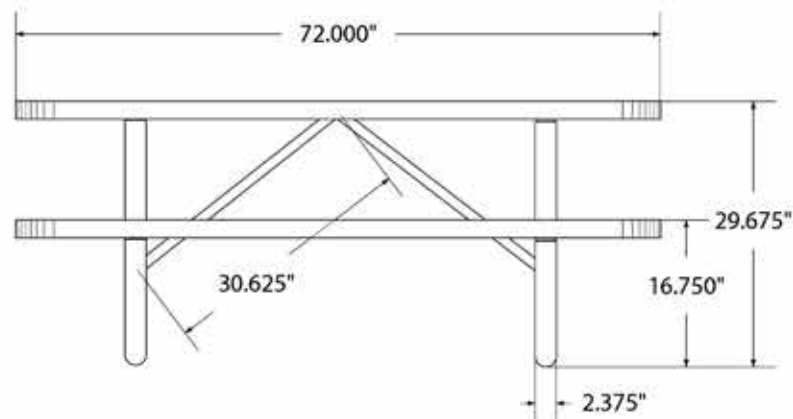

side view

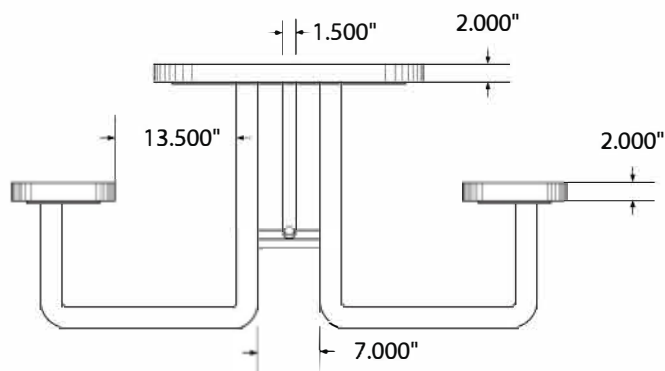

product details



Coated Surfaces:

- Thermoplastic coated
- Copolymer-based, environmentally safe
- Does not fade, crack, peel or warp
- Applied at a thickness of 25-30 mils.
- 5 Year warranty on coating



Construction:

- Seats and tops - 9 gauge steel
- 2 3/8" tubular understructure
- Understructure - galvanized steel
- Understructure finish - black polyester powder coated
- Nuts, washers and bolts - galvanized steel

mounting types

P = Portable : no mount

SM = Surface Mount:
concrete anchors
through discs welded
to legs

IG= In-Ground:
J-rods set in concrete
through discs welded
to legs

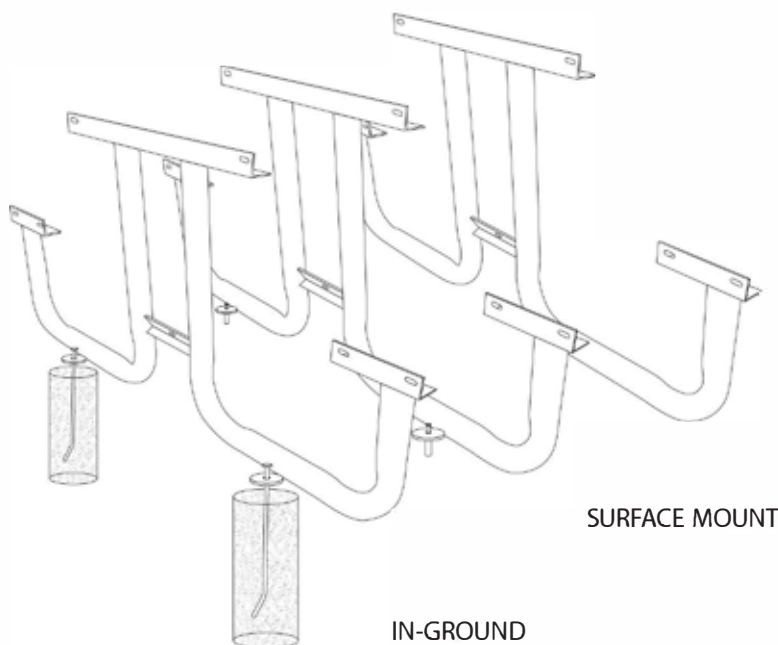

SPEC SHEET: T6XPP-PERF

6' STANDARD PERFORATED PICNIC TABLE *portable*

Wt. 280 lbs

photo



top view

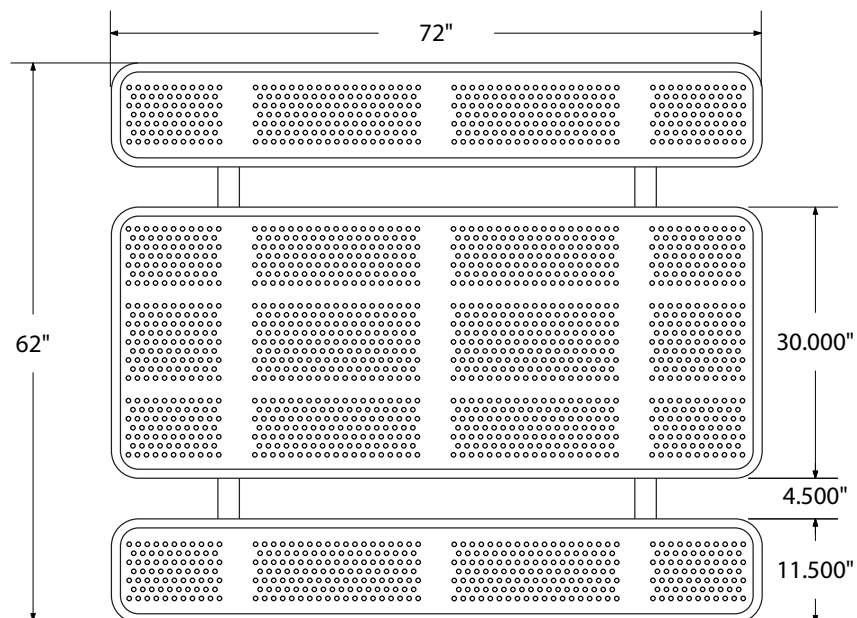

front view

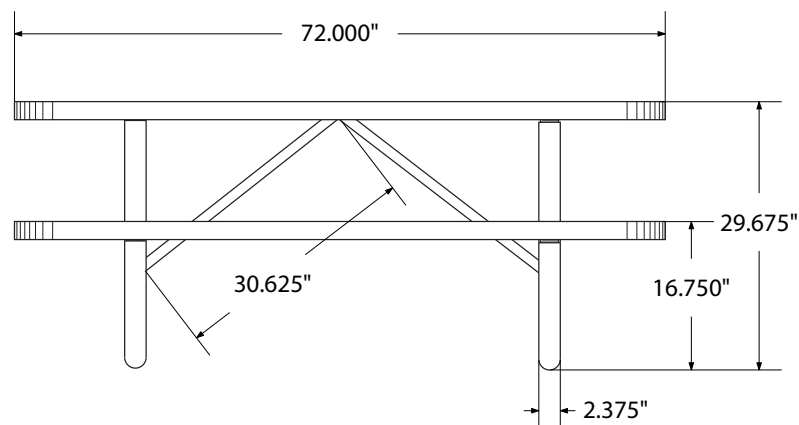

side view

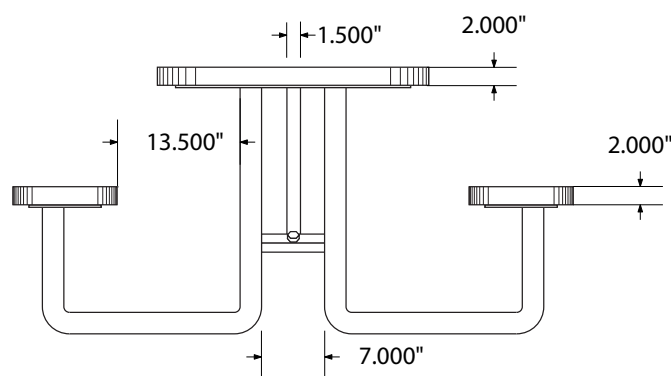

product details



Coated Surfaces:

- Thermoplastic coated
- Copolymer-based, environmentally safe
- Does not fade, crack, peel or warp
- Applied at a thickness of 25-30 mils.
- 5 Year warranty on coating



Construction:

- Seats and tops - 11 gauge steel
- 2 3/8" tubular understructure
- Understructure - galvanized steel
- Understructure finish - black polyester powder coated
- Nuts, washers and bolts - galvanized steel

mounting types

P = Portable : no mount

SM = Surface Mount:
concrete anchors
through discs welded
to legs

IG= In-Ground:
J-rods set in concrete
through discs welded
to legs

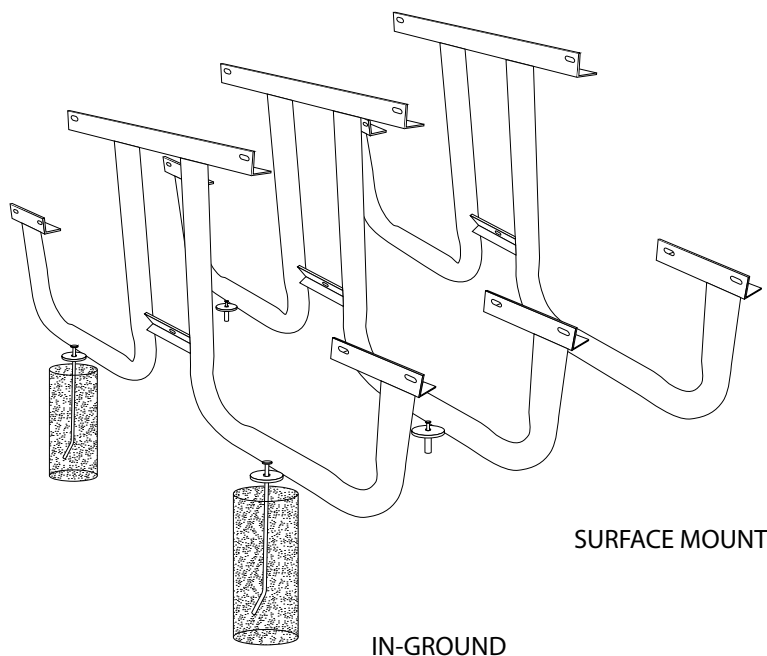

SPEC SHEET: T8XPP

8' STD EXP PICNIC TABLE *portable*

Wt. 280 lbs

photo



top view

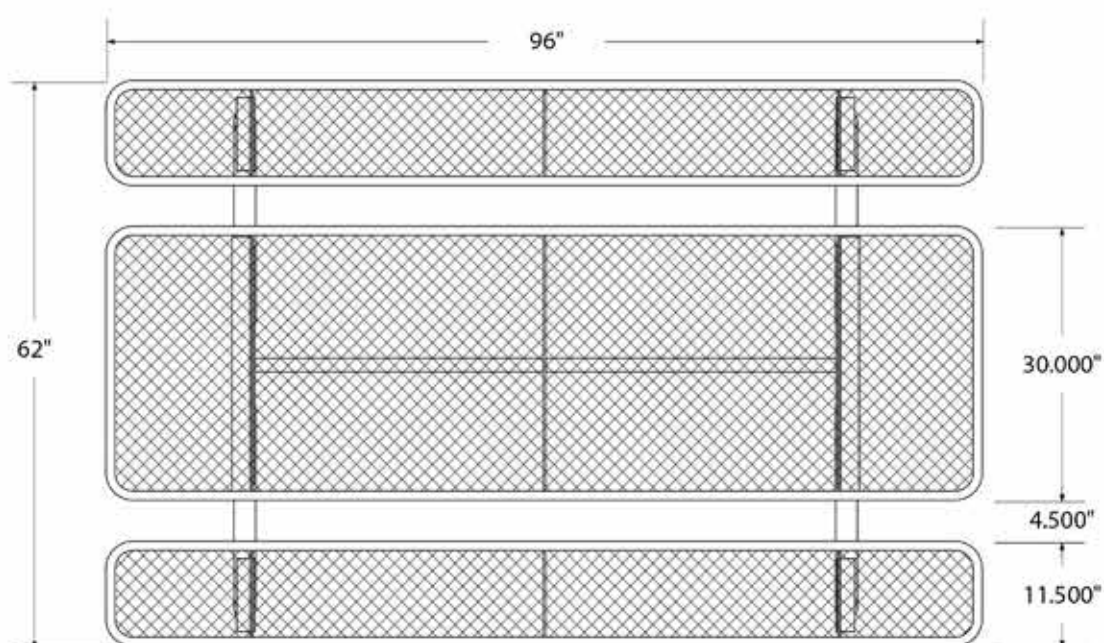

front view

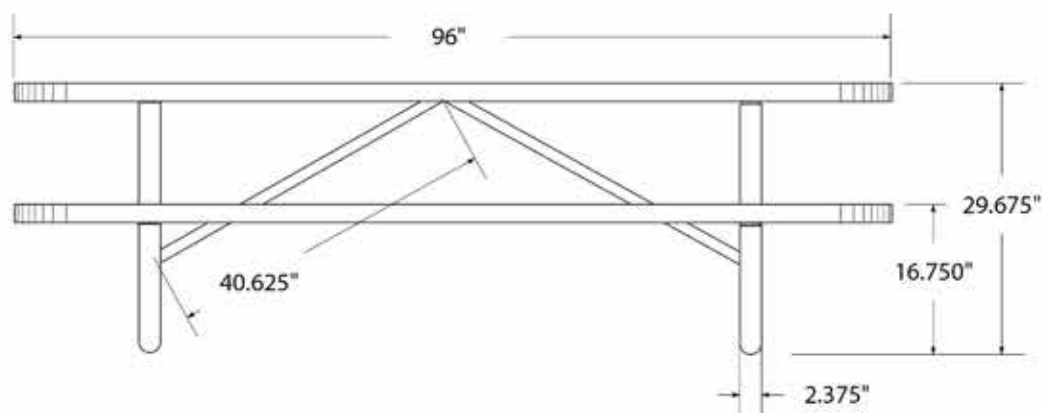

side view

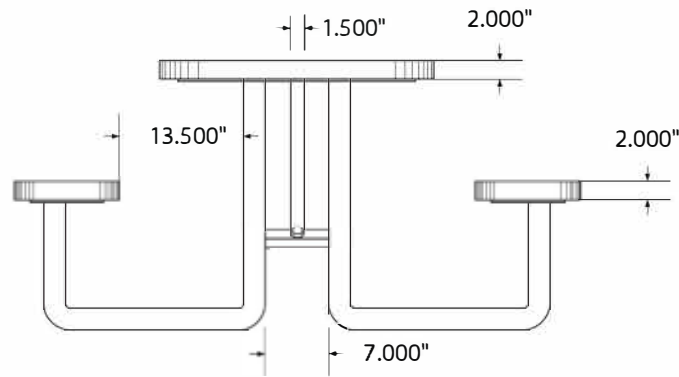

product details

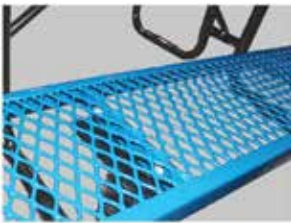

Coated Surfaces:

- Thermoplastic coated
- Copolymer-based, environmentally safe
- Does not fade, crack, peel or warp
- Applied at a thickness of 25-30 mils.
- 5 Year warranty on coating



Construction:

- Seats and tops - 9 gauge steel
- 2 3/8\" tubular understructure
- Understructure - galvanized steel
- Understructure finish - black polyester powder coated
- Nuts, washers and bolts - galvanized steel

mounting types

P = Portable : no mount

SM = Surface Mount:
concrete anchors
through discs welded
to legs

IG= In-Ground:
J-rods set in concrete
through discs welded
to legs

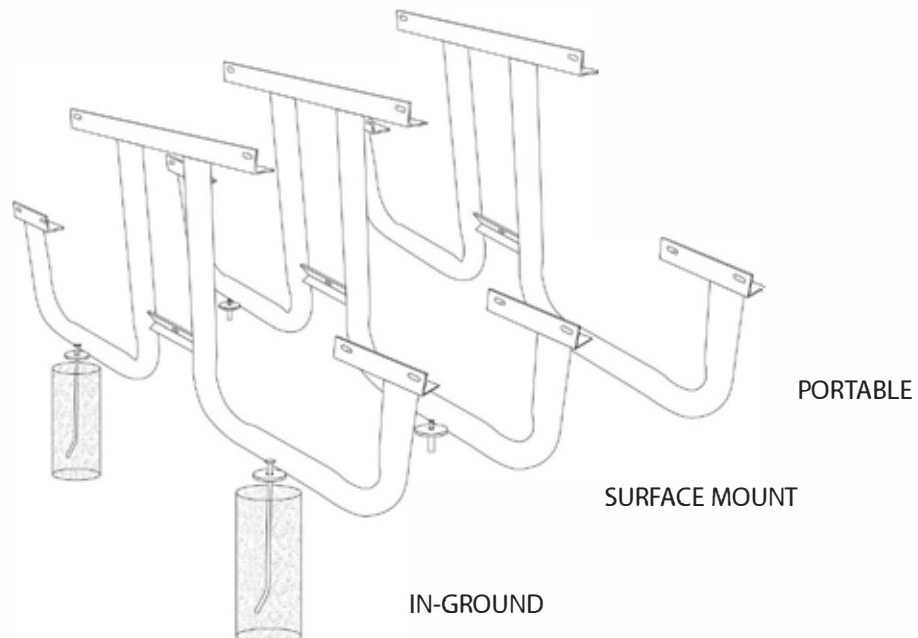

SPEC SHEET: T8XPP-PERF

8' STANDARD PERFORATED PICNIC TABLE *portable*

Wt. 370 lbs

photo



top view

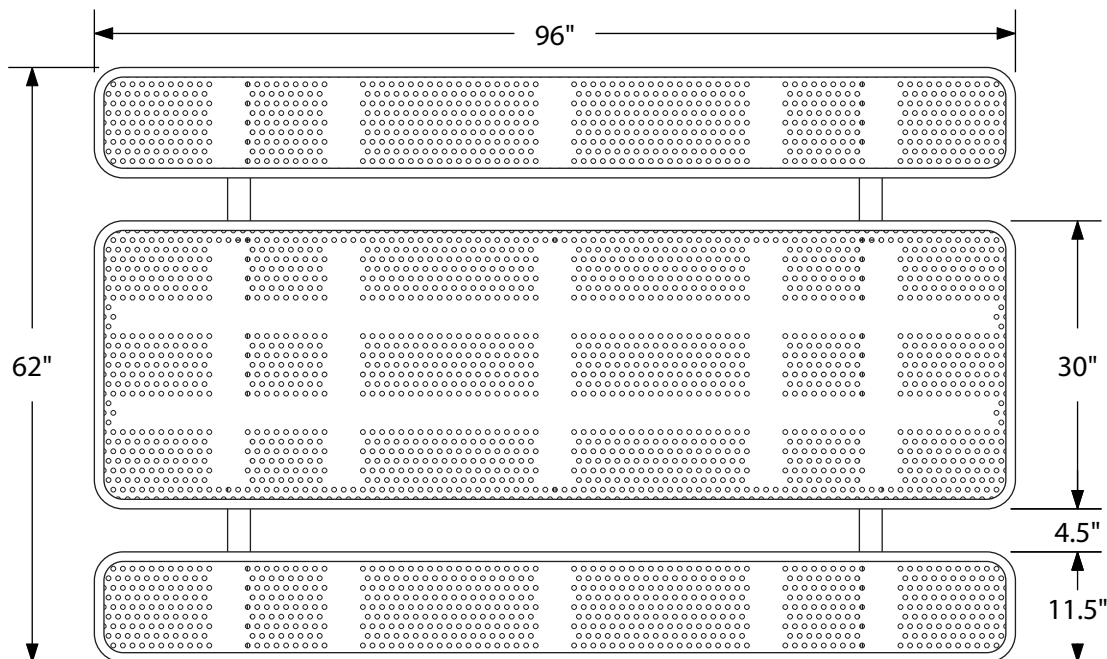

front view

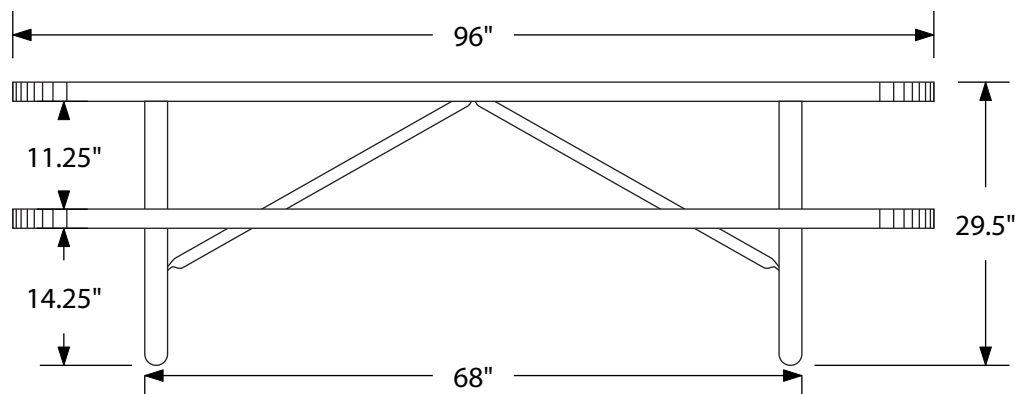

side view

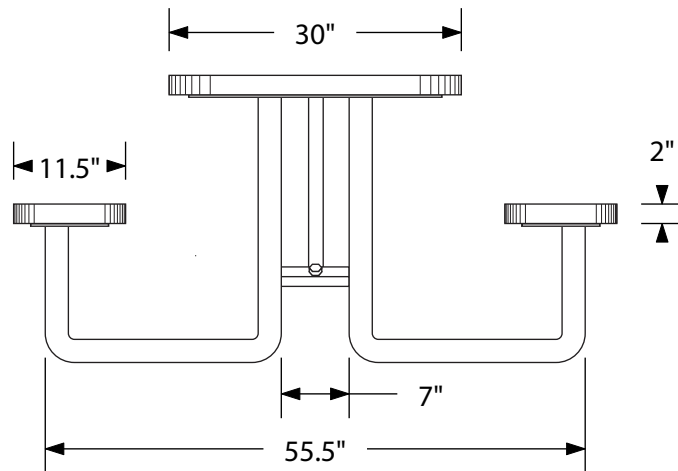

product details



Coated Surfaces:

- Thermoplastic coated
- Copolymer-based, environmentally safe
- Does not fade, crack, peel or warp
- Applied at a thickness of 25-30 mils.
- 5 Year warranty on coating



Construction:

- Seats and tops - 11 gauge steel
- 2 3/8" tubular understructure
- Understructure - galvanized steel
- Understructure finish - black polyester powder coated
- Nuts, washers and bolts - galvanized steel

mounting types

P = Portable : no mount

SM = Surface Mount:
concrete anchors
through discs welded
to legs

IG= In-Ground:
J-rods set in concrete
through discs welded
to legs

