

# palmer HAMILTON

## BREAKFAST CART

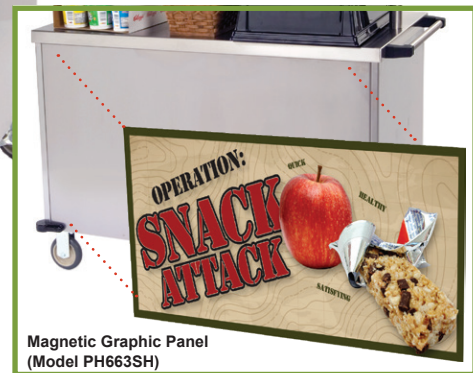

Model PH663



Magnetic Graphic Panel  
(Model PH663SH)

## DESIGN FEATURES

- Welded easy-to-clean stainless steel construction
- Spacious interior storage compartment
- Height-adjustable overhead display/serving rack
- Durable 16-gauge solid stainless steel top
- 3 poly storage bins included
- Horizontal tubular push handle
- Vinyl base corner bumpers
- Magnetic graphic panel (Model PH663SH)
- Non-marking 5" casters, 2 swivel with brake and 2 rigid
- Made in U.S.A.

*Over for more information.*

# BREAKFAST CART

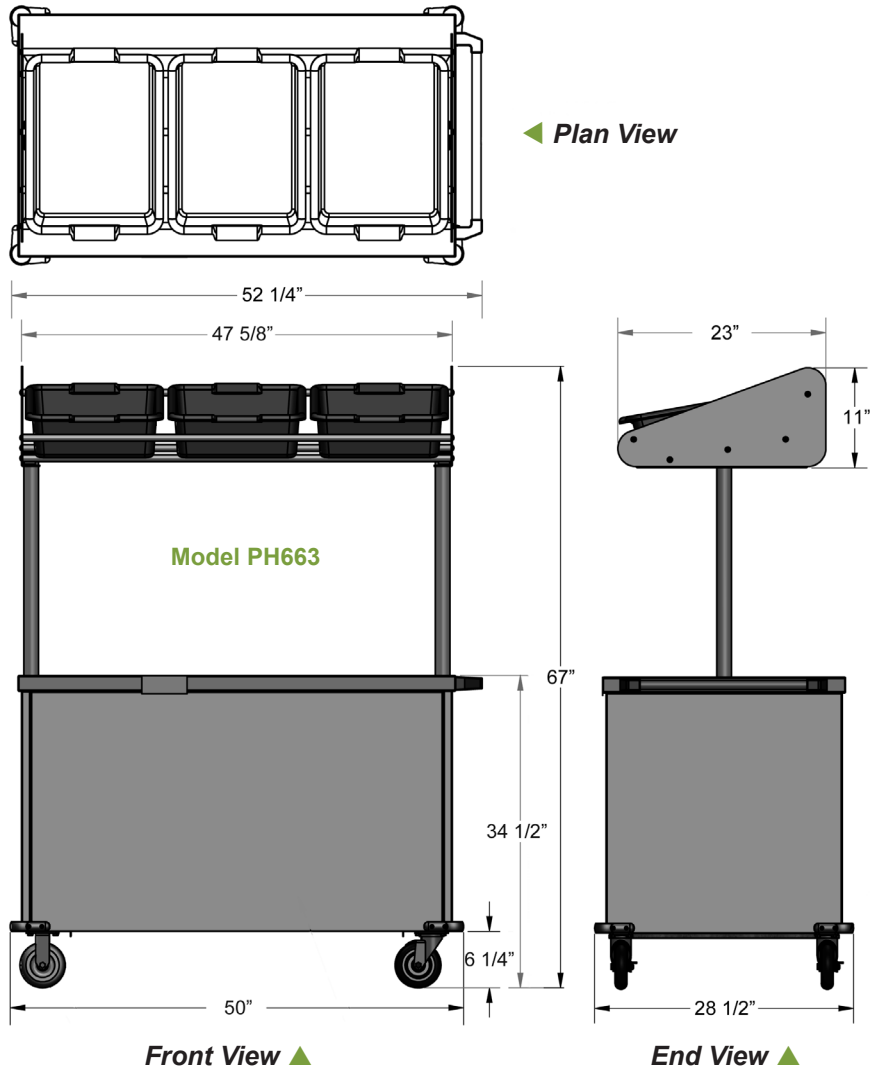

## Build Your Breakfast Cart

1 Base		2 Options	
Base Model	Front Panel		
<input type="checkbox"/> PH663	Stainless Steel	<input type="checkbox"/> Full stainless steel ice bin (top)	
<input type="checkbox"/> PH663SH	Magnetic Graphic	<input type="checkbox"/> Magnetic graphic panel (Model PH663)	
		<input type="checkbox"/> Overhead LED light strip	
		<input type="checkbox"/> Rechargeable battery pack (for light strip)	

palmer HAMILTON

143 S. Jackson Street, Suite 1 • Elkhorn, WI 53121  
 Phone: 800-788-1028 • 262-723-8200 Fax: 262-723-5180 • www.palmerhamilton.com



# palmer HAMILTON

## BREAKFAST CART



Model PH668

### DESIGN FEATURES

- Welded easy-to-clean stainless steel construction
- Spacious interior storage compartment
- Height-adjustable overhead display/serving rack
- Large insulated stainless steel ice bin with drain
- 3 wicker storage baskets included
- Ergonomic vertical push handles
- Full-perimeter base bumper
- Magnetic graphic panel (Model PH663SH)
- Non-marking 5" casters, 2 swivel with brake and 2 rigid
- Made in U.S.A.

*Over for more information.*

# BREAKFAST CART

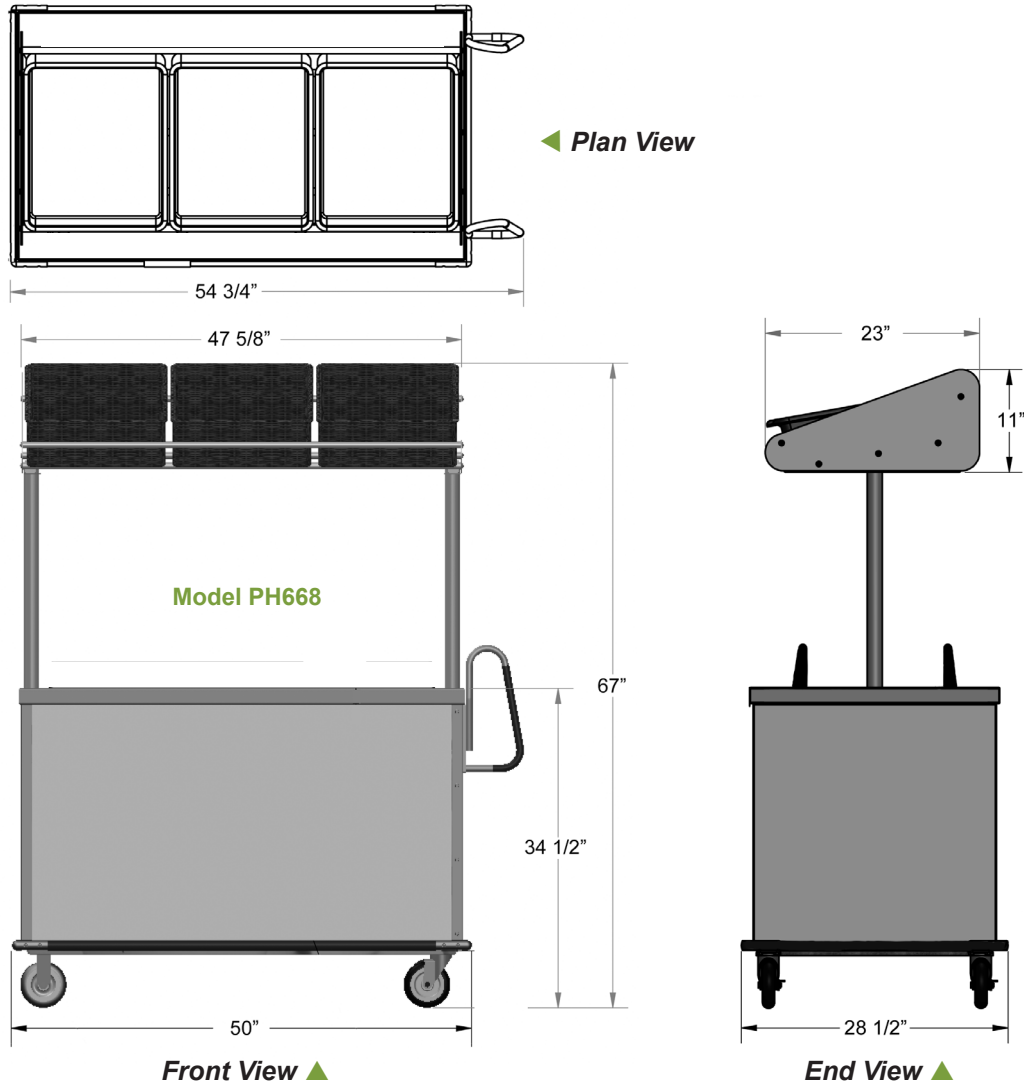

## Build Your Breakfast Cart

### 1 Base Finish

- Walnut    Gray Sand    Light Maple
- Victorian Cherry    Beige Suede
- Hard Rock Maple    Red Maple
- Royal Blue    Purple    Black
- Red    Green

### 2 Options

- Magnetic front graphic panel
- Interior stainless pull-out shelf
- 18" laminate drop leaf (end)
- Overhead lighting
- Rechargeable battery pack (for lighting)

## Standard Laminate Finishes

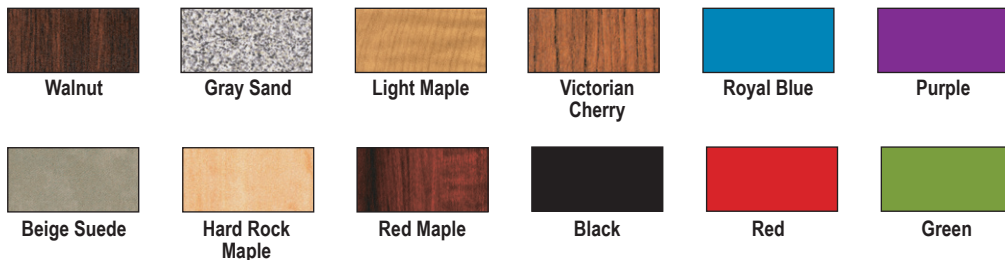

palmer HAMILTON

Custom Laminate Finishes Available

143 S. Jackson Street, Suite 1 • Elkhorn, WI 53121  
 Phone: 800-788-1028 • 262-723-8200 Fax: 262-723-5180 • www.palmerhamilton.com



# palmer HAMILTON

## COMPACT MART CART



Model PH660

### DESIGN FEATURES

- Welded easy-to-clean stainless steel construction
- Wide choice of laminate exterior finishes
- Spacious interior storage compartment
- Height-adjustable tilted overhead display/serving rack
- Durable solid stainless steel top with 2" edge on three sides
- Slide-out removable stainless steel interior shelf
- Ergonomic vertical push handles
- Full-perimeter base bumper
- Non-marking 5" swivel cushion tread casters
- Made in U.S.A.

*Over for more information.*

# COMPACT MART CART

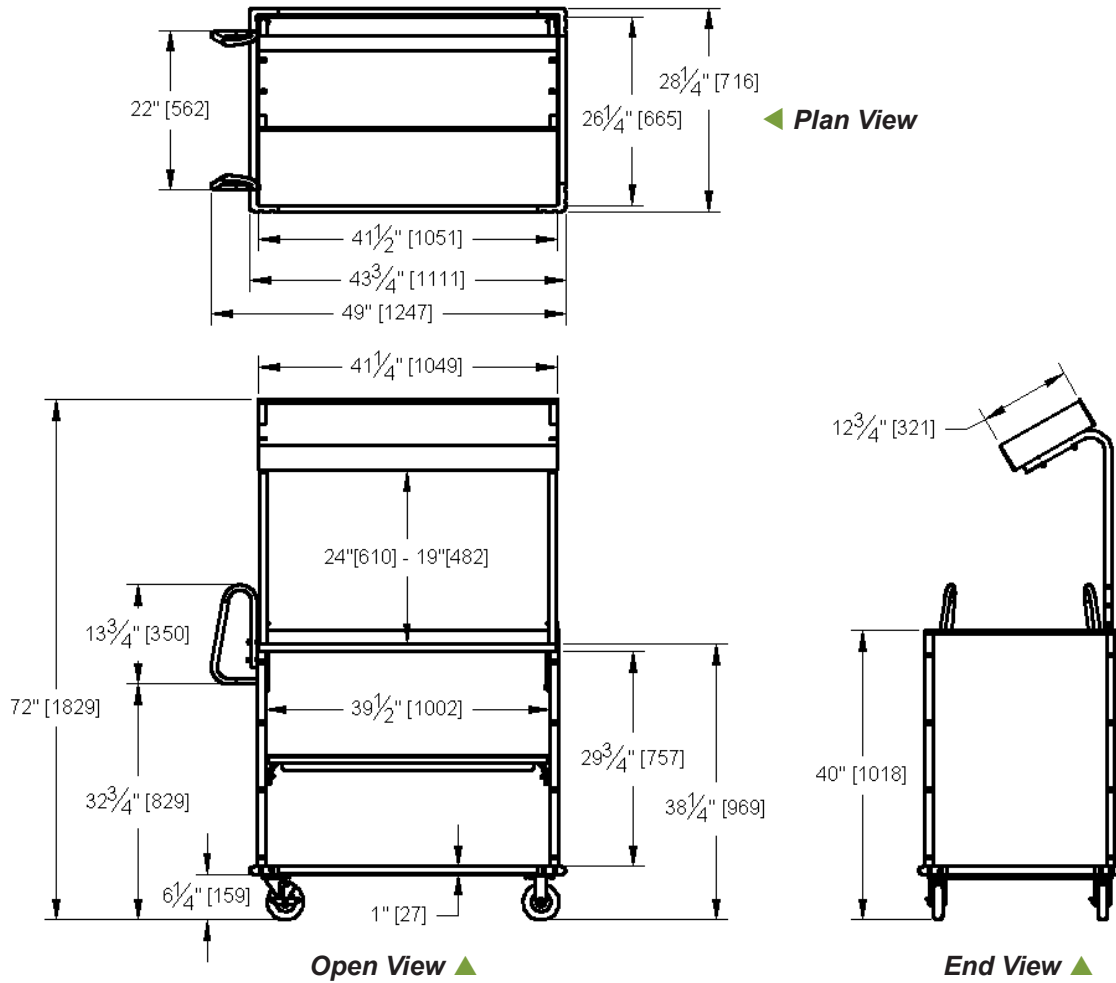

## Build Your Mart Cart

### 1 Base Finish

- Walnut
- Gray Sand
- Light Maple
- Victorian Cherry
- Beige Suede
- Hard Rock Maple
- Red Maple
- Royal Blue
- Purple
- Black
- Red
- Green

### 2 Options

- Cup dispenser
- Locking cash drawer
- Graphic front panel

## Standard Laminate Finishes

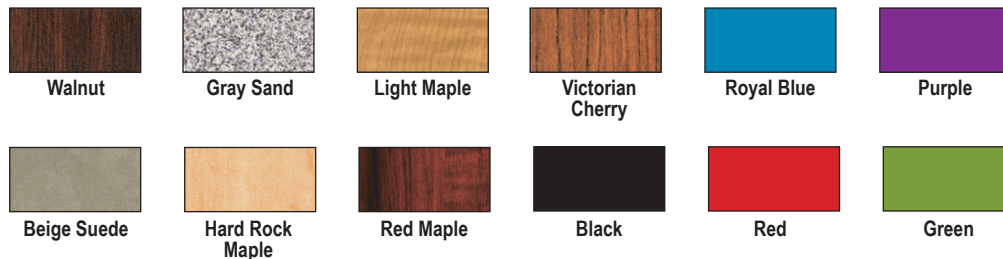

Custom Laminate Finishes Available

palmer HAMILTON

143 S. Jackson Street, Suite 1 • Elkhorn, WI 53121  
 Phone: 800-788-1028 • 262-723-8200 Fax: 262-723-5180 • www.palmerhamilton.com



# palmer HAMILTON

## MODULAR CASHIER COUNTER

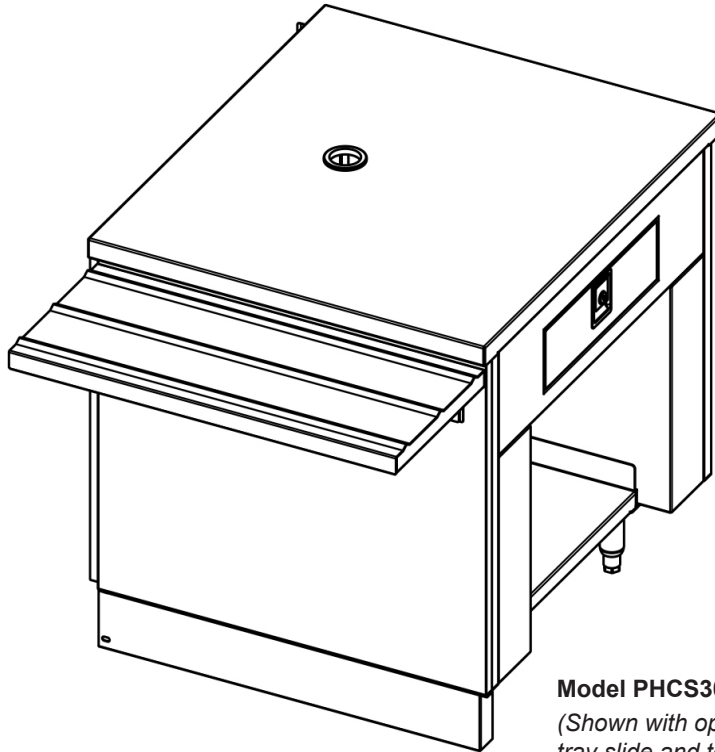

**Model PHCS30**  
*(Shown with optional  
tray slide and toe plate)*

### DESIGN FEATURES

- Durable, welded 300 series stainless steel square tubular frame
- Optional patented TIGHT LINK™ interlocking mechanism available to eliminate vertical and horizontal gaps between counters
- Counter tops in 14-gauge stainless steel, solid surface, or quartz
- Base exteriors in stainless steel or decorative laminate
- Grommeted top cord passage
- Locking cash drawer with removable compartment tray
- Duplex 120VAC receptacle and empty data box
- 8' power cord
- 6" high stainless steel adjustable legs or 5" swivel casters
- UL listed, electrical and sanitation
- Made in U.S.A.





# MODULAR CASHIER STATION

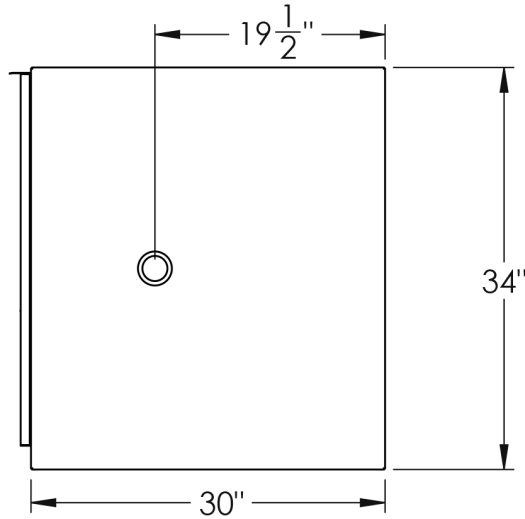

Plan View ▲

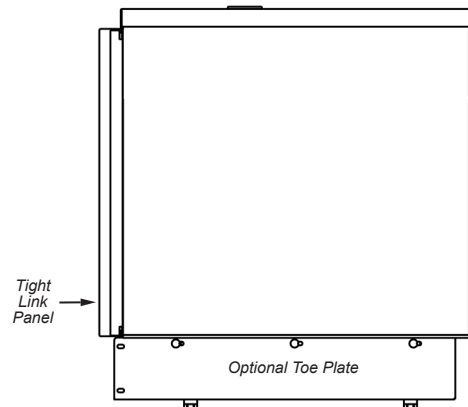

Front View ▲

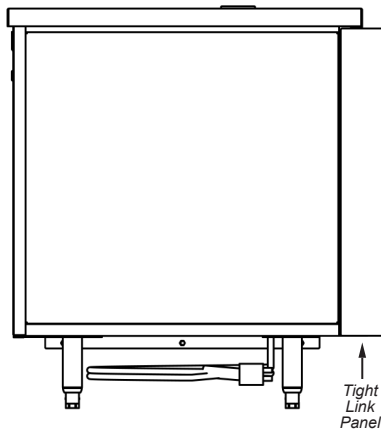

Operator View ▲

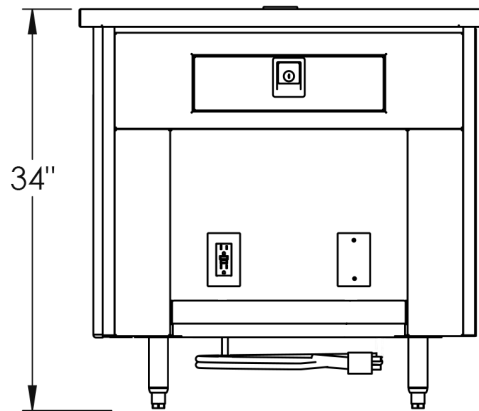

End View ▲

Model PHCS30

## Build Your Counter

### 1 Base Length

Base Length	Model	Base Length	Model
<input type="checkbox"/> 28"	PHCS28	<input type="checkbox"/> 42"	PHCS42
<input type="checkbox"/> 30"	PHCS30	<input type="checkbox"/> 54"	PHCS54

### 2 Base Panel

- Stainless steel    Laminate

### 3 Base Options

- Stainless steel toe plate  
 TIGHT LINK™ interlocking mechanism

### Base Options (continued)

- Custom vinyl graphic  
 5" swivel casters    6" legs  
 2nd cash drawer (PHCS-54)

### 4 Counter Top Material

- 14-gauge stainless    Corian® solid surface  
 Zodiaq® quartz

### 5 Tray Slide

- Left    Right    End  
 Flat stainless steel    V-ridge stainless steel  
 Corian solid surface    Zodiaq quartz

palmer HAMILTON

143 S. Jackson Street, Suite 1 • Elkhorn, WI 53121  
 Phone: 800-788-1028 • 262-723-8200 Fax: 262-723-5180 • www.palmerhamilton.com



Made In U.S.A.



# palmer HAMILTON

## MODULAR CORNER UTILITY COUNTER

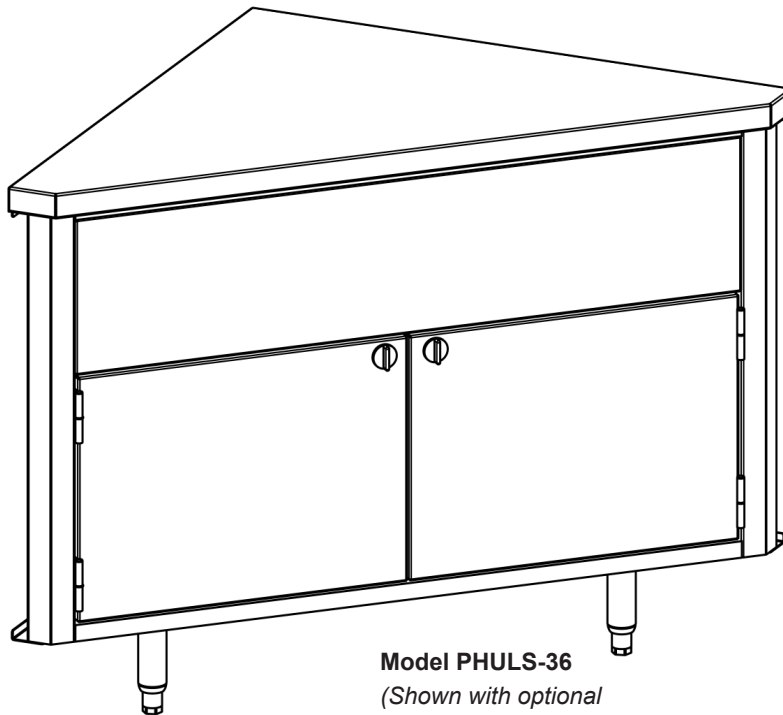

**Model PHULS-36**  
*(Shown with optional  
hinged doors)*

### DESIGN FEATURES

- Durable, welded 300 series stainless steel square tubular frame
- Counter tops in 14-gauge stainless steel, solid surface, or quartz
- Base exteriors in stainless steel or decorative laminate
- Optional patented TIGHT LINK™ interlocking mechanism available to eliminate vertical and horizontal gaps between counter sections
- 6" high stainless steel adjustable legs or 5" swivel casters
- UL listed, electrical and sanitation
- Made in U.S.A.



# MODULAR CORNER UTILITY COUNTER

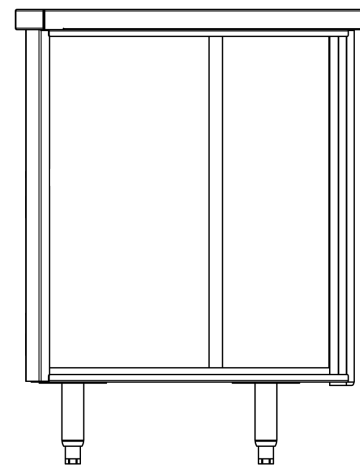
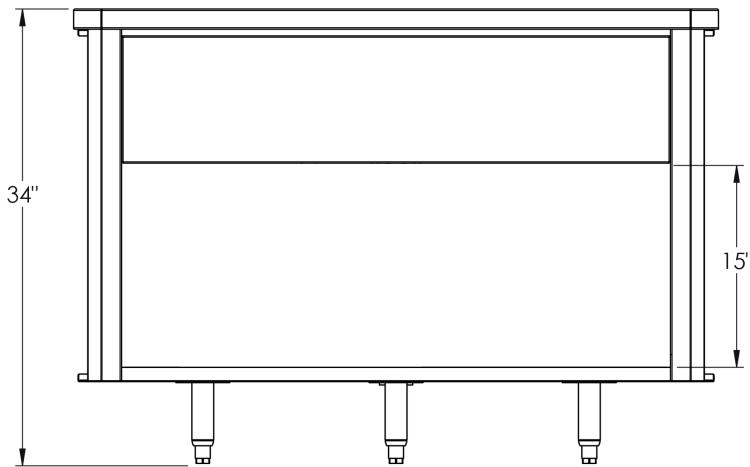
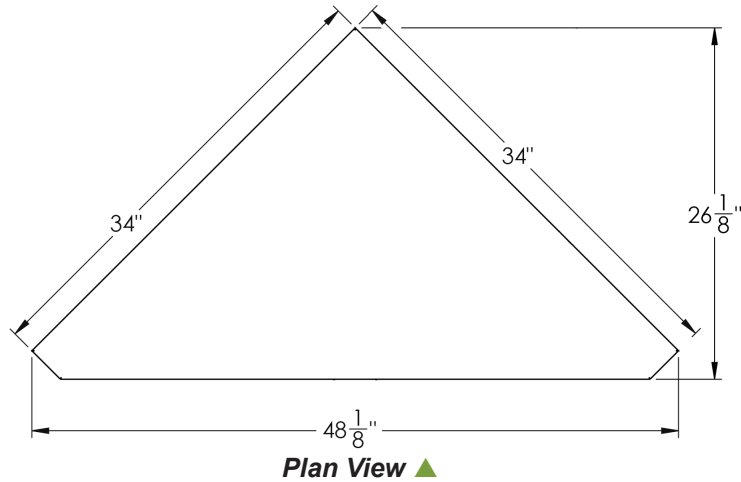

Model PHULS36

## Build Your Counter

### 1 Base Panel

- Stainless steel
- Laminate
- Hinged doors

### 2 Base Options

- Stainless steel toe plate
- TIGHT LINK™ interlocking mechanism
- Custom vinyl graphic
- 5" swivel casters
- 6" legs

### 3 Counter Top Material

- 14-gauge stainless
- Corian® solid surface
- Zodiaq® quartz

### 4 Tray Slide

- Flat stainless steel
- V" ridge stainless steel
- Corian solid surface
- Zodiaq quartz

palmer HAMILTON

143 S. Jackson Street, Suite 1 • Elkhorn, WI 53121

Phone: 800-788-1028 • 262-723-8200 Fax: 262-723-5180 • www.palmerhamilton.com



Made In U.S.A.

# palmer HAMILTON

## MODULAR UTILITY COUNTERS

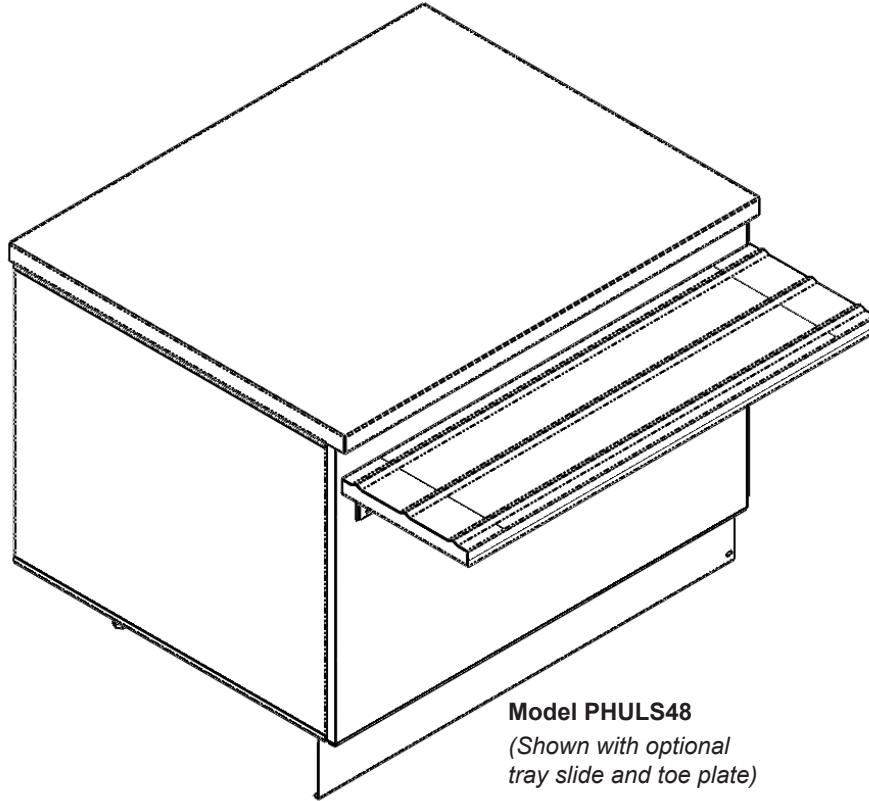

**Model PHULS48**  
*(Shown with optional  
tray slide and toe plate)*

### DESIGN FEATURES

- Durable, welded 300 series stainless steel square tubular frame
- Optional patented TIGHT LINK™ interlocking mechanism available to eliminate vertical and horizontal gaps between counters
- Interchangeable top configurations available
- Interchangeable laminate exterior panels match or complement any décor
- Interchangeable top configurations available
- 6" high stainless steel adjustable legs or 5" swivel casters



# MODULAR UTILITY COUNTERS

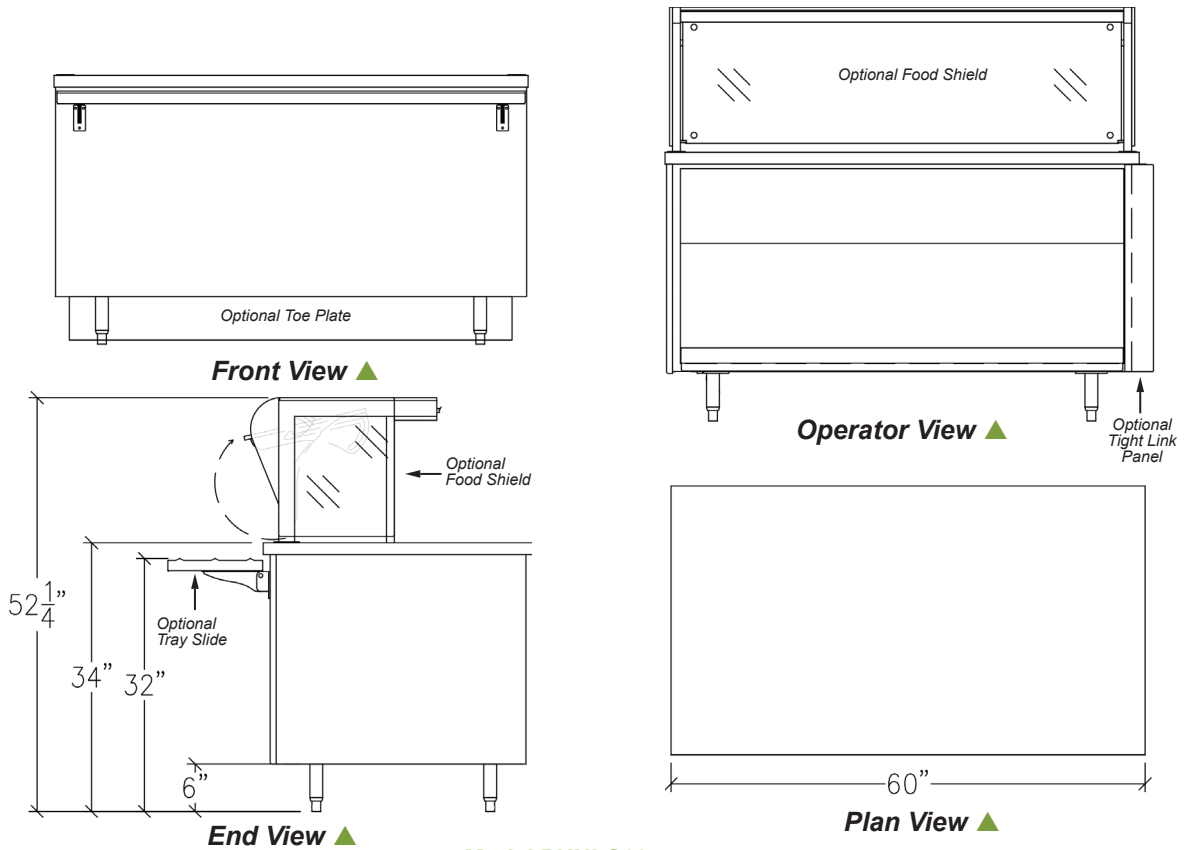

Model PHULS60

## Build Your Counter

### 1 Base Length

Base Length	Well Equiv.	Model	Base Length	Well Equiv.	Model
<input type="checkbox"/> 36"	2	PHULS36	<input type="checkbox"/> 66"	4	PHULS66
<input type="checkbox"/> 48"	2	PHULS48	<input type="checkbox"/> 72"	4	PHULS72
<input type="checkbox"/> 54"	3	PHULS54	<input type="checkbox"/> 84"	5	PHULS84
<input type="checkbox"/> 60"	3	PHULS60	<input type="checkbox"/> 96"	6	PHULS96

### 2 Base Type

- Single-sided  Island

### 3 Base Panel

- Front/back (each)  End

Material:  Stainless steel  Laminate

### 4 Food Shields

- Single-sided convertible  
 Double-sided convertible (Island base)

### 5 Base Options

- Stainless steel toe plate(s)  
 TIGHT LINK™ interlocking mechanism  
 Custom vinyl graphic  
 5" swivel casters  6" legs

### 6 Counter Top Material

- 14-gauge stainless  Corian® solid surface  
 Zodiaq® quartz

### 7 Tray Slides

- Single  Double (island base)  
 Flat stainless steel  V" ridge stainless steel  
 Corian solid surface  Zodiaq quartz

### 8 Drop-Ins

- Hot well  Cold well (NSF7)  
 Hot/cold convertible (Specify # of wells \_\_\_\_)  
 Heat lamp

### 9 Canopies

- Arched canopy  
 Arched canopy w/lighted digital menu board  
*(Monitor not included.)*  
 Awning  Pergola

### 10 Electrical Load Center

- Yes *(Specify location in line-up)*  
 No

palmer HAMILTON

143 S. Jackson Street, Suite 1 • Elkhorn, WI 53121

Phone: 800-788-1028 • 262-723-8200 Fax: 262-723-5180 • www.palmerhamilton.com



Made In U.S.A.