

**ESPORTS** Environments

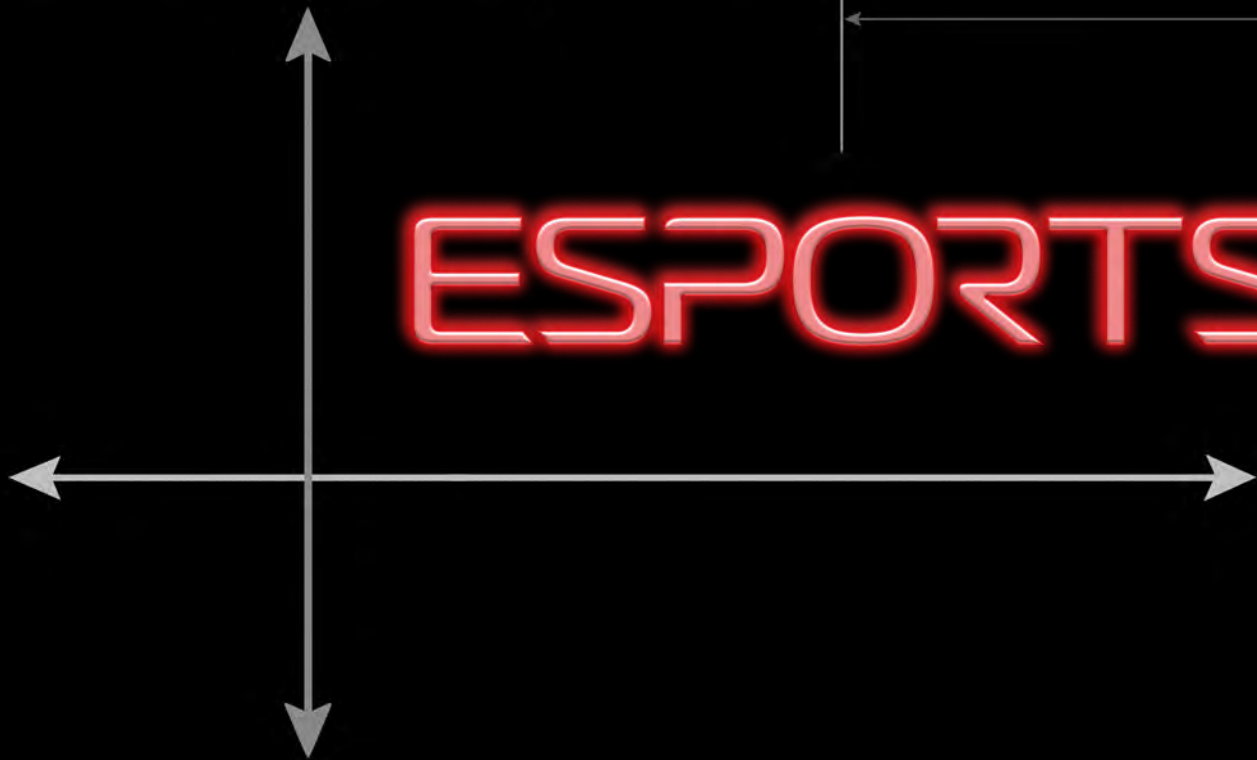

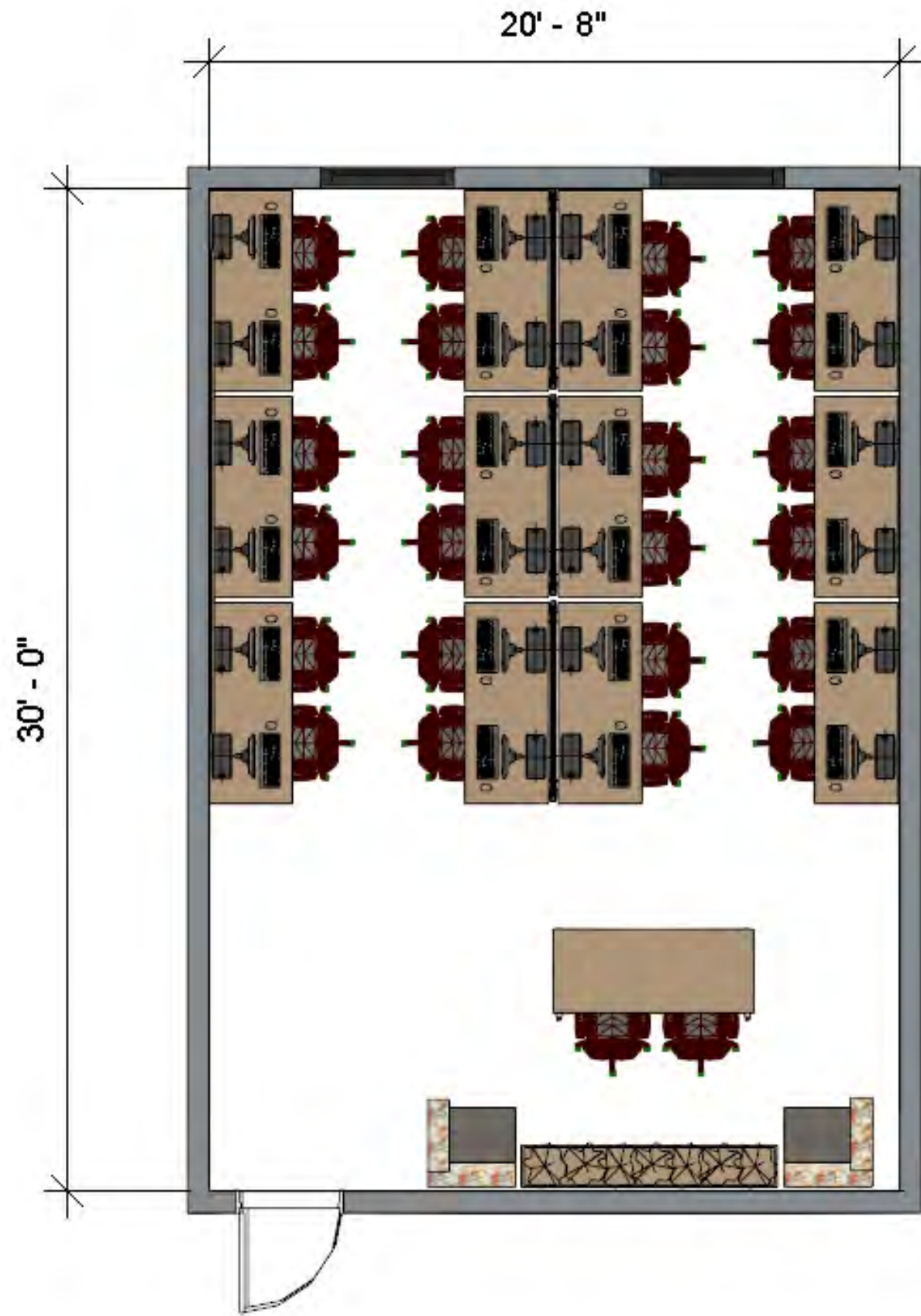

**CONCEPT #1**

**CAPACITY SHOWN: 28**



**NOTE:** Layout is not ADA compliant. School is responsible to indicate if additional ADA spots are required.





**CONCEPT #1 – Color Scheme 1**



**Synergy Table**  
Laminate Top: WA Palisades Oak  
End Panels: WA Palisades Oak or Logo  
EdgeGuard: Black  
Frame: Black  
\*Qty 1 w/modesty panel & locking casters



**Alternate Table Option**  
**RESPAWN 1048 Gaming Desk**  
Finish: Black  
31.5"D x 47.2"W  
Wire Management Included  
\*note; total seating capacity may change if using this table



**Hive Lounge Chairs**  
Upholstered Back & Arm: CF Stinson – Polygon, Party  
Upholstered Seat: CF Stinson – Tessuto, Palazzo  
Leg Base



**RESPAWN 110 Gaming Chair**  
Racing Style High Back  
360 Swivel  
Integrated Headrest  
135 Degree Recline with Adjustable Tilt  
Tension & Angle Lock  
Gray Fabric



**CONCEPT #1 – Color Scheme 2**



**Synergy Table**  
Laminate Top: WA Palisades Oak  
End Panels: WA Palisades Oak or Logo  
EdgeGuard: Black  
Frame: Red  
\*Qty 1 w/modesty panel & locking casters



**Alternate Table Option**  
**RESPAWN 1048 Gaming Desk**  
Finish: Black  
31.5"D x 47.2"W  
Wire Management Included  
\*note; total seating capacity may change if using this table

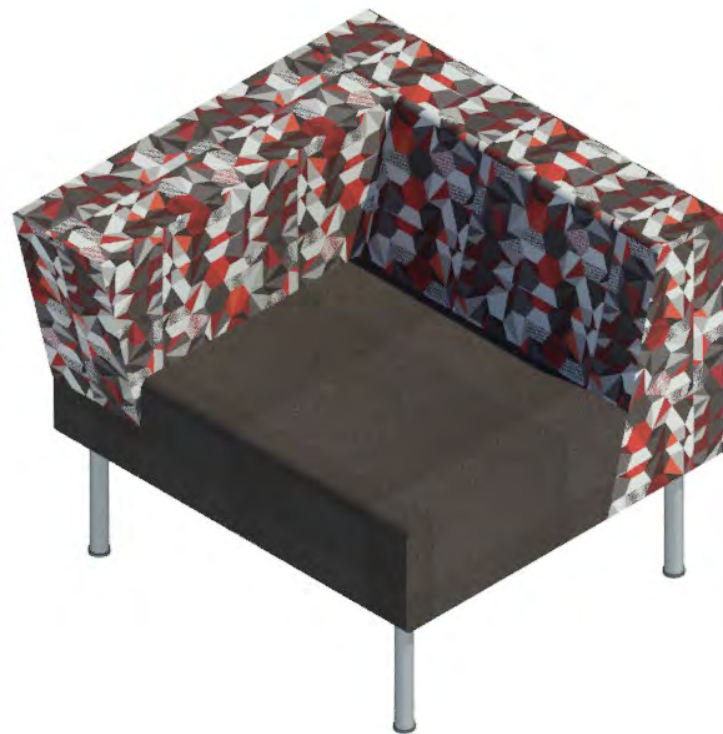

**Hive Lounge Chairs**  
Upholstered Back & Arm: CF  
Stinson – Polygon, Party  
Upholstered Seat: CF Stinson  
– Tessuto, Palazzo  
Leg Base



**RESPAWN 110 Gaming Chair**  
Racing Style High Back  
360 Swivel  
Integrated Headrest  
135 Degree Recline with Adjustable Tilt  
Tension & Angle Lock  
Gray Fabric





**CONCEPT #1 – Optional Add-on Pieces**



**Go Panels 60H x 72W**  
 Laminate: WA Palisades Oak  
 Frame: Silver  
 Windows: with graphics, varies

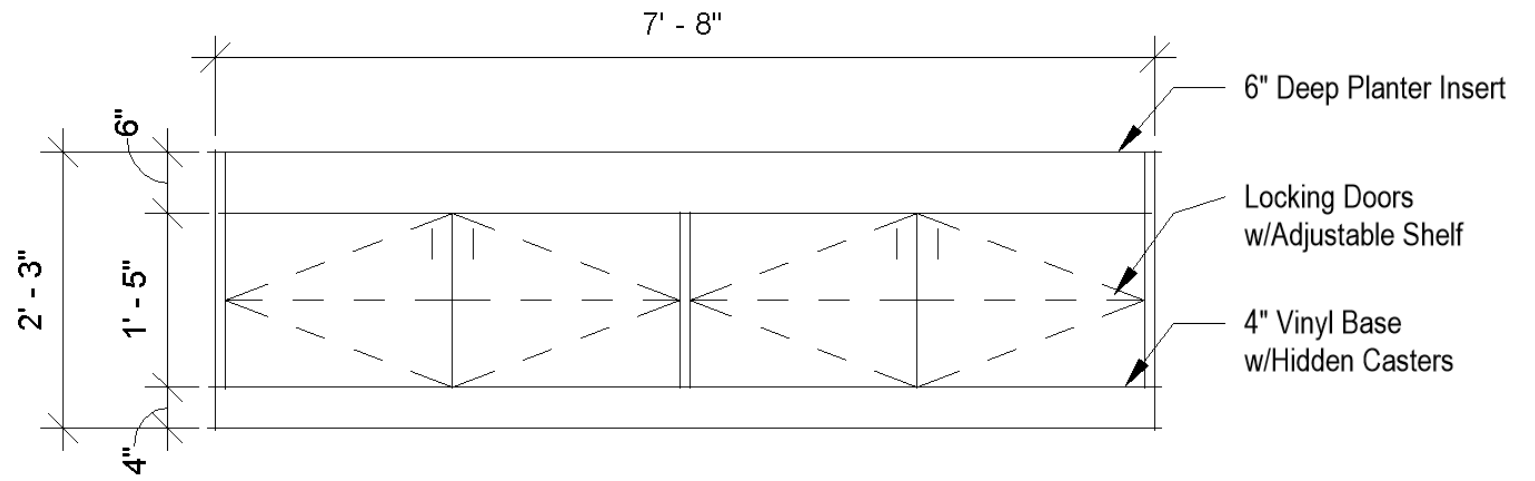

**DE2 – Custom Storage Planter**  
 Laminate: WA Palisades Oak  
 Black Vinyl Base  
 Hidden Casters  
 Overall Size: 7'8"W x 2'3"H x 1'3"D

**18" Grass Bush (Qty. 4)**  
 AR-110370  
 12" Width  
 Bare Stem  
 Tutone Green



**27" Aglaonema Plant (Qty. 3)**  
 PR-556  
 24" Leaves  
 19" Approx. Width  
 Bare Stem  
 Tutone Green/Grey





**CONCEPT #1 – FINISHES**

**Color Scheme 1**

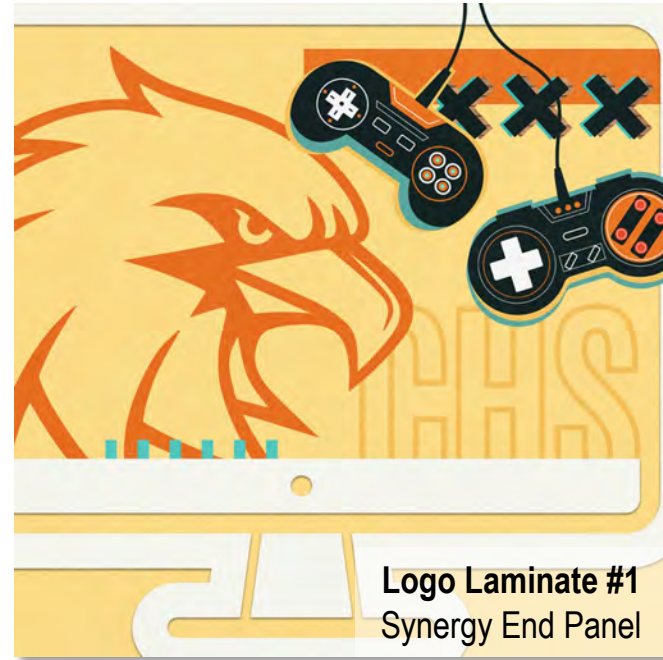
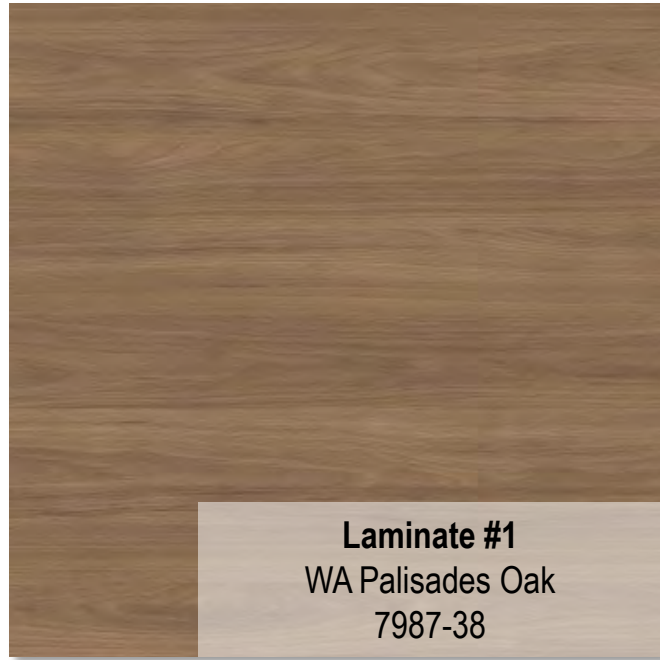

**CONCEPT #1 – FINISHES**

**Color Scheme 2**

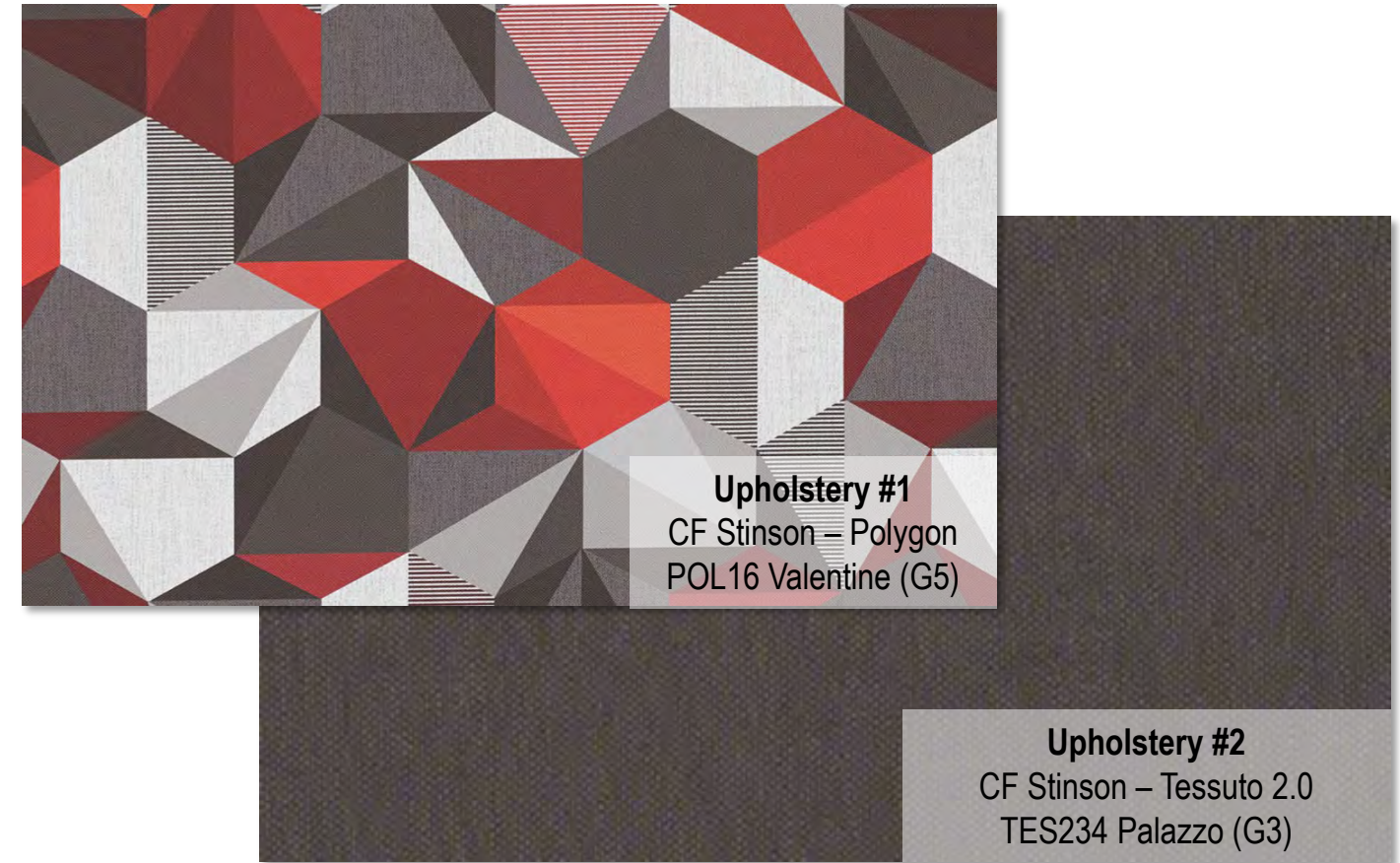
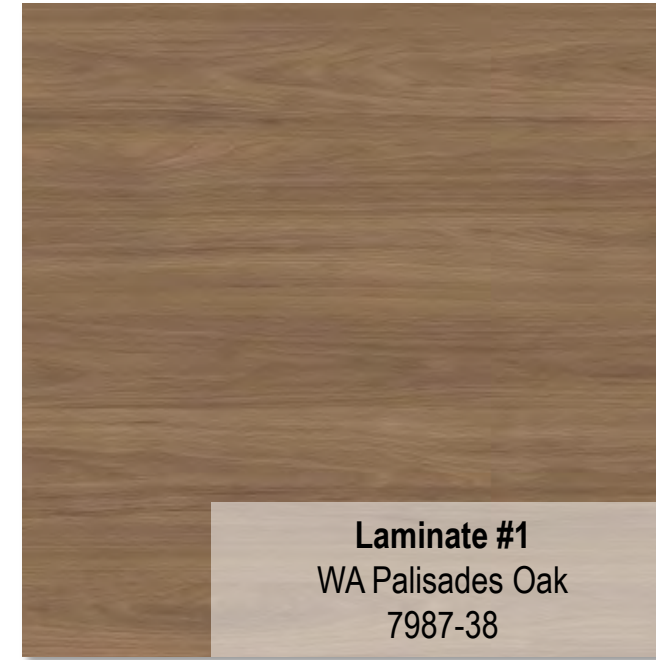



**ELEVATION PLAN – CONCEPT #1**

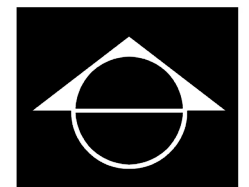
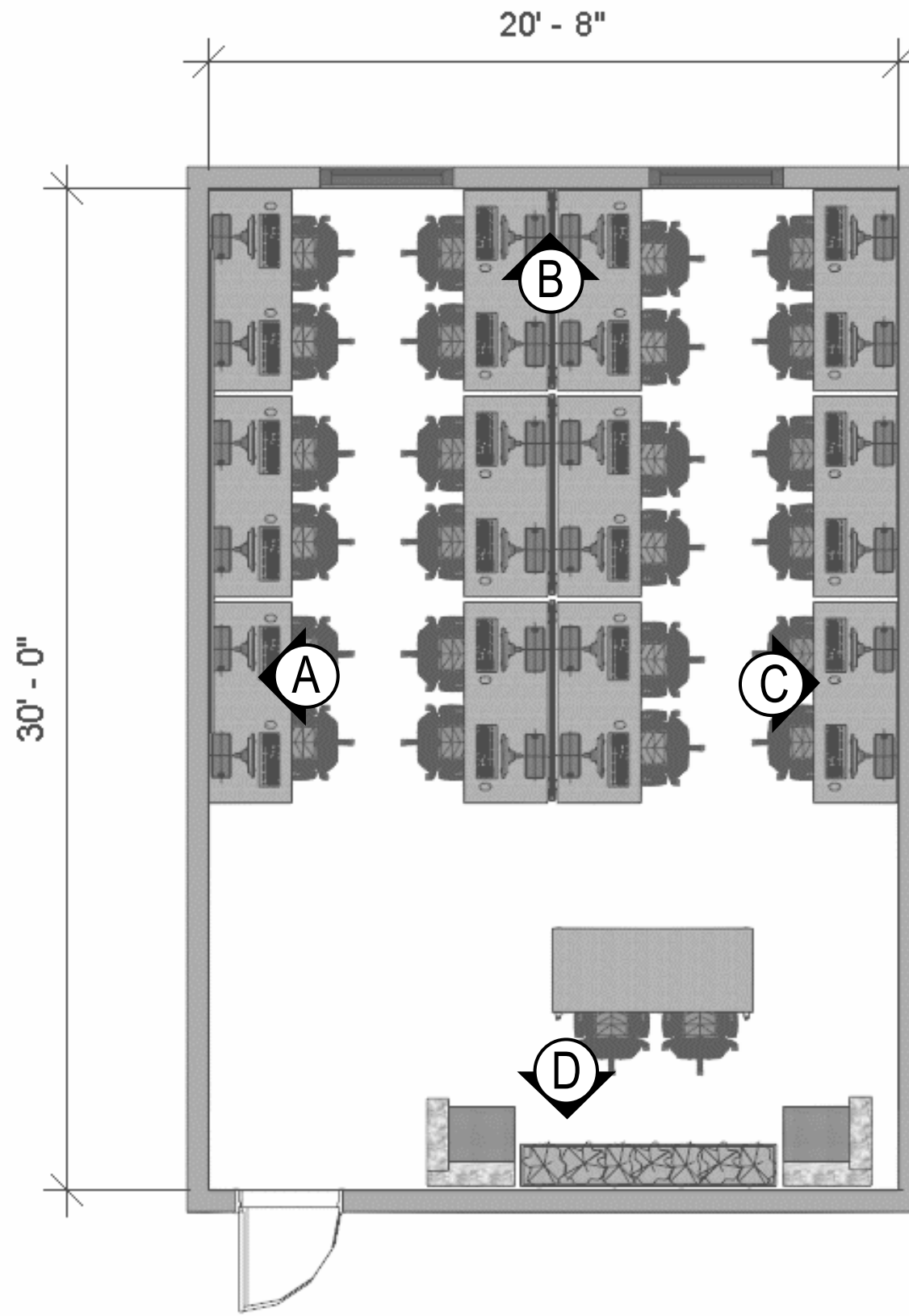

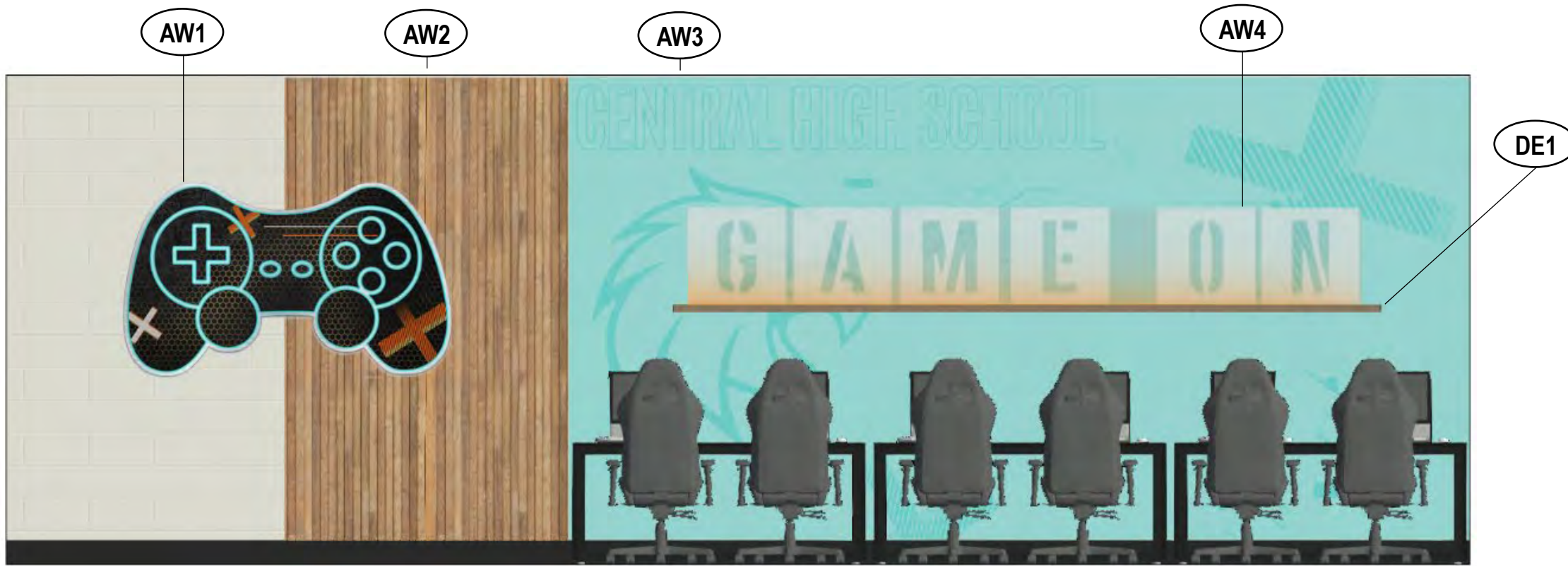

**A** INTERIOR ELEVATION A – CONCEPT #1, COLOR SCHEME #1  
Esports Environments



**B** INTERIOR ELEVATION B – CONCEPT #1, COLOR SCHEME #1  
Esports Environments

NOTE: School is responsible to remove unwanted wall-hung items and patch walls prior to painting.





**C** INTERIOR ELEVATION C – CONCEPT #1, COLOR SCHEME #1  
Esports Environments

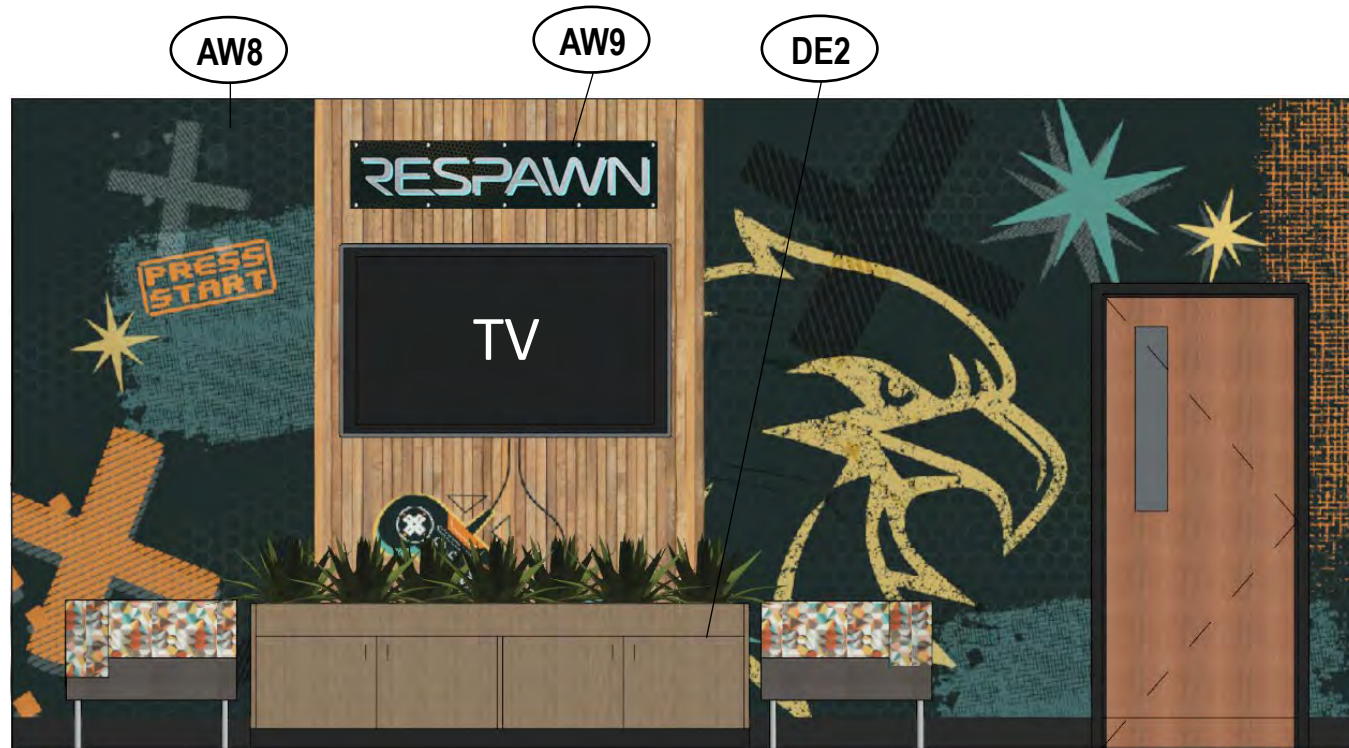

**D** INTERIOR ELEVATION D – CONCEPT #1, COLOR SCHEME #1  
Esports Environments

NOTE: School is responsible to remove unwanted wall-hung items and patch walls prior to painting.



**CONCEPT 1 - COLOR SCHEME #1**

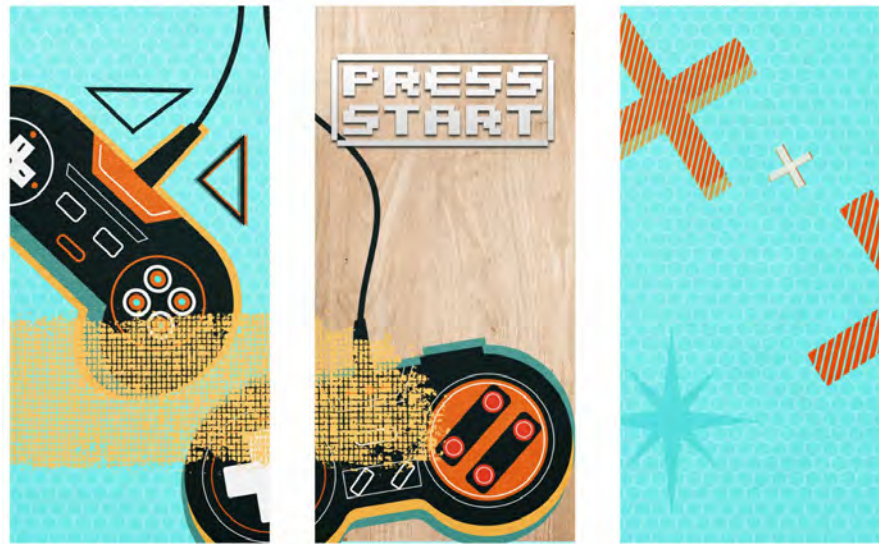

**AW7** – 6mm Black PVC

**GAME ROOM**

**AW6** – 6mm Black PVC



**AW9** – Silver Dibond

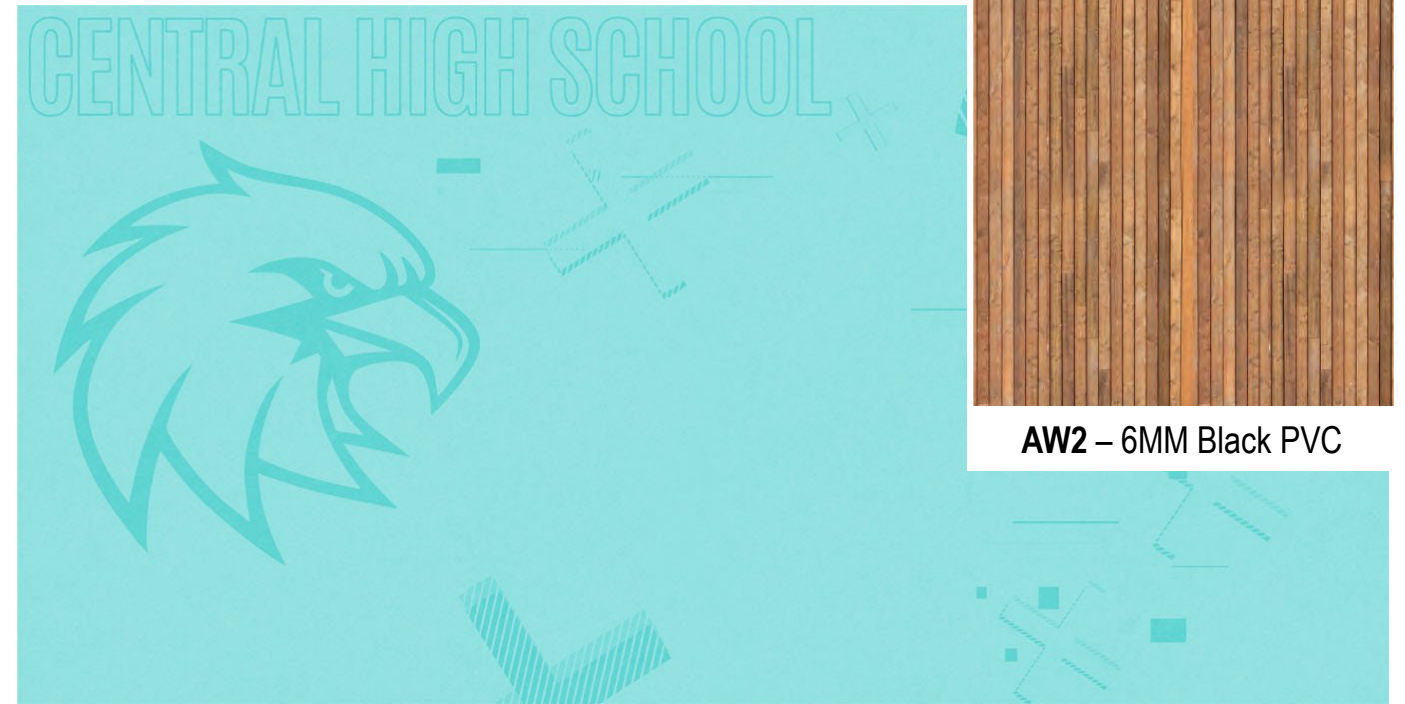

**AW2** – 6MM Black PVC



**AW4** – Cut to Shape Acrylic Letters on DE1 Wood Ledge Housing LED



**AW5** – Silver Dibond LED



**AW1** – Silver Dibond

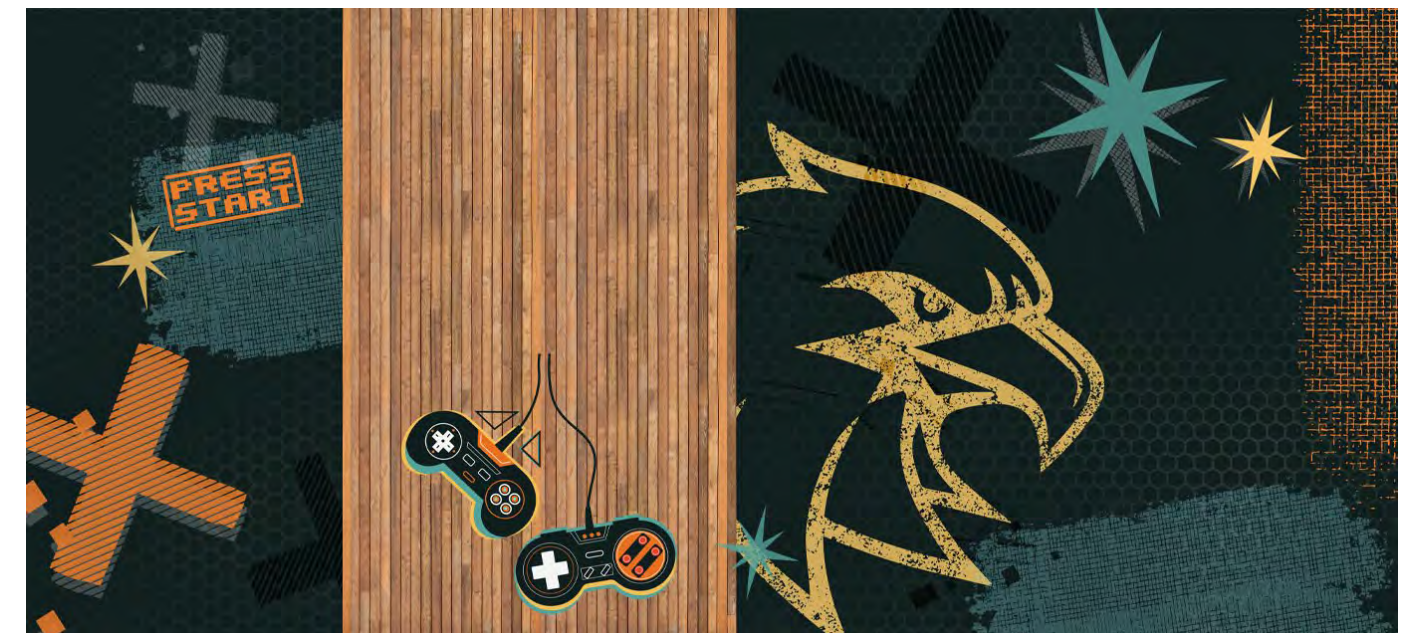

**AW8** - Roughwall

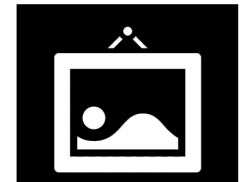







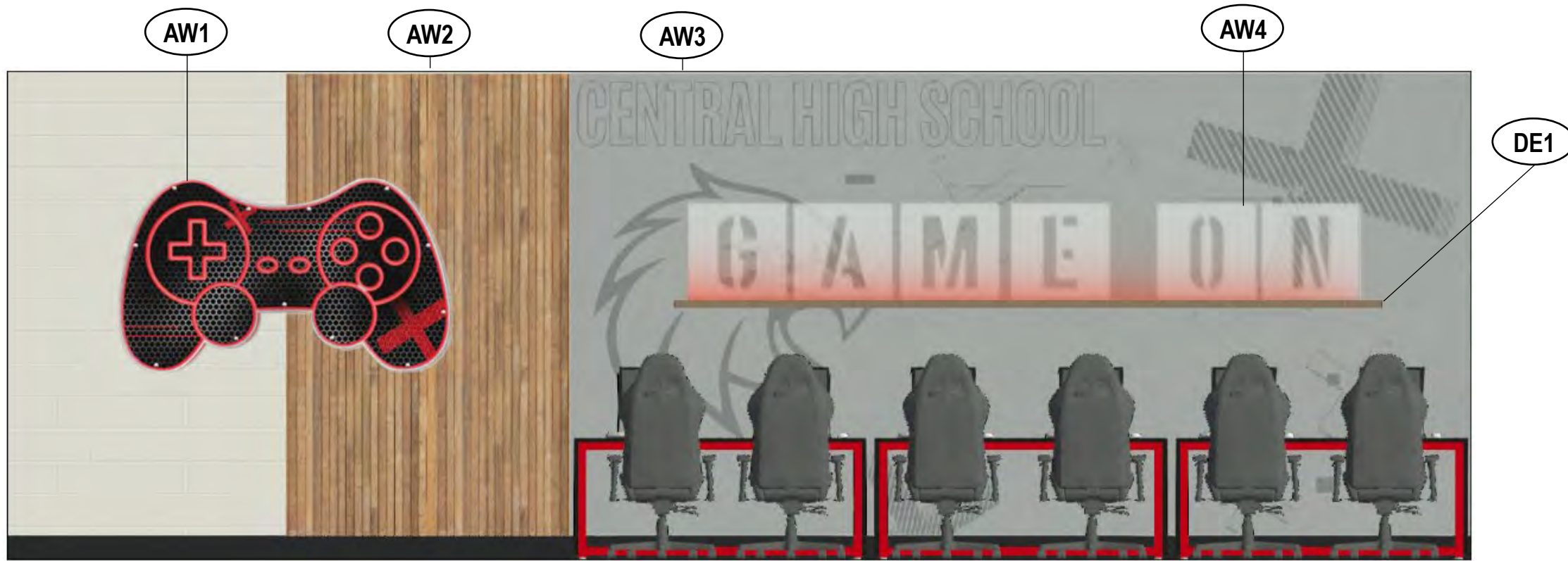

**A** INTERIOR ELEVATION A – CONCEPT #1, COLOR SCHEME #2  
Esports Environments



**B** INTERIOR ELEVATION B – CONCEPT #1, COLOR SCHEME #2  
Esports Environments

NOTE: School is responsible to remove unwanted wall-hung items and patch walls prior to painting.



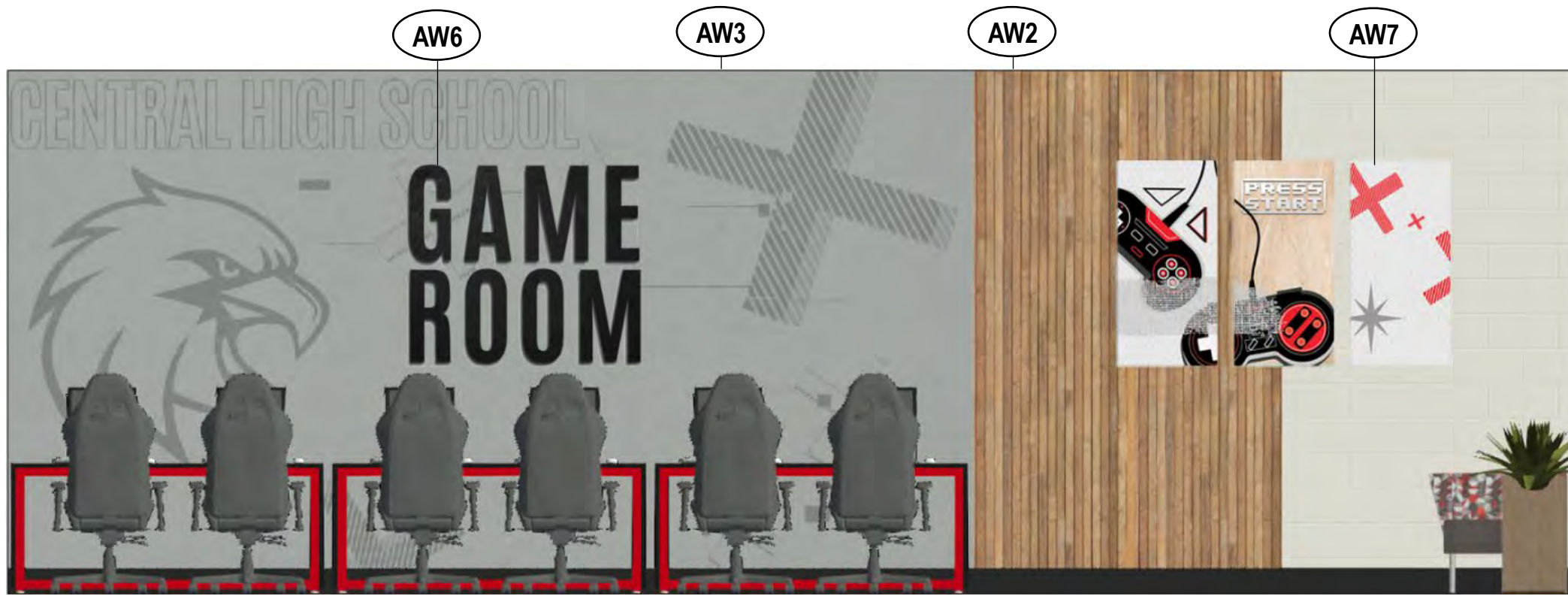

**C** INTERIOR ELEVATION C – CONCEPT #1, COLOR SCHEME #2  
Esports Environments

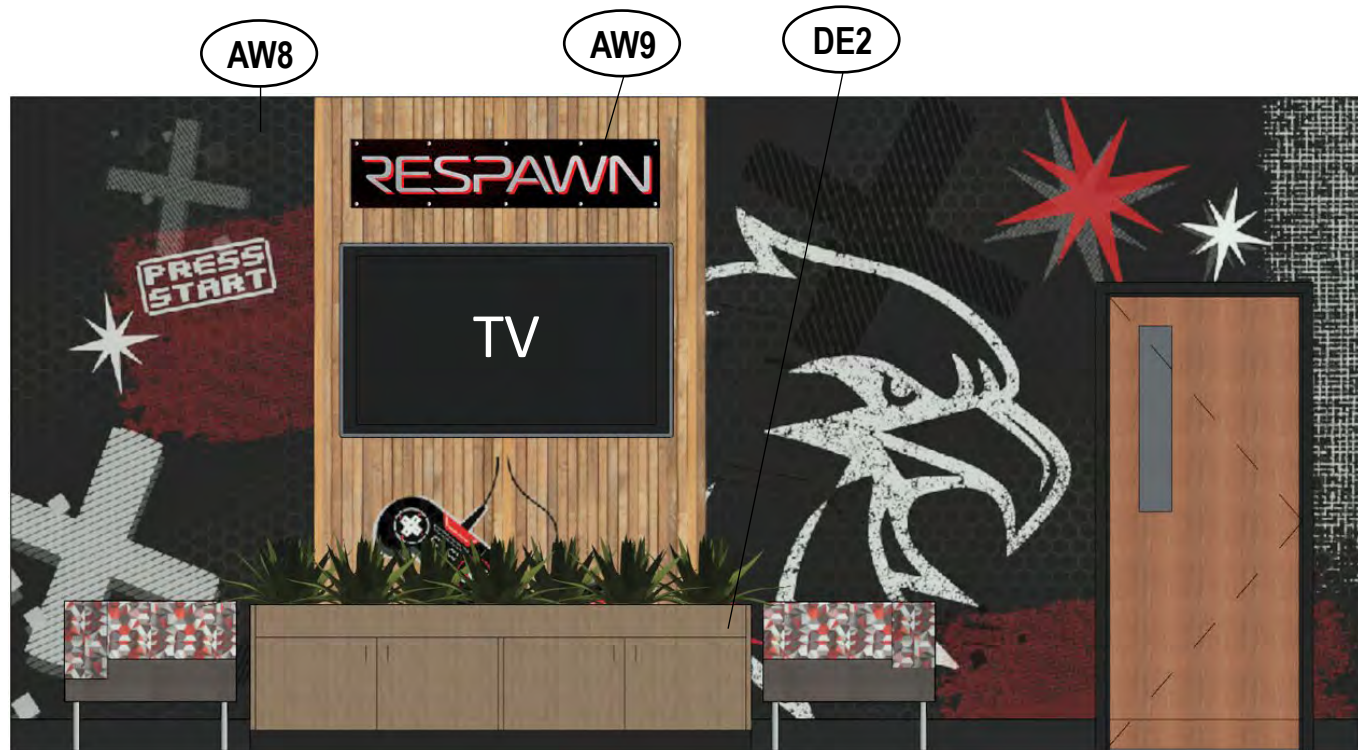

**D** INTERIOR ELEVATION D – CONCEPT #1, COLOR SCHEME #2  
Esports Environments

NOTE: School is responsible to remove unwanted wall-hung items and patch walls prior to painting.



**CONCEPT 1 - COLOR SCHEME #2**



**AW7** – 6mm Black PVC

**GAME ROOM**

**AW6** – 6mm Black PVC



**AW9** – Silver Dibond



**AW2** – 6MM Black PVC



**AW4** – Cut to Shape Acrylic Letters on DE1 Wood Ledge Housing LED

**AW3** - Roughwall



**AW5** – Silver Dibond LED



**AW1** – Silver Dibond

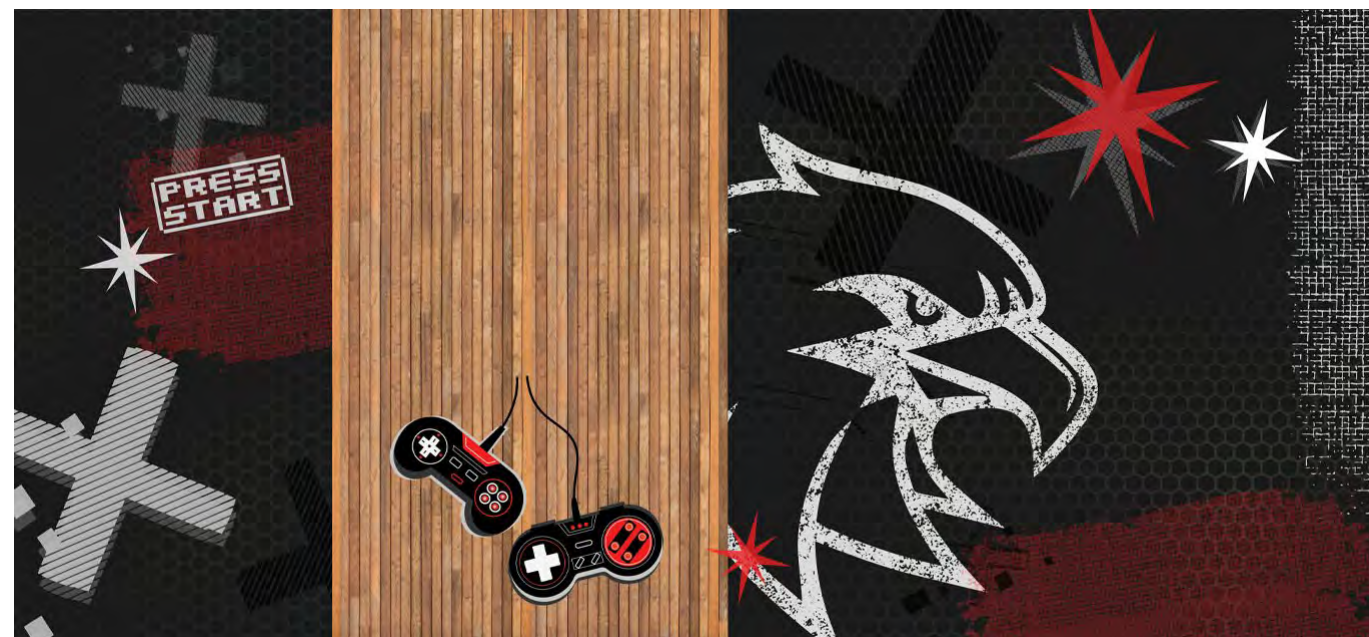

**AW8** - Roughwall

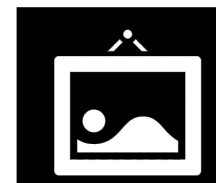







**OPTIONAL CEILING TREATMENTS**

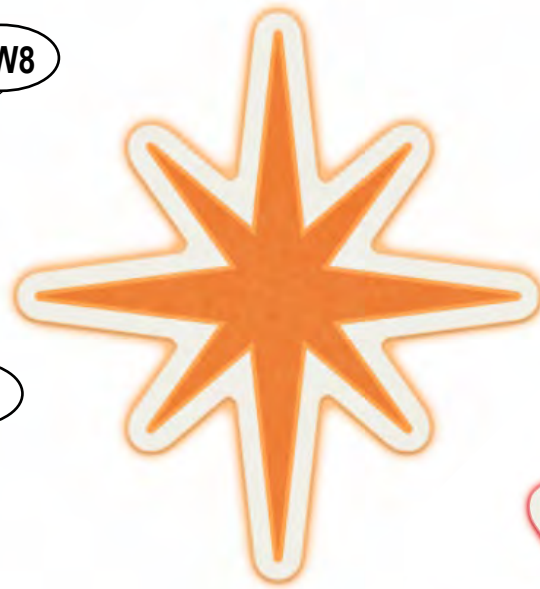
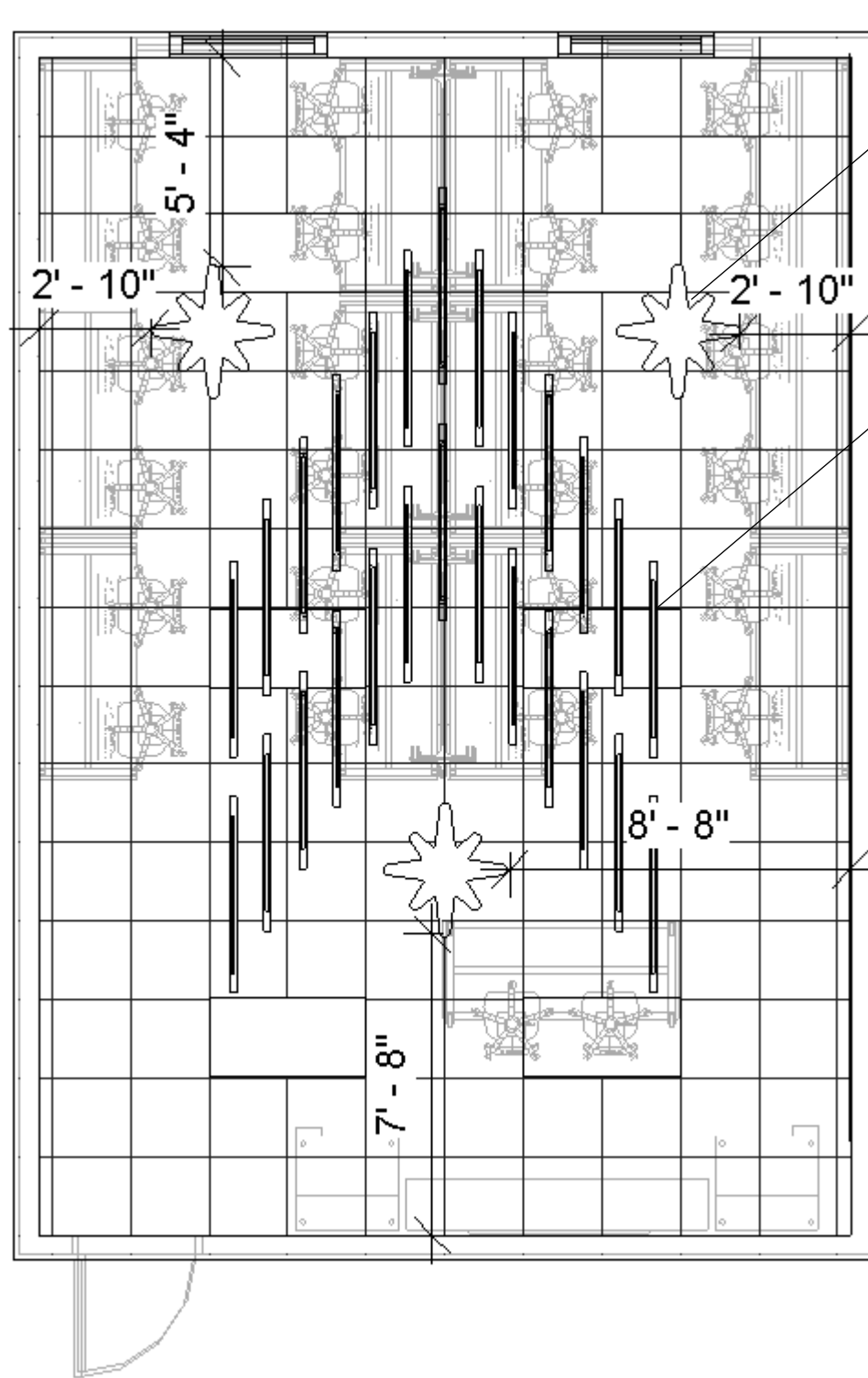

**AW8 (Qty. 3)**  
 Direct Print on 3mm White Maxmetal  
 Cut to Shape  
 Ceiling Hung w/Aircraft Cable  
 Overall Size: 37"W x 42"H

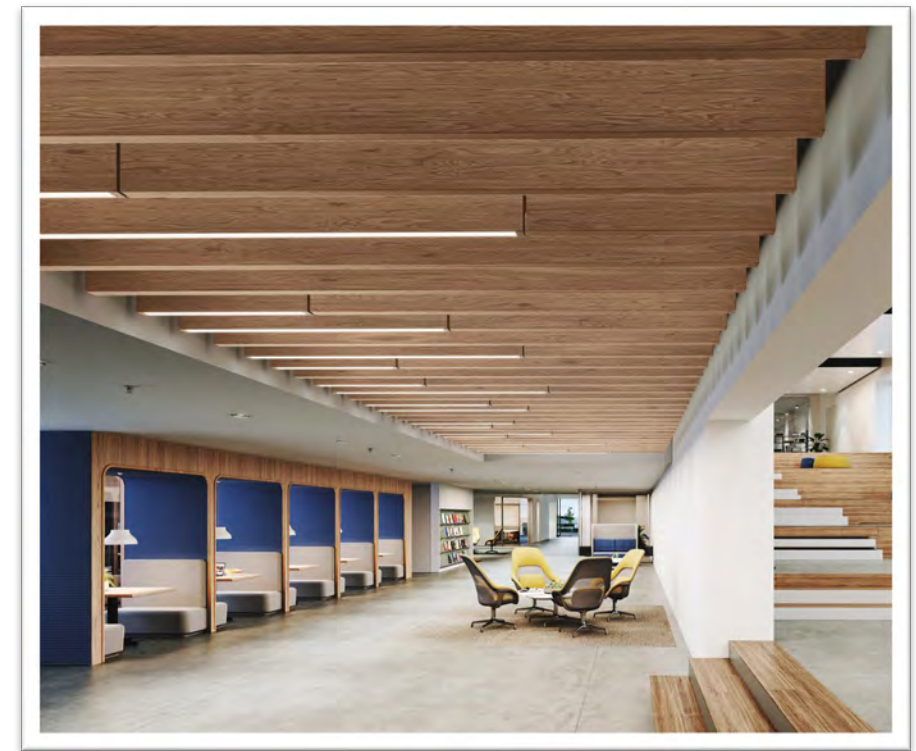

**DE3 –Acoustics**  
**Beam LED**  
 Finish: Planked Oak  
 Qty. 26

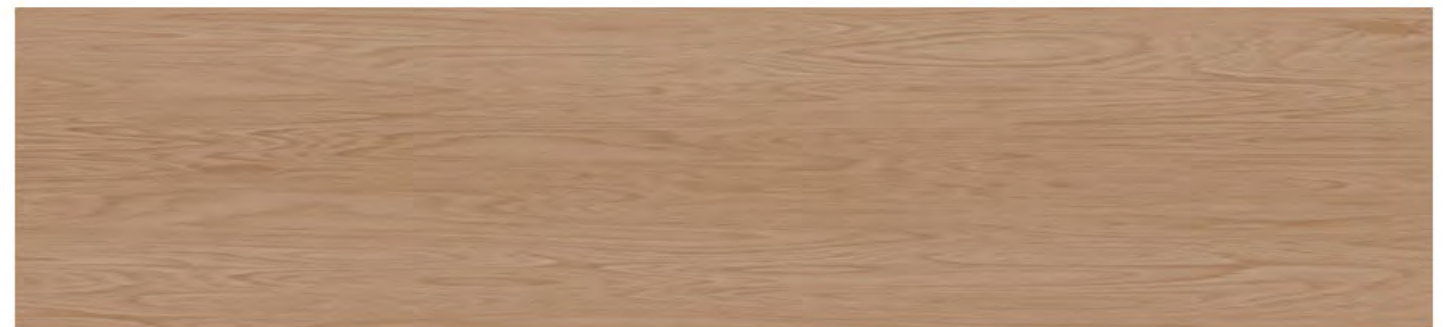
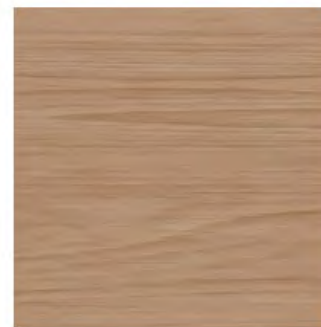



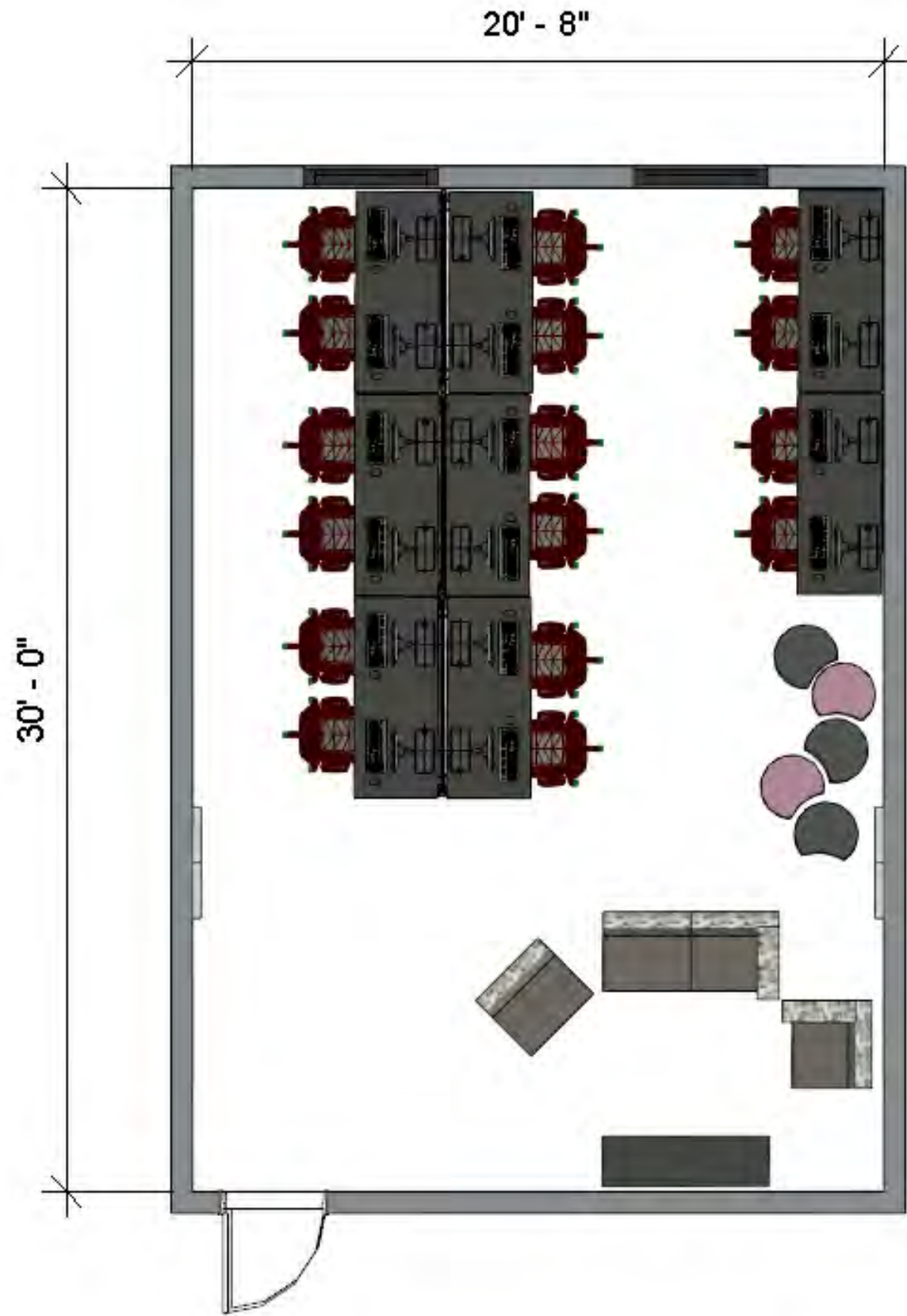

**CONCEPT #2**

**CAPACITY SHOWN: 24**



**NOTE:** Layout is not ADA compliant. School is responsible to indicate if additional ADA spots are required.





**CONCEPT #2 – Color Scheme 1**



**RESPAWN 110 Gaming Chair**  
 Racing Style High Back  
 360 Swivel  
 Integrated Headrest  
 135 Degree Recline with Adjustable Tilt  
 Tension & Angle Lock  
 Gray

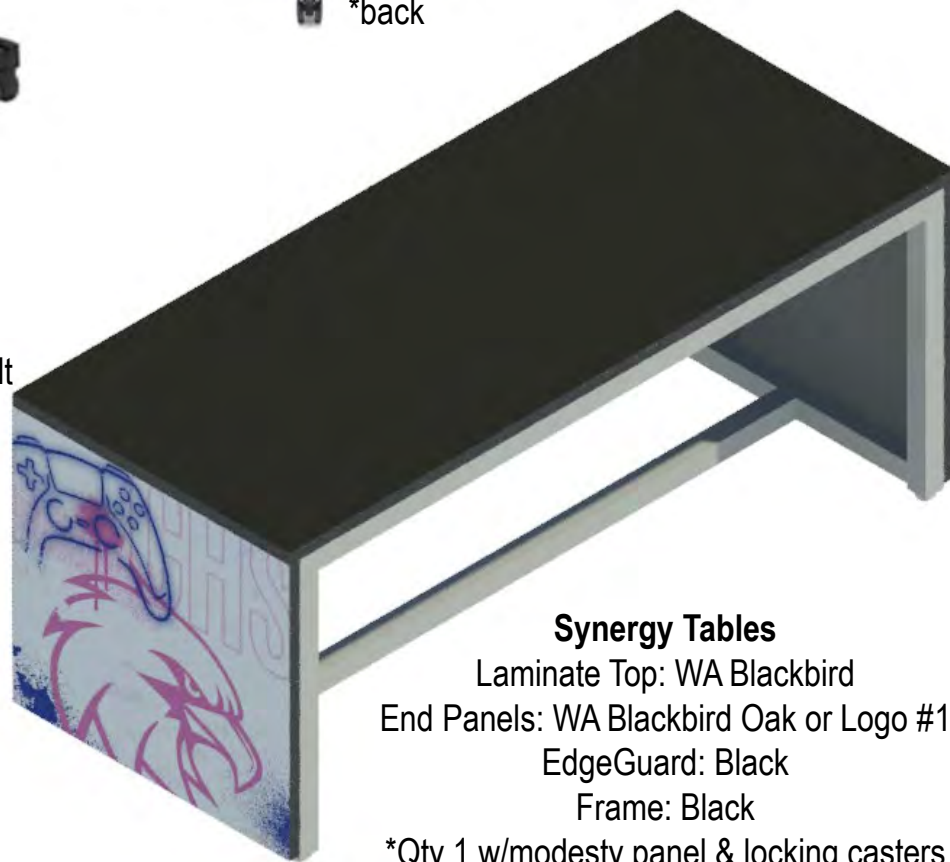

**Synergy Tables**  
 Laminate Top: WA Blackbird  
 End Panels: WA Blackbird Oak or Logo #1  
 EdgeGuard: Black  
 Frame: Black  
 \*Qty 1 w/modesty panel & locking casters

**CONCEPT #2 –Color Scheme 2**



**RESPAWN 110 Gaming Chair**  
 Racing Style High Back  
 360 Swivel  
 Integrated Headrest  
 135 Degree Recline with Adjustable Tilt  
 Tension & Angle Lock  
 Gray



**Synergy Tables**  
 Laminate Top: WA Blackbird  
 End Panels: WA Blackbird Oak or Logo #1  
 EdgeGuard: Black  
 Frame: Black  
 \*Qty 1 w/modesty panel & locking casters





**CONCEPT #2 – Additional Pieces**



**Go Panels 60H x 72W**  
Laminate: Varies  
Windows: with graphics, varies



Grey to show Transparency



Grey to show Transparency



**Alternate Lounge Option**  
**RESPAWN 900 Recliner**

Upholstered: Black  
\*note; total seating capacity may change if using this option



**Hive Lounge Chairs**  
**(Both Color Schemes)**  
Upholstered Back & Arm: CF  
Stinson – Chaos - Spin  
Upholstered Seat: CF  
Stinson – Tessuto, Palazzo  
Leg Base



**Daisy Petals**

Upholstery: CF Stinson  
Amplify – Various Colors  
Casters



**Aero Table – Flat T Base**  
**16”H**

Laminate Top: WA Blackbird  
EdgeGuard: Black  
Frame: Black





**CONCEPT #2 – FINISHES**

**Color Scheme 1**

**CONCEPT #2 – FINISHES**

**Color Scheme 2**

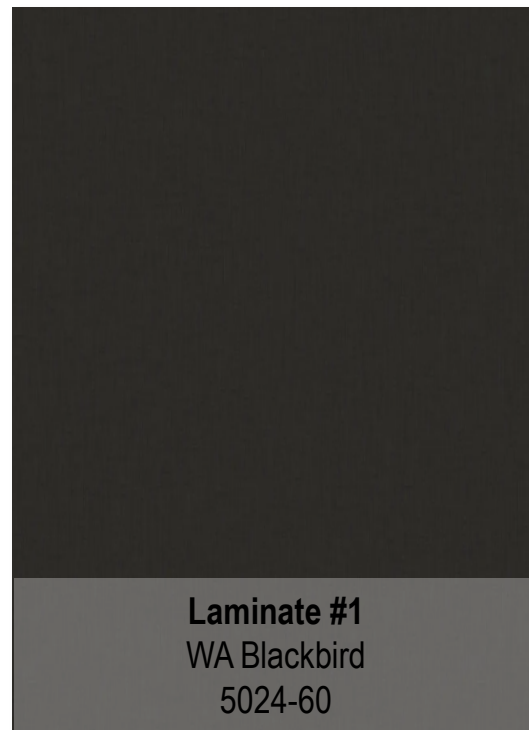

**Laminate #1**  
WA Blackbird  
5024-60



**Logo Laminate #1**  
Synergy End Panel



**Logo Laminate #2**  
Synergy End Panel

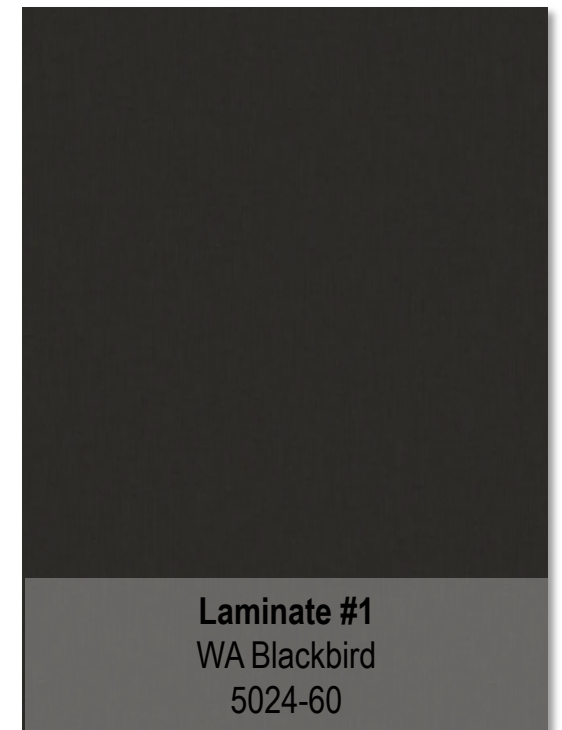

**Laminate #1**  
WA Blackbird  
5024-60

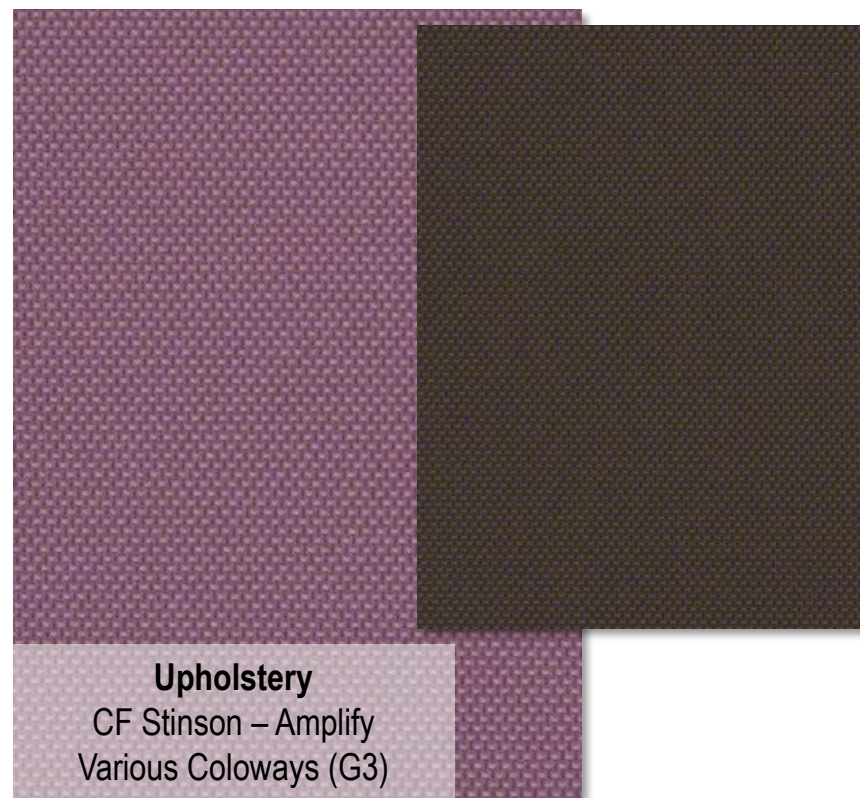

**Upholstery**  
CF Stinson – Amplify  
Various Coloways (G3)

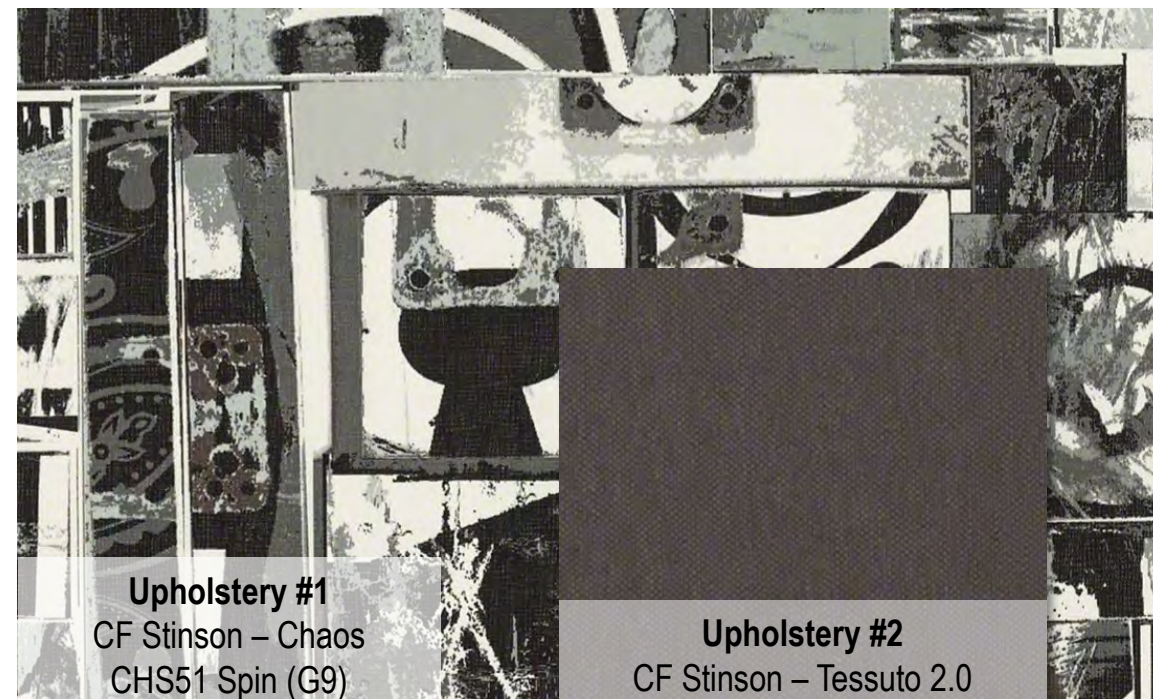

**Upholstery #1**  
CF Stinson – Chaos  
CHS51 Spin (G9)

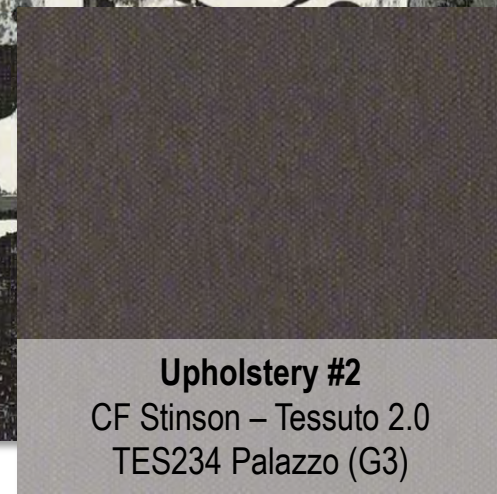

**Upholstery #2**  
CF Stinson – Tessuto 2.0  
TES234 Palazzo (G3)

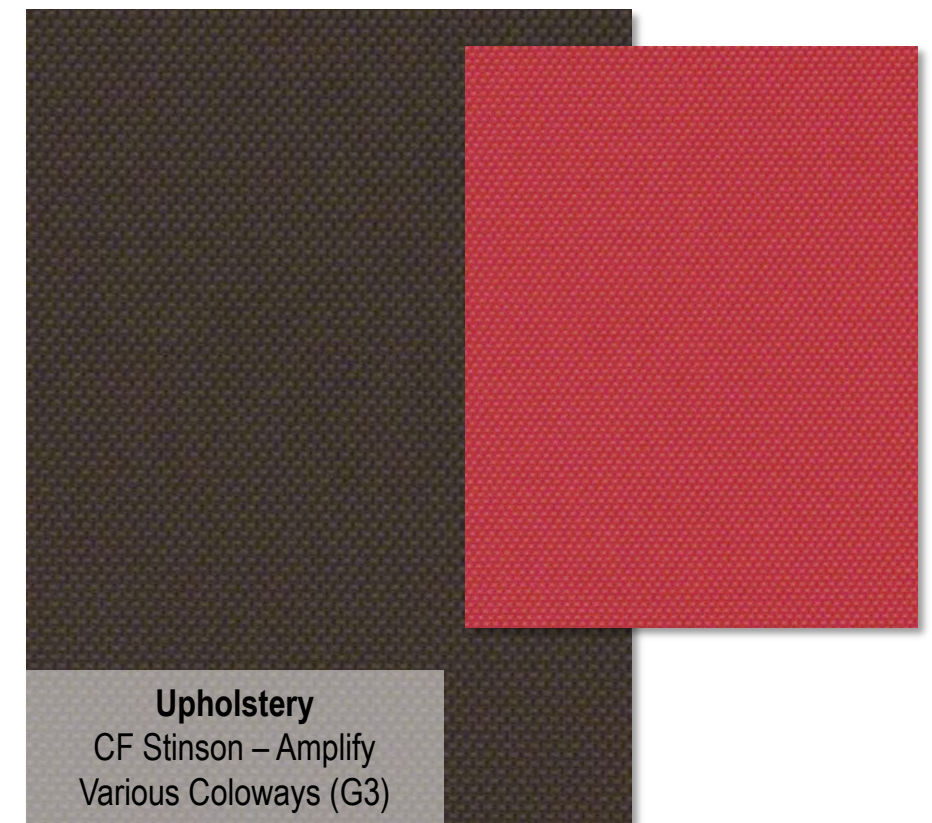

**Upholstery**  
CF Stinson – Amplify  
Various Coloways (G3)



**ELEVATION PLAN – CONCEPT #2**

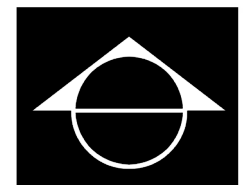
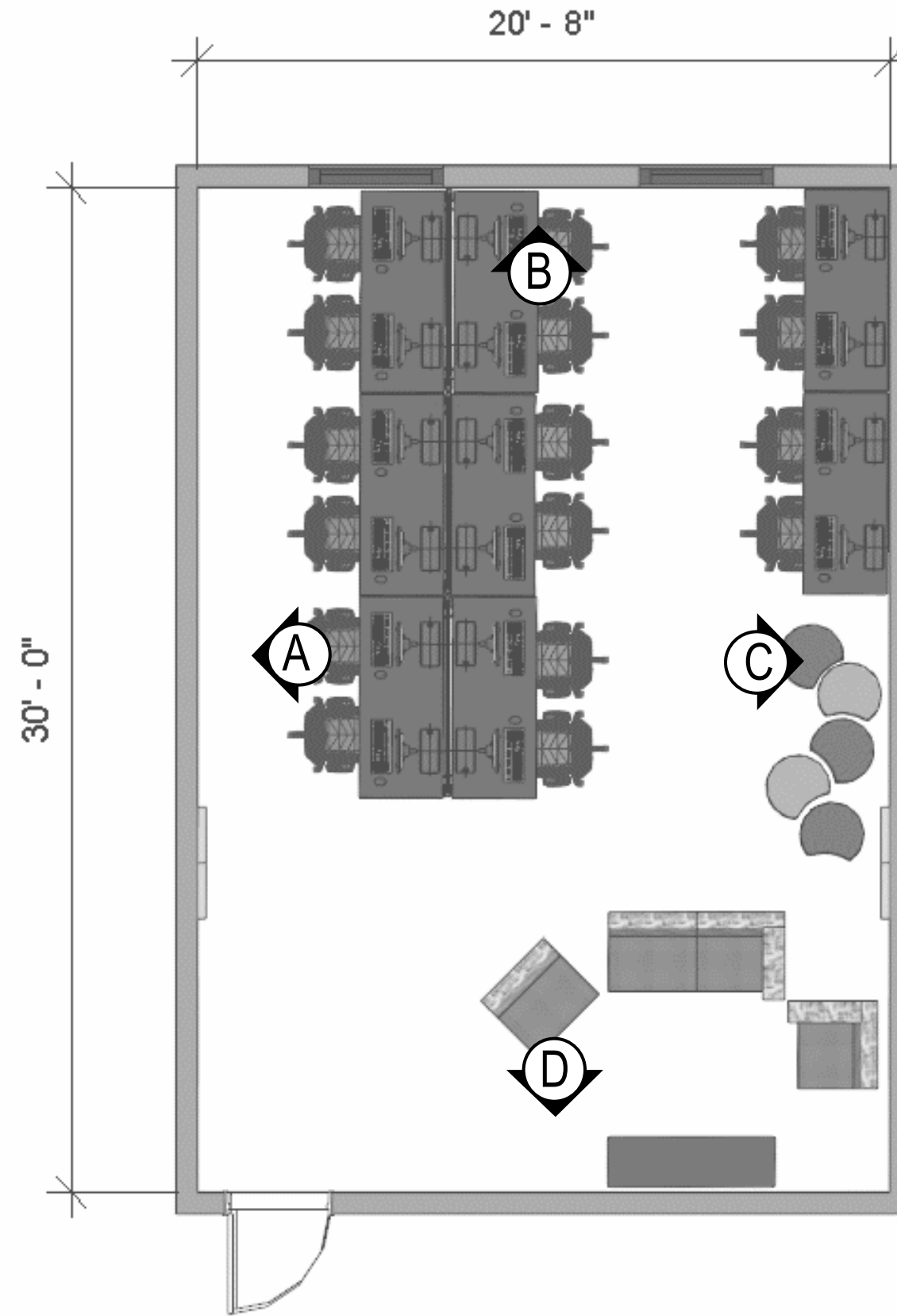





**A** INTERIOR ELEVATION A – CONCEPT #2, COLOR SCHEME #1  
Esports Environments

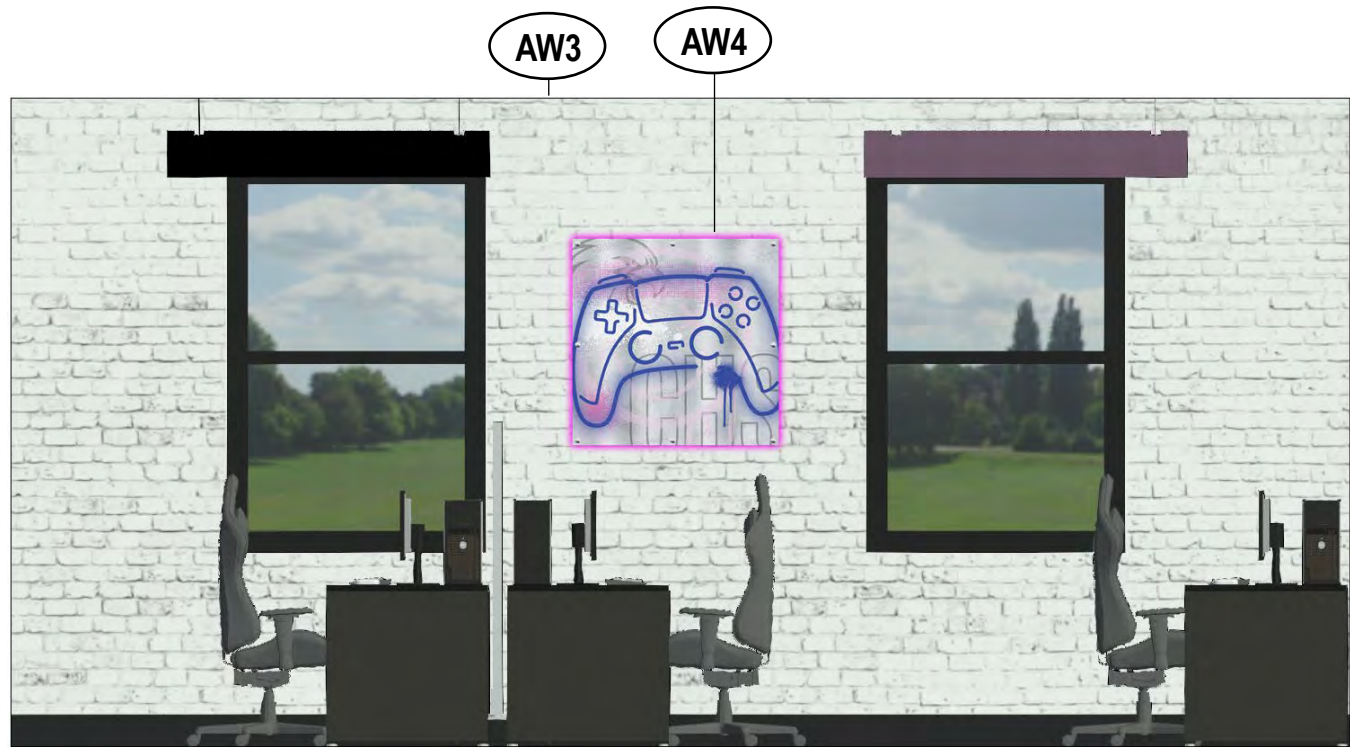

**B** INTERIOR ELEVATION B – CONCEPT #2, COLOR SCHEME #1  
Esports Environments

NOTE: School is responsible to remove unwanted wall-hung items and patch walls prior to painting.





**C** INTERIOR ELEVATION C – CONCEPT #2, COLOR SCHEME #1  
Esports Environments

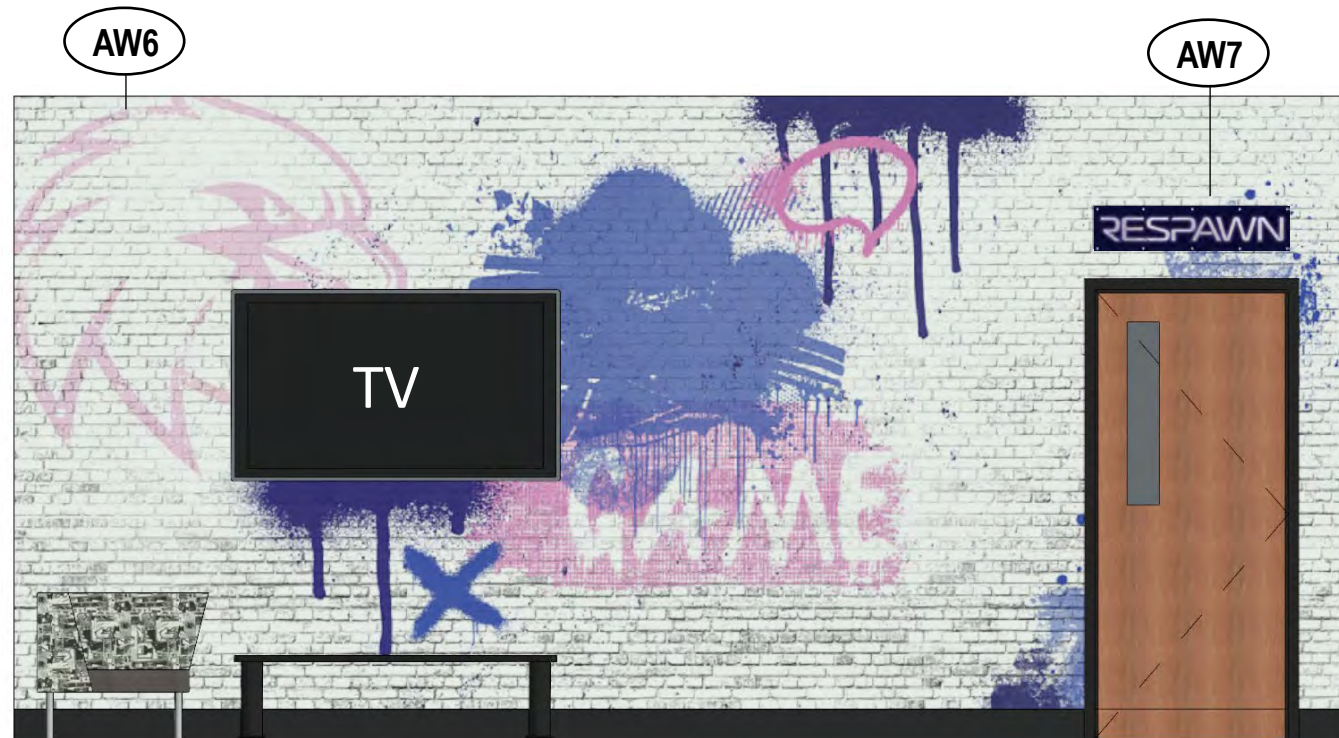

**D** INTERIOR ELEVATION D – CONCEPT #2, COLOR SCHEME #1  
Esports Environments

NOTE: School is responsible to remove unwanted wall-hung items and patch walls prior to painting.



**CONCEPT 2 - COLOR SCHEME #1**



AW4 – Silver Dibond LED



Grey used to show transparency

AW1 – Clear Acrylic



AW7 – Silver Dibond

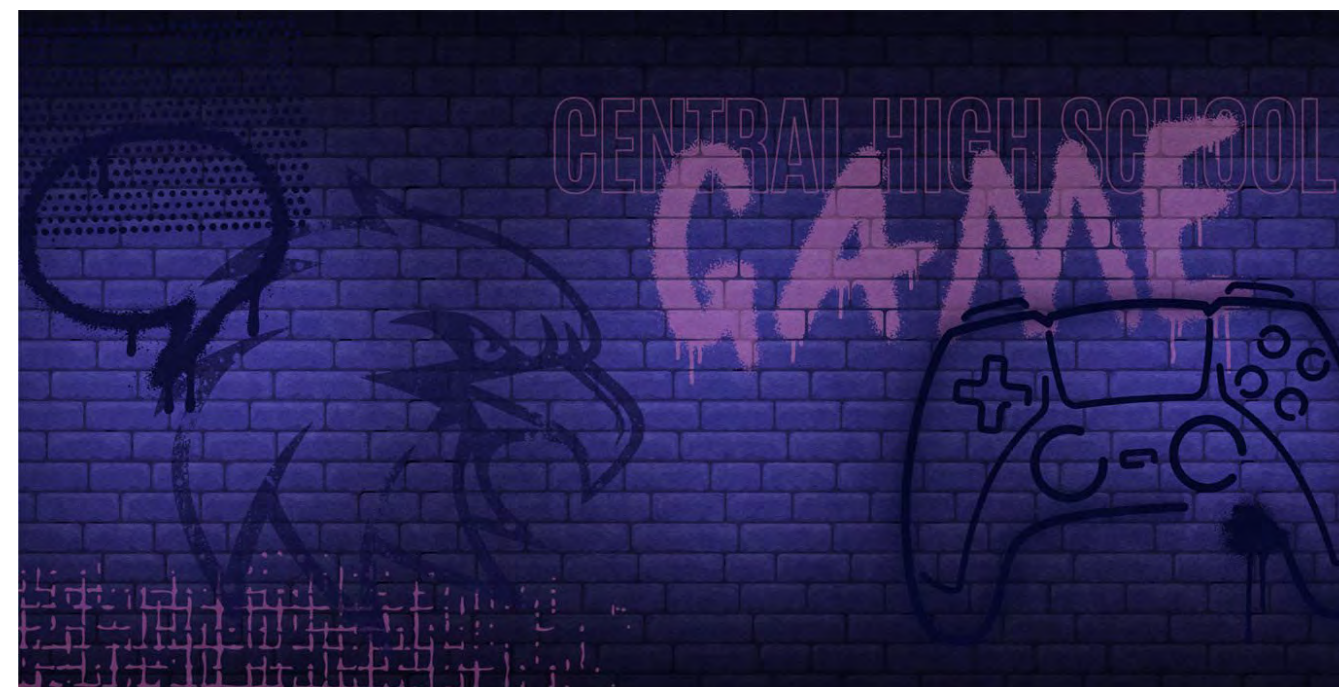

AW2 – Roughwall



AW5 – 6mm Black PVC



AW3 – Roughwall



AW6 – Roughwall



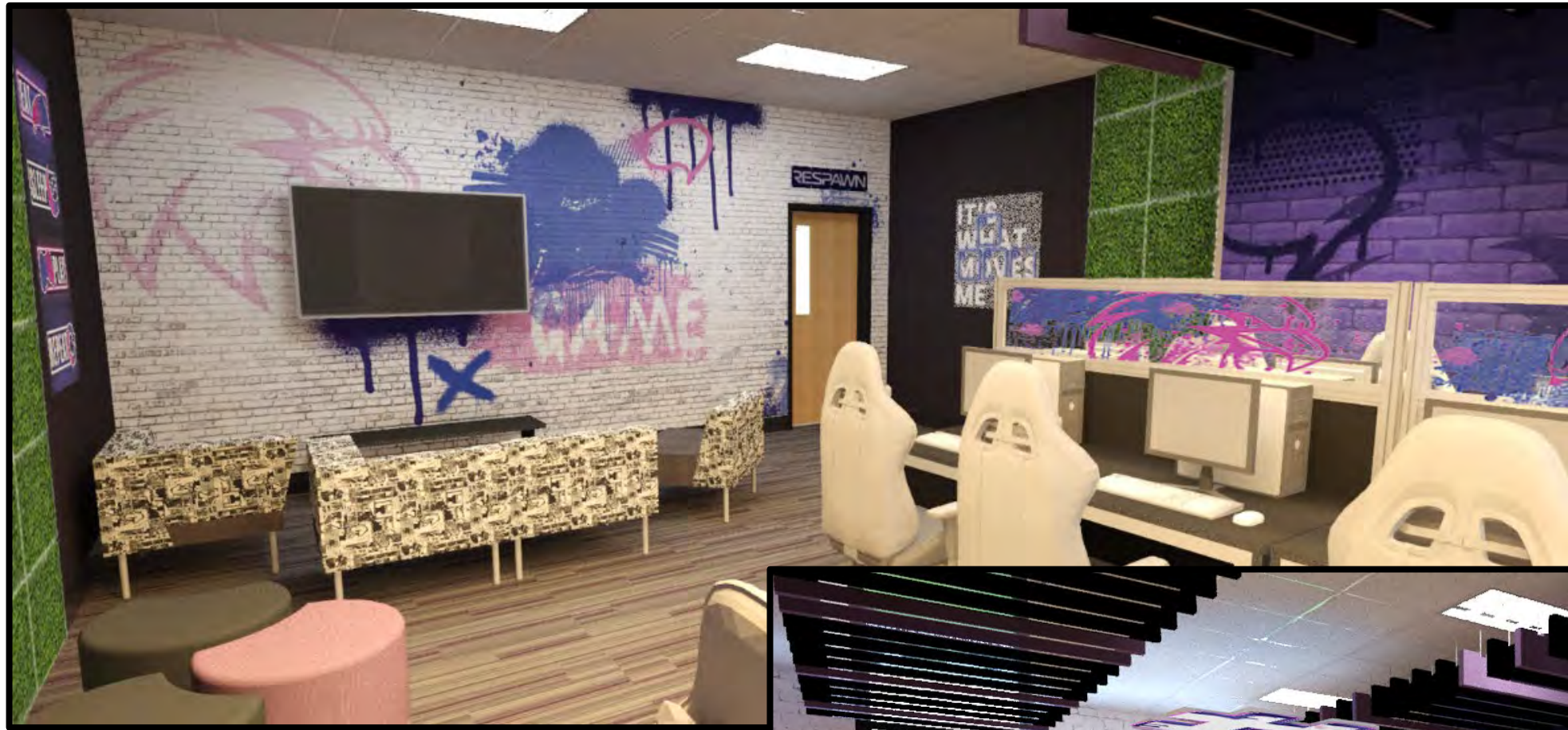



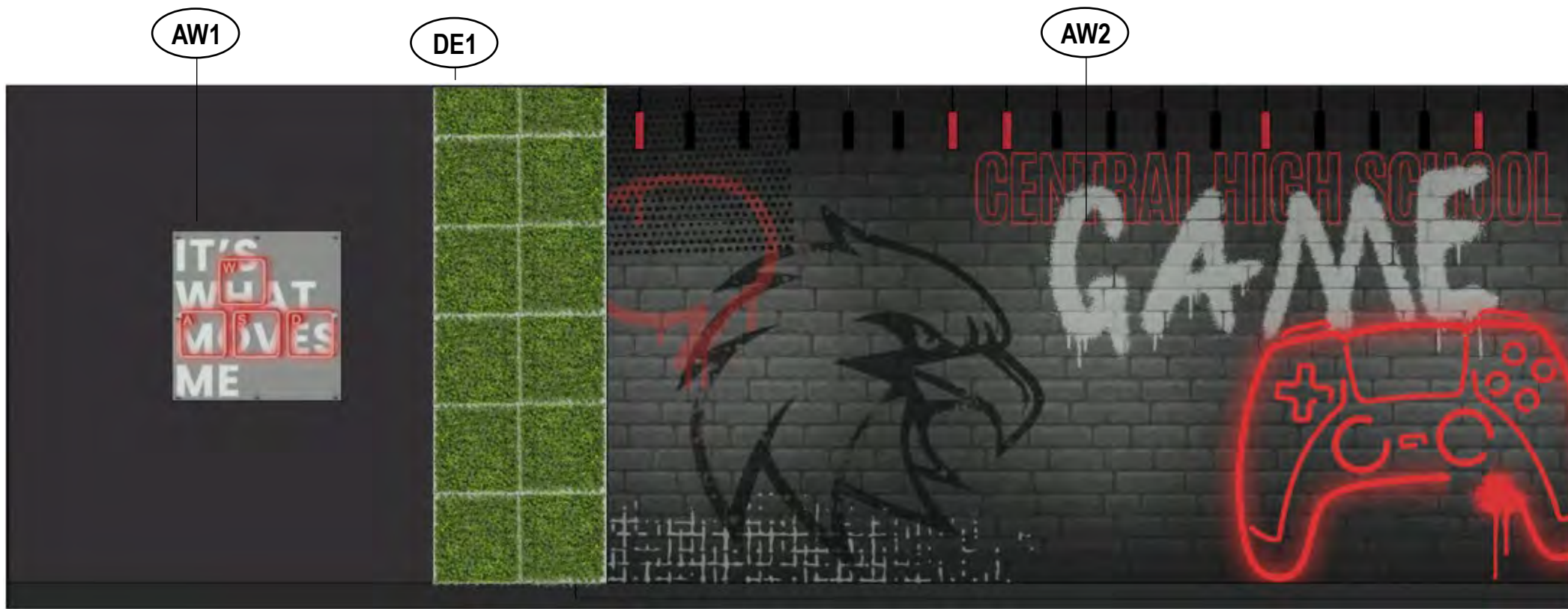

**A** INTERIOR ELEVATION A – CONCEPT #2, COLOR SCHEME #2  
Esports Environments

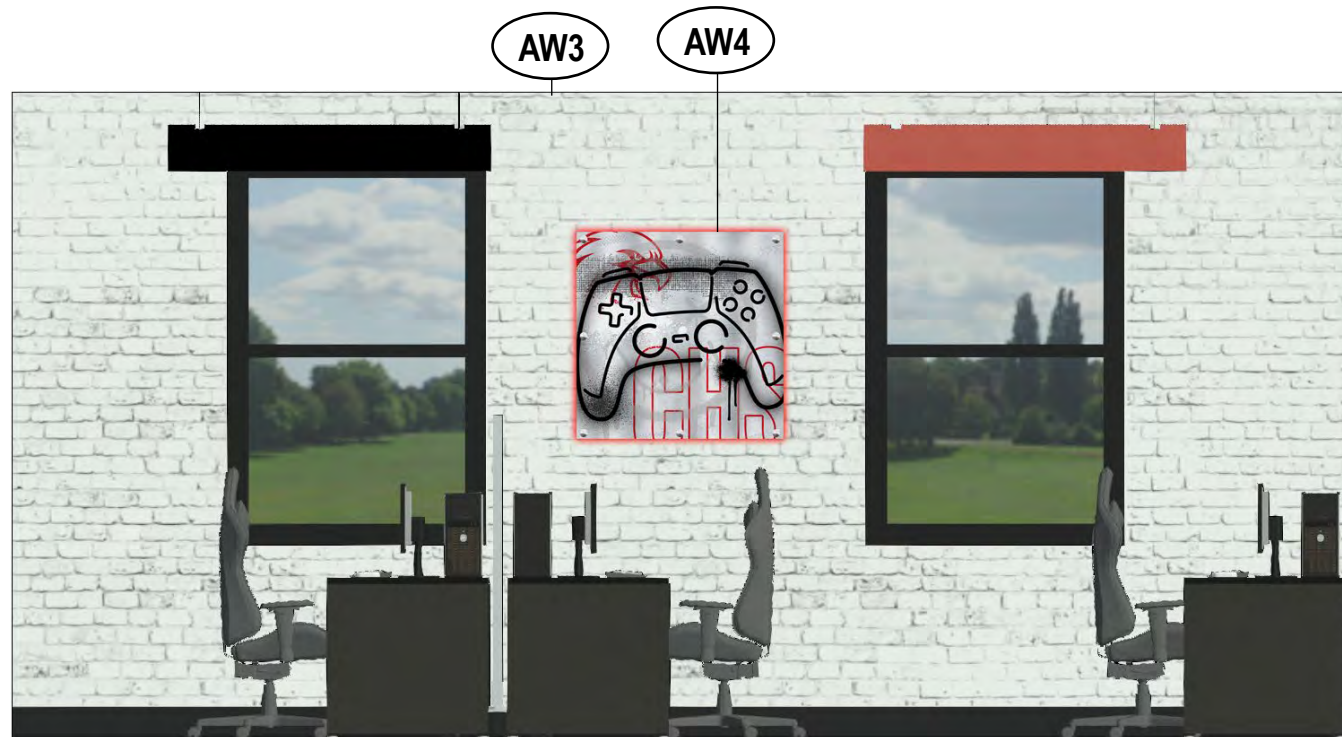

**B** INTERIOR ELEVATION B – CONCEPT #2, COLOR SCHEME #2  
Esports Environments

NOTE: School is responsible to remove unwanted wall-hung items and patch walls prior to painting.



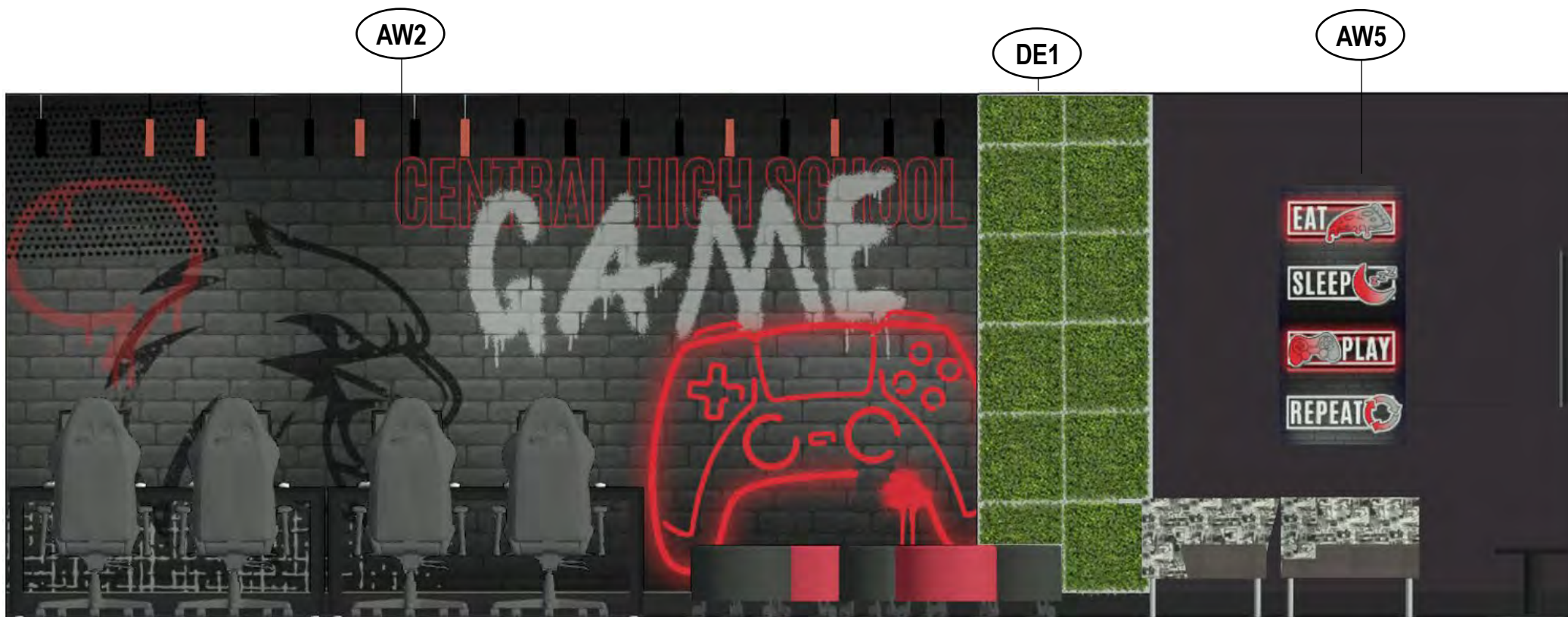

**C** INTERIOR ELEVATION C – CONCEPT #2, COLOR SCHEME #2  
Esports Environments

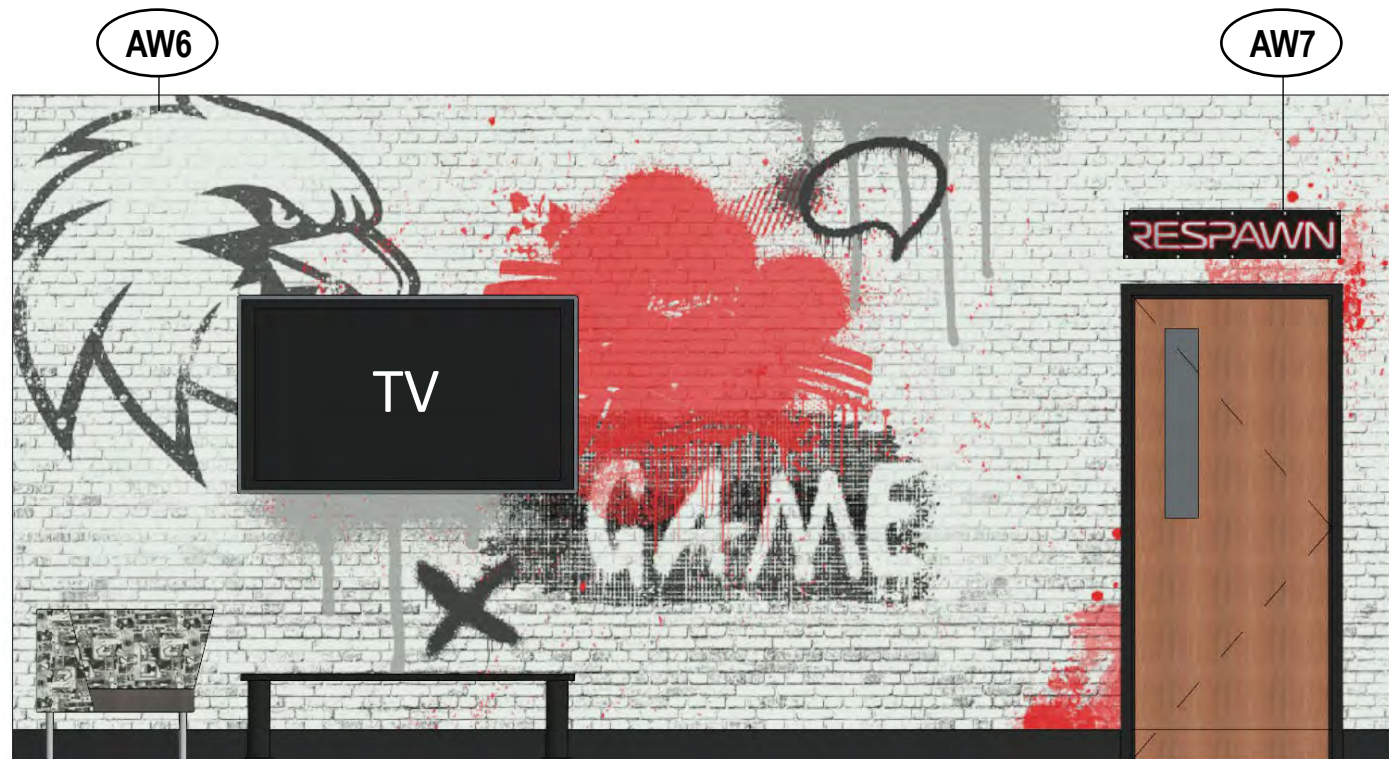

**D** INTERIOR ELEVATION D – CONCEPT #2, COLOR SCHEME #2  
Esports Environments

NOTE: School is responsible to remove unwanted wall-hung items and patch walls prior to painting.



**CONCEPT 2 - COLOR SCHEME #2**



**AW4 – Silver Dibond LED**

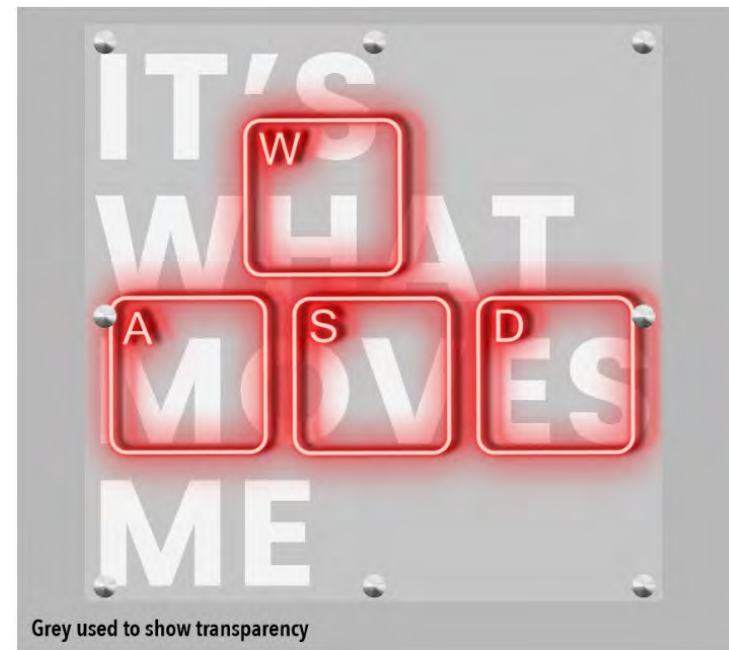

Grey used to show transparency

**AW1 – Clear Acrylic**

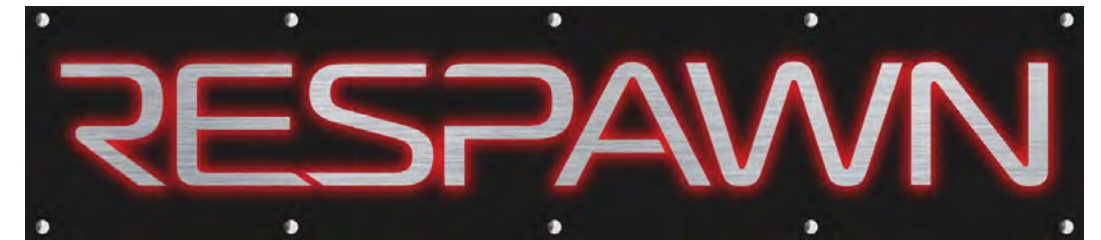

**AW7 – Silver Dibond**



**AW2 – Roughwall**



**AW5 – 6mm Black PVC**

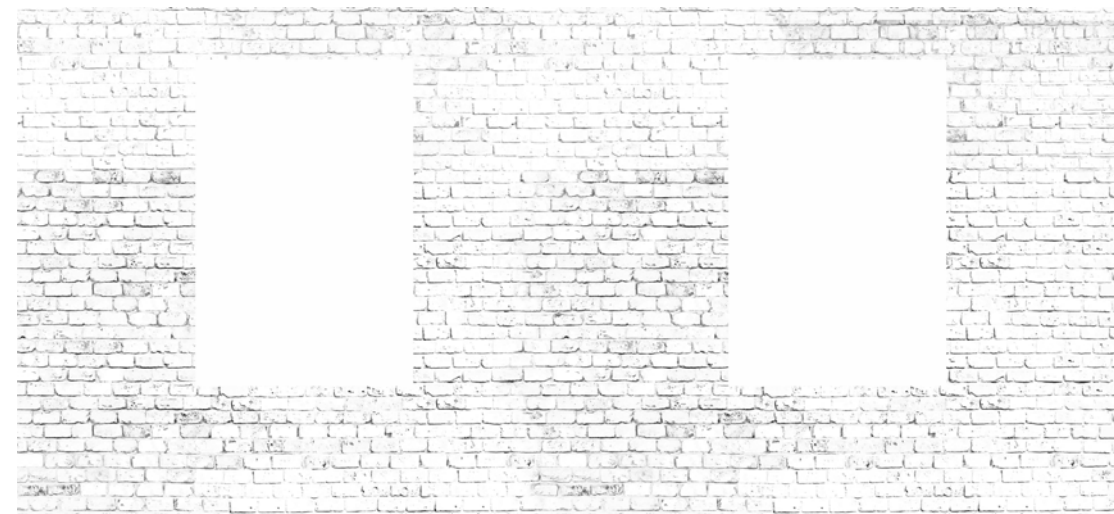

**AW3 – Roughwall**



**AW6 – Roughwall**







**OPTIONAL CEILING TREATMENTS & MOSS WALL**

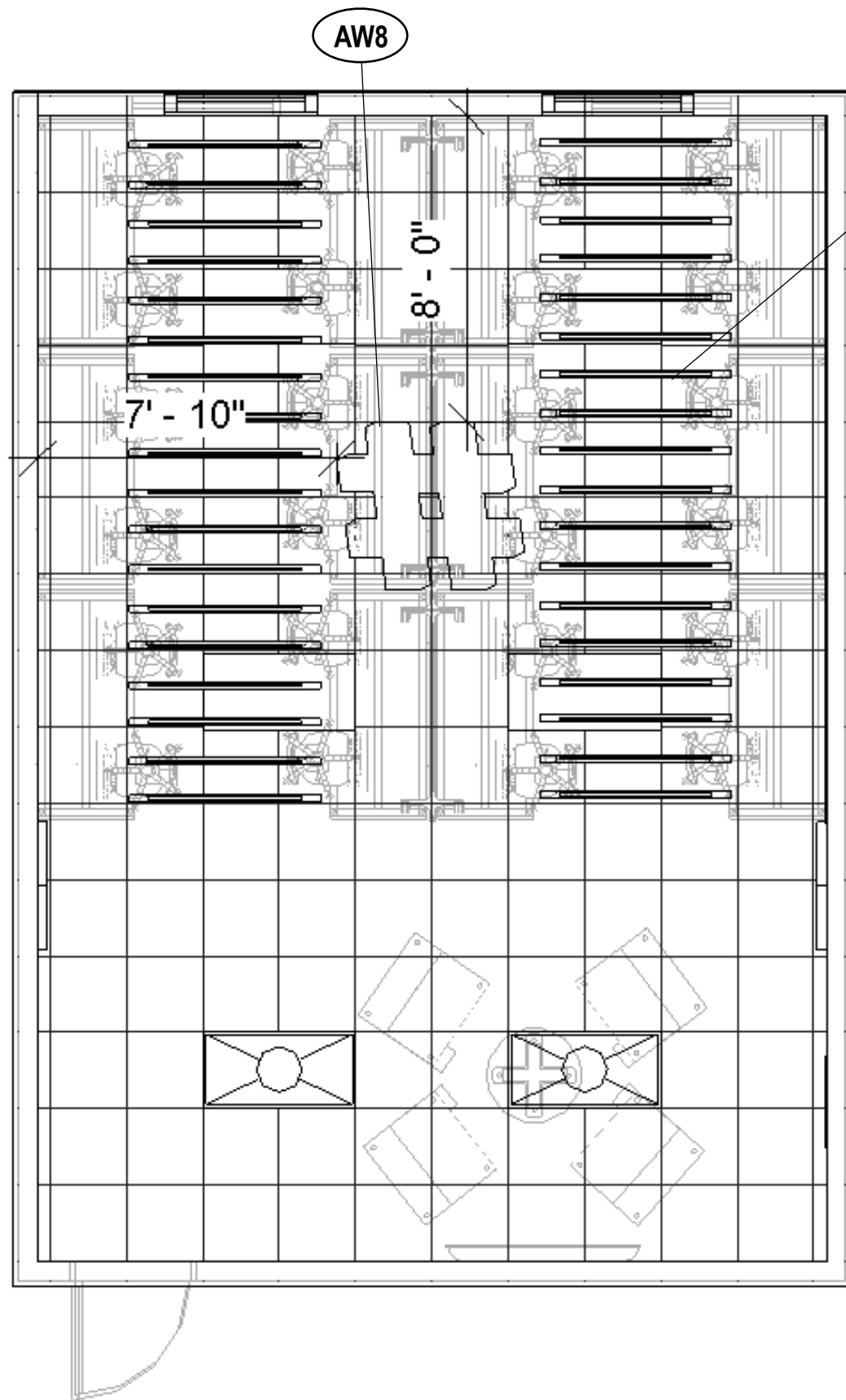

- DE3**
-  40 Magenta
  -  06 Charcoal
  -  23 Red
- DE2 –Acoustics Beam LED**  
 Finish: Charcoal (Qty. 26)  
 Finish: Magenta or Red (Qty. 10)  
 Total Qty. 36



**AW8 Ceiling LED**

Top Layer: Direct Print on 3mm White Maxmetal  
 Middle Layer: Space = 1.5" White Ultraboard Stacked  
 Bottom Layer: 1/2" Black Ultraboard printed with UV inks  
 Cut to Shape

UL RGB LED's mounted underneath bottom layer to reflect off White Maxmetal  
 Ceiling Hung w/Aircraft Cable  
 Overall Size: 59"W x 52.8"H



**20x20x2.5" Moss Wall Mat**  
 AUR-198175  
 Plastic Material  
 2.5" to 3" Varying Heights  
 Green  
 Total Qty. 24

**DE1 Wall Planters**

Wood Structure Painted Grey  
 2" Exterior Square Frame  
 Screwed into Wall Behind  
 Overall Size: 3'4"W x 9'5"H x 2"D

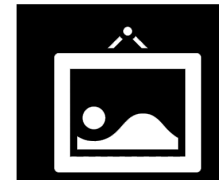



**ESPORTS/PHABLAB MINI LAB CONCEPT**

**CAPACITY SHOWN: 18**

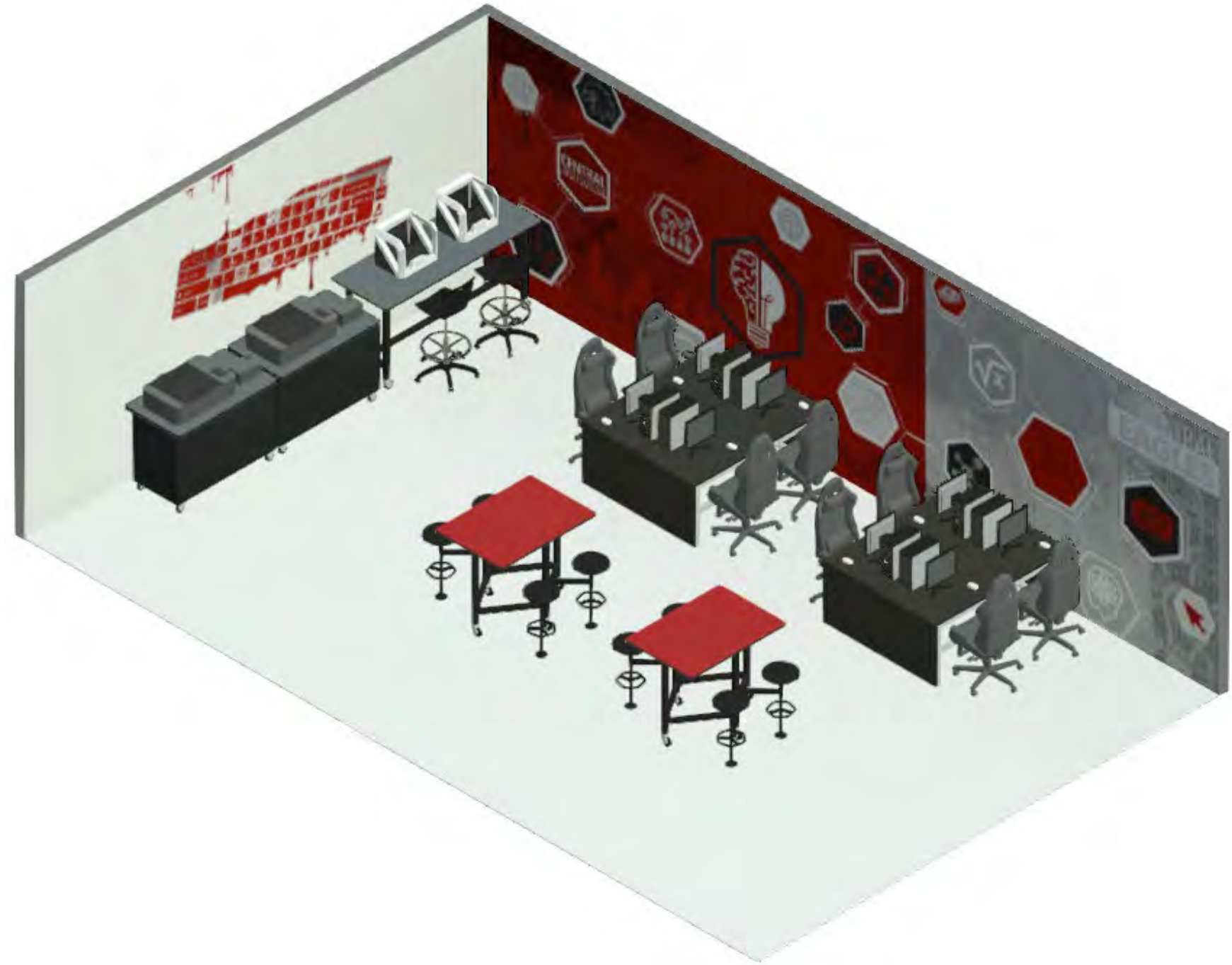
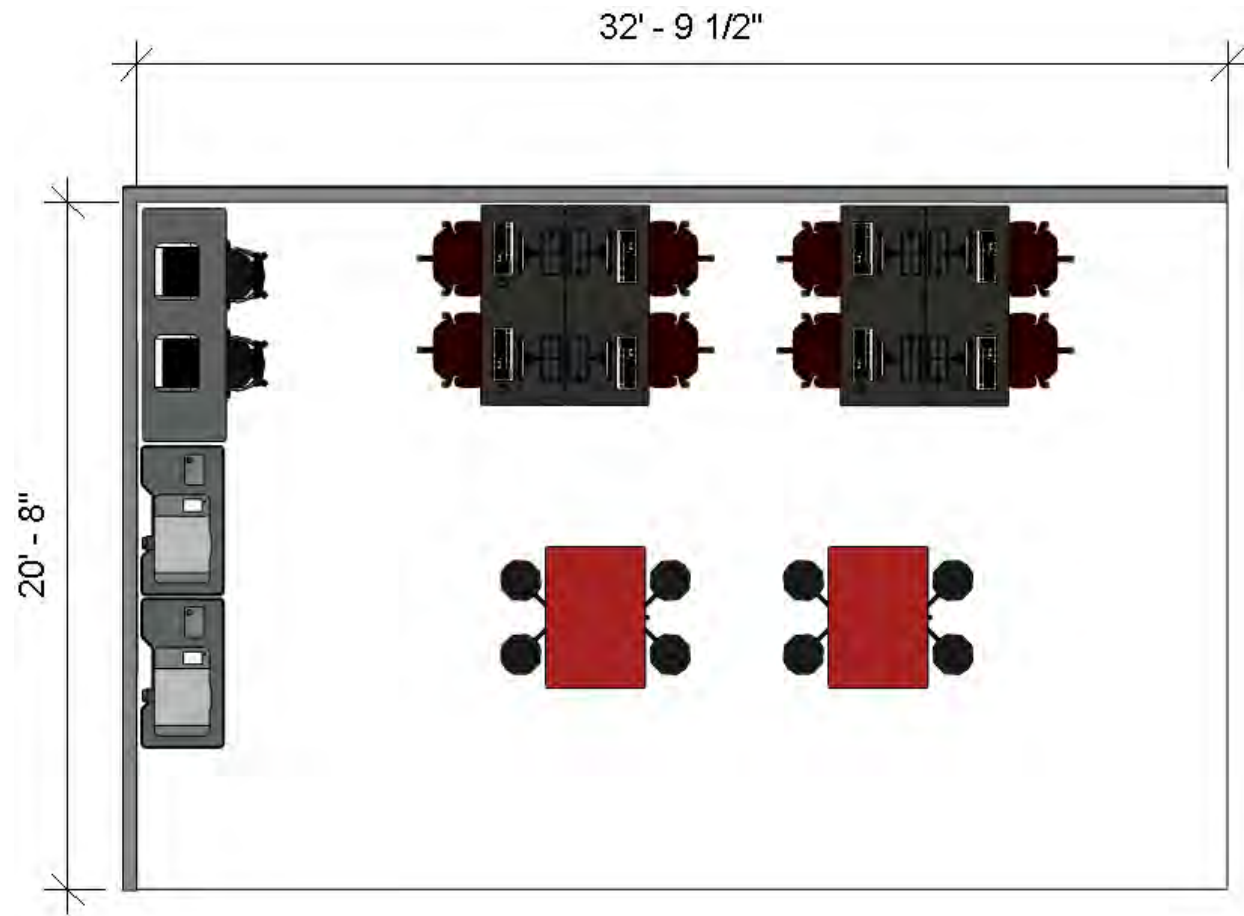

**NOTE:** Layout is not ADA compliant. School is responsible to indicate if additional ADA spots are required.





## PROJECT HISTORY

PRELIM DATE: 08.17.23

REVISION 1: 09.07.23

- expanded color options for both styles
- added school logo into art
- updated elevations & renderings
- added storage to DE1
- updated detail pages

REVISION 2: 09.19.23

- updated go panel art
- revised synergy end panels
- option #2 layout revised
- esports/phablab combo example added
- renderings updated

REVISION 3: 10.06.23

- updated chair symbol in all renderings

REVISION 4: 10.31.23

- cover page updated
- respawn alternate furniture images updated
- page organization updated
- elevations & renderings updated (chairs & LEDs)
- phablab combo gaming stations increased

REVISION 5: 11.02.23

- some verbiage & labeling updated

### FINAL BOOK APPROVAL

\*Signing below indicates all project furniture quantities, colors, laminates, paint, graphic content & all other design elements have been reviewed and will receive no additional revisions. Any revisions requested beyond final book approval will incur additional charges and extended lead times.

\*\*Client indicates an understanding that materials, colors, and artwork in this book are digital representations only and there may be variation in appearance due to screen calibration and/or color print anomalies.

Print Name: \_\_\_\_\_ Title: \_\_\_\_\_

Signature: \_\_\_\_\_ Date: \_\_\_\_\_





# TERMS & CONDITIONS

## TRASH REMOVAL

Dumpsters and trash haul away are not part of any provided installation pricing. Any waste, dunnage or packaging materials from delivery and installation will be compacted and neatly left on site. If dumpsters are required, special arrangements will be made with costs included on quote.

## NEW or REMODEL PROJECTS

Palmer Hamilton is NOT responsible for site verifications unless they have entered into a design agreement contract with the customer. Dealer/end-user takes full responsibility of ensuring furniture and décor will fit. Please *verify* room dimensions prior to ordering. If drawing was scaled, traced or copied, please field verify all room dimensions for accuracy. If field dimensions can not be obtained, late shipments may occur.

Do not scale off these plans. If scaled plans are needed, please contact the project manager.

Palmer Hamilton is not responsible for changes, or deletions not reviewed and approved in advanced by Palmer Hamilton.

If half-walls or furnishings are to be clipped-down to floor, the Dealer/End-user is responsible to inform Palmer Hamilton of the locations. Palmer Hamilton is not responsible or liable for any electrical or plumbing that may be in the floors.

Please advise Palmer Hamilton if there is Asbestos in or around the location of the installation.

## ADA COMPLIANT SEATING

A minimum of 5% but not less than one table shall be placed for wheelchair compliance. Palmer Hamilton is not responsible if the client has requested to provide less than this number in their facility. It is the responsibility of the end user to meet the compliancy standards.

It is also the responsibility of the end user to know their fire code capacity limits.

## ELECTRICAL

Palmer Hamilton will suggest and supply the light fixtures if requested by the customer.

Palmer Hamilton installers do not install light fixtures as our installers are not electrical contractors and do not hold local licenses. School is responsible for all wiring and hooking up of the light fixtures. Palmer Hamilton will supply a lighting fixture plan of requested locations for the Schools electrician to use for placement of lighting fixtures

## WINDOWS

School is responsible for any/all repair of window glass, trim and window caulking if necessary, prior to the installation.

School is responsible for cleaning of windows for window cling installation. If windows are not cleaned prior to installation, Palmer Hamilton will assess an additional charge for cleaning.

School is responsible for removing any window treatments that are not staying in new design.

## WALLS

School is responsible for cleaning walls of any and all hooks, bulletin boards not remaining in design, loose wiring, removable clocks, conduit if not necessary.

Repair/Patching of any broken drywall and cracks in CMU, prior to installation.

Any newly constructed walls must be primed and painted prior to installation.

Any painting that is not supplied by Palmer Hamilton needs to be completed fourteen (14) days prior to our installation to properly cure.

## CEILING

Palmer Hamilton does not sell or install standard ceiling tiles. Palmer Hamilton will remove or replace tiles if it is part of a décor item only. Our installers will only install any décor that might be attached to the ceiling and not to the tile grid for safety reasons as required.

## FLOORING

Palmer Hamilton may specify a suggested flooring, but takes no liability in regard to floor performance, installation, and/or upkeep.

Any new flooring must be completed fourteen (14) days prior to installation to allow ample curing time of adhesives, and cleaning of flooring must also be completed prior to Palmer Hamilton installers being onsite for installation.

If Nonstandard glides are needed, it is the responsibility of the end-user to inform Palmer Hamilton of the type needed and cost will be added to the quote.

Vinyl Base trim must be completed prior to Palmer Hamilton furniture installation, unless the decision was made during the design phase by the client to have Palmer Hamilton installers install the base trim.

## EXISTING EQUIPMENT AND FURNITURE

Please remove all equipment and furniture that is not to be in the new design plan prior to Palmer Hamilton's arrival.

I agree to terms & conditions

Signature \_\_\_\_\_ Date: \_\_\_\_\_

