

OF-OG6 SPECIFICATIONS
6' OGLETHORPE BENCH

photo

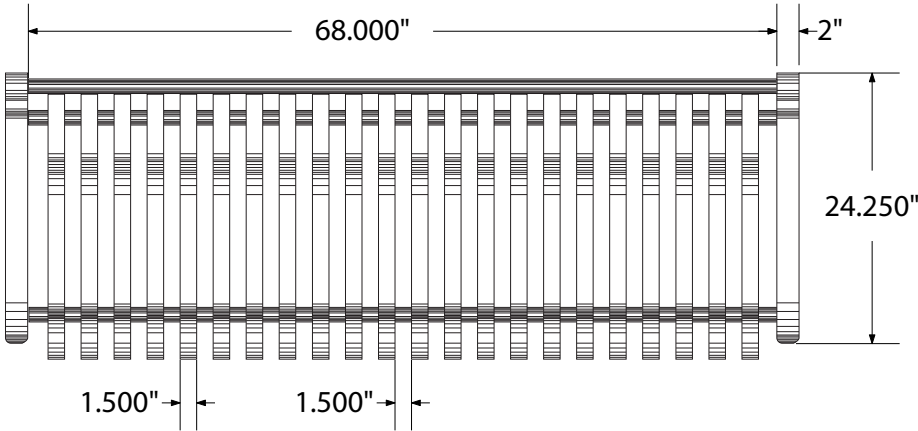

top view



front view

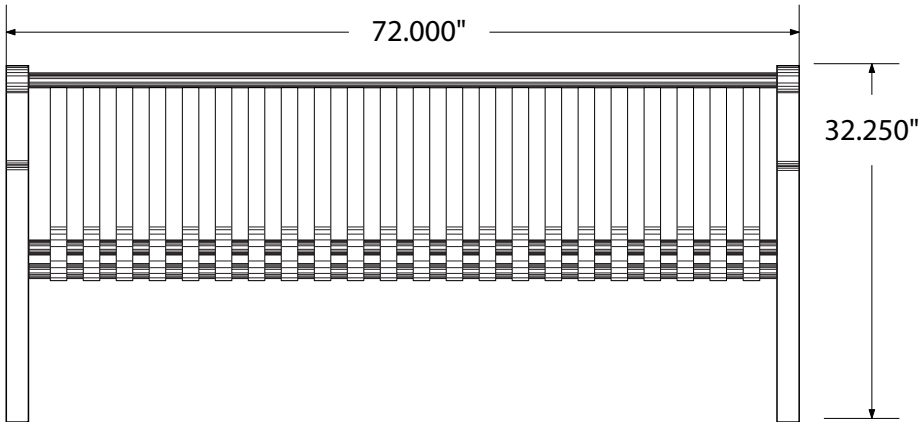

side view

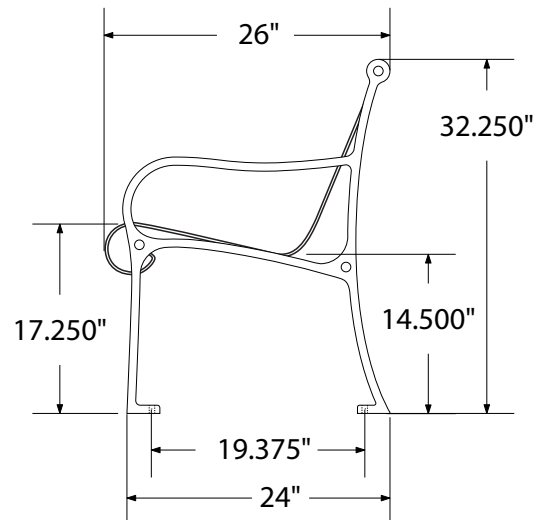

product finish

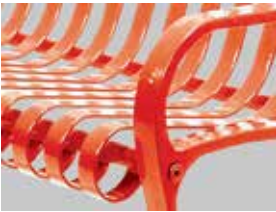

Coated Surfaces

- Thermoplastic coated Copolymer-based, environmentally safe
- Does not fade, crack, peel, or warp
- Applied at a thickness 25-30 mils
- 5 year warranty on coating

Weight

- 260 lbs.

mounting styles

P = Portable : no mount

SM = Surface Mount:
concrete anchors
through discs welded
to legs

IG = In-Ground:
J-rods set in concrete
through discs welded
to legs

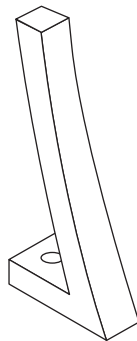

PORTABLE

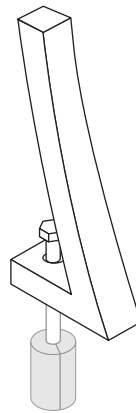

SURFACE MOUNT

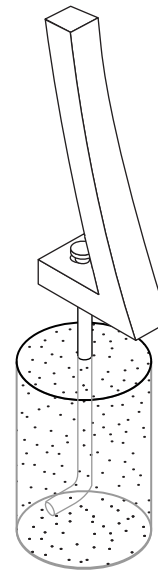

IN-GROUND

All design specifics subject to change. For all products Palmer Hamilton reserves the right to make adjustments due to changing market conditions, product discontinuation, legislative requirements or other circumstances.

Visit our website to see the complete family of Palmer Hamilton products
800-788-1028 | www.palmerhamilton.com