

**SPEC SHEET OF-RB32-SML**  
**32 GAL. RING BANDED RECEPTACLE WITH LID AND LINER**

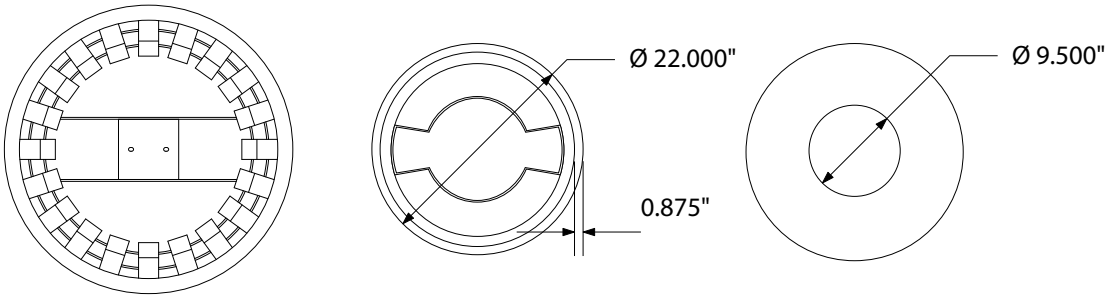

**top view**



receptacle

liner

lid

**front view**

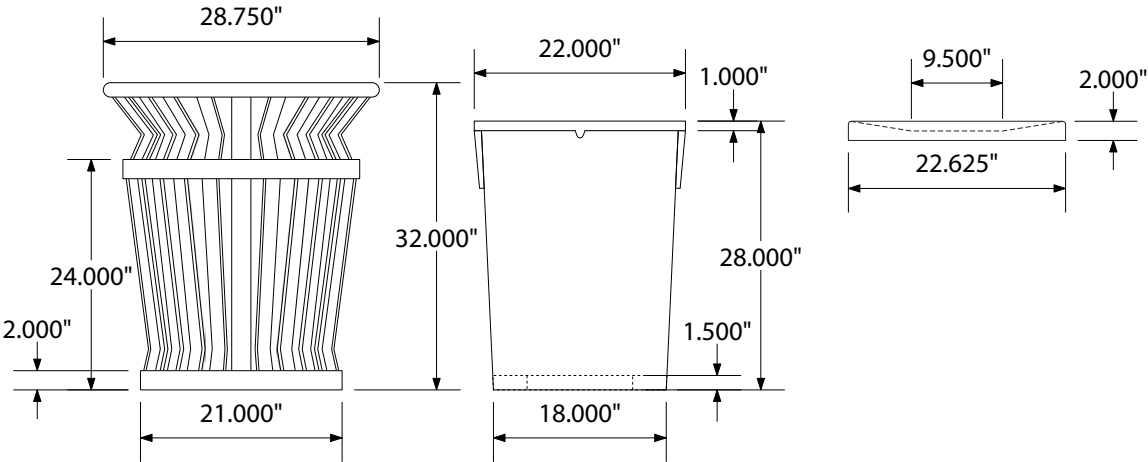

receptacle

liner

lid

## product finish



### Coated Surfaces

- Thermoplastic coated
- Copolymer-based, environmentally safe
- Does not fade, crack, peel, or warp
- Applied at a thickness 25-30 mils
- 5 year warranty on coating



### Construction

- Receptacle - 11 gauge steel with thermoplastic coating
- 1.5" dia. tubular steel lip
- Liner - black polyethylene-plastic
- Lid - 11 gauge steel with thermoplastic coating

### Weight

- 165 lbs.

## mounting styles

P = Portable: no mount

SM = Surface Mount: concrete anchors through tabs welded to rims [1], or at 6" center plate to B100 above ground mount [2]

IG= In-Ground: bolts attach at 6" center plate to B200 receptacle mount embedded in concrete

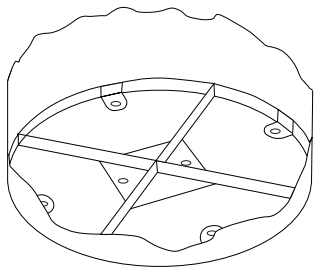

Portable

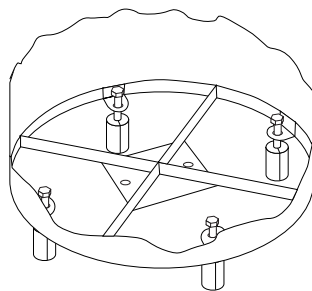

Surface Mount [1]  
[anchors]

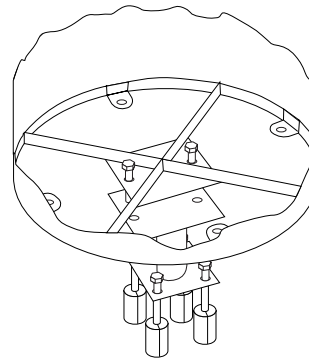

Surface Mount [2]  
[B-100 6" mount]

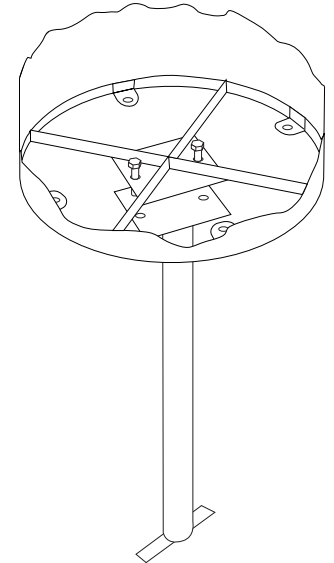

In-Ground  
[B-200 mount]

All design specifics subject to change. For all products Palmer Hamilton reserves the right to make adjustments due to changing market conditions, product discontinuation, legislative requirements or other circumstances.

Visit our website to see the complete family of Palmer Hamilton products  
800-788-1028 | [www.palmerhamilton.com](http://www.palmerhamilton.com)

70905

OF-RB32-SML Spec 0424

