

## BELMONT

Modular units in a wide range of shapes. Ottoman and occasional table styles allow for unique configurations.



### FEATURES

- Mobile seating and occasional table options are easily moved and reconfigured into interesting collaborative spaces.
- Coordinate ottoman shapes with our tables for more seating options.
- Choose from Palmer Hamilton's wide array of upholstery fabrics and laminates for table tops with PVC edging.
- Materials selected for longevity and comfort.

### OTTOMANS

- The lounge frames are constructed using CNC precision cut 7/8" furniture grade plywood components and are stapled together for strength and durability.
- All units are solid plywood top and bottom, with 2" commercial quality polyurethane foam on the seat top for comfort, and 1/2" thick foam wrap on the all sides.

### OCCASIONAL TABLES

- The lounge frames are constructed using CNC precision cut 7/8" furniture grade

plywood components and are stapled together for strength and durability.

- Tables have 1/2" thick foam wrap on the all sides to coordinate with other pieces.
- The laminated tops are constructed of 1-1/8" thick particle board core with a .050" thick high pressure laminate top surface, a .020" thick phenolic backing sheet, and a 3mm PVC edge band.

### MATERIALS

#### Fabrics

- Fabrics of Grade 2 or higher are recommended. Selections up to Grade 10 available. Options include over 50 standard fabrics and hundreds of designer fabrics to choose from. See our website for selections.
- Contrasting fabrics are available for all upholstered modules. When selecting contrasting upholstery, clearly specify which fabric should be used for the base and seat top. Use the higher grade for pricing purposes.

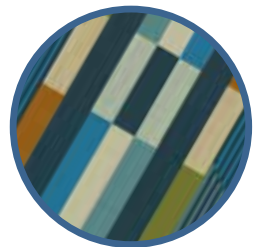

With rounded or straight corners,  
pair with occasional tables for  
comfortable group seating.



- Typically we use fabric "Up the Roll" with any stripes/pattern going from front to back. Please contact us with any special requests or instructions.

**COM Fabric Policy**

- We accept Customer Own Material (COM) with some restrictions.
- A sample swatch should be sent to  
Upholstery Department  
**PALMER HAMILTON**  
143 S. Jackson Street  
Elkhorn, WI 53121-1911  
We'll contact you with our approval or questions.
- All yardage requirements for COM are based upon 54" plain non-direction material. Additional yardage may be required based on repeat and matching.
- See the price list for required yardage for each module. Additional yardage will be required for patterned fabrics, per this list:

REPEAT	Additional yardage
Based on 54" wide roll	
Plain fabric	0%
1-5" repeat	10%
6-10" repeat	15%
11-15" repeat	20%
16-20" repeat	25%
21-30" repeat	30%

31-40" repeat	40%
41"+ repeat	50%

Call us for assistance with any questions.

- Palmer Hamilton takes no responsibility for tailoring, wear-ability or application of COM fabrics and textiles. Any warranty claims will fall to the original vendor of the material.

**Laminates**

- Following is a general guide for our laminate options and pricing. Group 1 laminates are included in our base price.

- **Group 1:** Choose your colors from Wilsonart® or Formica® laminates. See their websites for selections. For Wilsonart®, our standards are most colors in Type 335 laminate and finish type ending in -38 or -60. Exceptions apply, including colors that begin with "Y" or end with K-38 or K-60. Standard Formica® Laminates are Grade 12 or Grade 20 ending in finish type -58 and -43.



- **Group 2:** Standard Pionite®, Nevamar®, and non-standard Wilsonart® laminates Type 335 and 107 Recycled Content, and finish types not ending in -38 or -60.

Movable pieces for casual settings that need flexibility.



- **Group 3:** Wilsonart® Specialty Types 136 / 137 Chalkboard Laminates, Arborite®, and premium Formica®, Pionite®, and Nevamar®.
- **Group 4:** Non-Standard Premium Wilsonart® Laminate Types 362 (VDL, Y-Type), 156/336 (Markerboard), 376-HD / 366 Wilsonart® HD, and 515 Compact Laminate.
- **All premium laminates** are subject to an upcharge.

- Glides are the standard option, and casters are available at an upcharge.
- Casters are not available on pie or triangle shaped ottoman.

**WARRANTY**

See our website.

**SHIPPING**

Ship fully assembled.

**Glides and Casters**

- Ottomans and occasional tables are available with glides or casters.



Glides



Casters

Ottomans of many shapes, with or without casters, add interest in seating arrangements.



**Ottomans**

**Curved Ottoman**

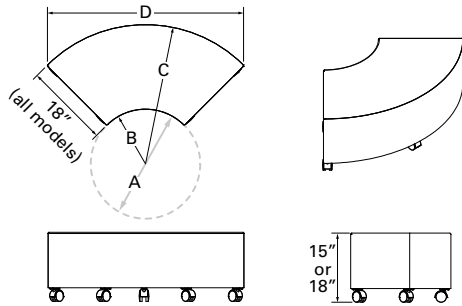

All models:  
 Depth: 18"  
 Height: 15" or 18" with glides or casters  
 One color fabric, or contrasting top available.

A	24	30	36	42	48
INSIDE DIA	24	30	36	42	48
B	12	15	18	21	24
INSIDE RADIUS	12	15	18	21	24
C	30	37-3/4	45-1/2	52-3/4	60-1/2
OUTER RADIUS	30	37-3/4	45-1/2	52-3/4	60-1/2
D	43	47	51-1/2	55-1/2	60
FULL WIDTH	43	47	51-1/2	55-1/2	60



**Hexagon Ottoman**



Sides: 18" (36" total width)  
 Height: 15" or 18" with glides or casters  
 One color fabric, or contrasting top available.

**Pie Shaped Ottoman**

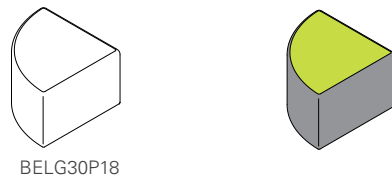

18", 24", 30", 36", 42" Sides  
 Height: 15" or 18" with glides (no casters available)  
 One color fabric, or contrasting top available.

Ottomans of many shapes, with or without casters, add interest in seating arrangements.



**Ottomans**

**Rectangular Ottoman**

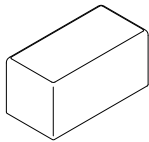

BELG1836R18

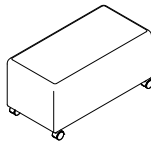

BELG1836R18CA

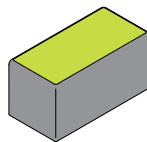

Long Side: 24", 36", 48", 60", 72"  
 Depth: 18" on all sizes  
 Height: 15" or 18" with glides or casters  
 One color fabric, or contrasting top available.

**Round Ottoman**

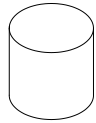

BELG18D18

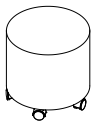

BELG18D18CA



Diameter: 18", 24", 30", 36", 42"  
 Height: 15" or 18" with glides or casters  
 One color fabric, or contrasting top available.

**Square Ottoman**

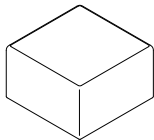

BELG24S18

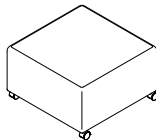

BELG24S18CA

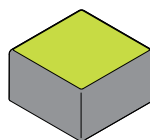

Sides: 18", 24", 30", 36", 42"  
 Height: 15" or 18" with glides or casters  
 One color fabric, or contrasting top available.

**Trapezoid Ottoman**

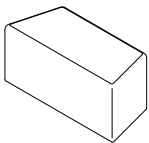

BELG1824T18

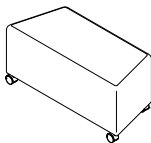

BELG1824T18CA

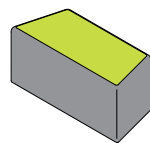

Long Side: 24", 36", 48", 60", 72"  
 Depth: 18" on all sizes  
 Height: 15" or 18" with glides or casters  
 One color fabric, or contrasting top available.

**Triangle Ottoman**

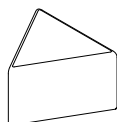

BELG24N18

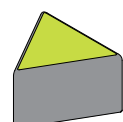

Sides: 18", 24", 30", 36", 42"  
 Height: 15" or 18" with glides (no casters available)  
 One color fabric, or contrasting top available.

Occasional tables to add convenience for seating arrangements.



## Occasional Tables

### Rectangle Occasional Tables

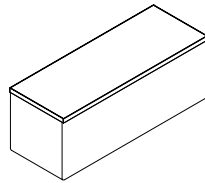

BEOT1848R18

18" Depth for all  
Length: 24", 36", 48", 60", 72"  
Height: 15", 18", 21" with or without casters  
Standard with Group 1 laminate; upgrades available.

### Round Occasional Tables

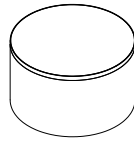

BEOT30D18

Diameter: 18", 24", 30, 36", 42"  
Height: 15", 18", 21" with or without casters  
Standard with Group 1 laminate; upgrades available.

### Square Occasional Tables

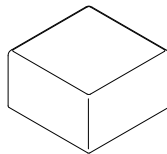

BEOT30S18

Sides: 18", 24", 30, 36", 42"  
Height: 15", 18", 21" with or without casters  
Standard with Group 1 laminate; upgrades available.